

Ayrshire Park, Lisburn, County Down, BT28

Asking Price: £225,000
Freehold

 **Reeds Rains**

reedsrains.co.uk

Ayrshire Park, Lisburn, County Down, BT28

Asking Price: £225,000 Freehold

Council Tax Band:

EPC Rating: B

Beautifully presented semi-detached house boasting 3 bedrooms, a spacious garden, and a modern kitchen. Located in a sought-after neighbourhood, this property offers comfortable living spaces and is perfect for families or professionals. Book a viewing today to secure your dream home.

Entrance Hall

Living Room/ Dining Room/ Kitchen

28'8" x 12'11" (8.74m x 3.94m)

Exceptional range of high and low level units, laminate work tops, built-in oven and gas hob unit, single drainer stainless steel sink unit, fridge/ freezer, open to casual dining and living room with feature stove, laminate flooring.

WC

Low level WC, wash hand basin.

Utility Room

7'6" x 5'11" (2.29m x 1.8m)

Range of high and low level units.

Landing

Bedroom 1

16'4" x 9'1" (4.98m x 2.77m)

Bedroom 2

9'1" x 8'4" (2.77m x 2.54m)

Bedroom 3

9'1" x 7'9" (2.77m x 2.36m)

Bathroom

White suite comprising panelled bath, wash hand basin, low level WC, separate shower cubicle with controlled shower

Outside

Rear gardens in neat lawns, paved patio.

Summer House

Driveway

The Reeds Rains branches at 350 Upper Newtownards Road, Ballyhackamore, Belfast, N Ireland BT4 3EX, 18 Main Street, Bangor, Co Down, N Ireland BT20 5AG, Somerset House, 240-242 Ormeau Road, Belfast, Co Antrim, N Ireland BT7 2FZ, 10 High Street, Carrickfergus, Co Antrim, N Ireland BT38 7AF, 8/8A Carrmonee Road, Glengormley, County Antrim, N Ireland BT36 6HN, 14/16 Market Street, Lisburn, County Antrim, N Ireland BT28 1AB and 2 Frances Street, Newtownards, County Down, N Ireland BT23 4JA are operated by Favscio NI Limited which is independently owned and operated under a Licence from Reeds Rains Limited.

All Measurements
All Measurements are Approximate.

Laser Tape Clause
All measurements have been taken using a laser tape measure and therefore, may be subject to a small margin of error.

Floorplan Clause
Measurements are approximate. Not to Scale. For illustrative purposes only.

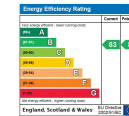

For full EPC please contact the branch.

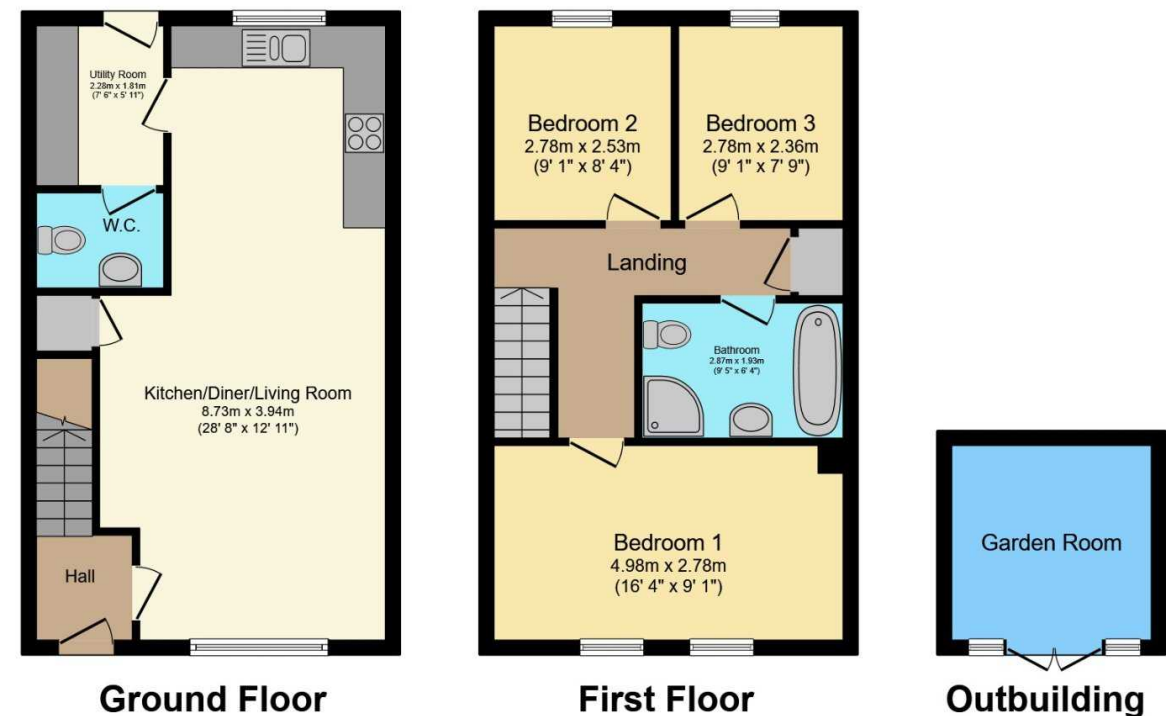

Total floor area 95.2 m² (1,024 sq.ft.) approx

This floor plan is for illustrative purposes only. It is not drawn to scale. Any measurements, floor areas (including any total floor area), openings and orientation are approximate. No details are guaranteed, they cannot be relied upon for any purpose and they do not form part of any agreement. No liability is taken for any error, omission or misstatement. A party must rely upon its own inspection(s).
Powered by www.focalagent.com

We may refer you to recommended providers of ancillary services such as Conveyancing, Mortgages, Insurance and Surveying. We may receive a referral fee for recommending their services. You are not under any obligation to use the services of the recommended provider, which may also be an associated company of Reeds Rains.

Other important information which you will need to know about this property can be found at reedsrains.co.uk