



49 Rossmore Green

Greenisland, Carrickfergus, BT38 8TG

Offers Around £139,950



49 Rossmore Green

Greenisland, Carrickfergus, BT38 8TG

Offers Around £139,950



ACCOMMODATION

ENTRANCE HALL

PVC double glazed front door. Wood laminate floor covering. Alarm panel. Access to walk-in store and roof space via slingsby style ladder.

LOUNGE

14'6 x 11'8 (4.42m x 3.56m)

Twin windows to front elevation. Wood laminate floor covering.

KITCHEN WITH INFORMAL DINING AREA

12'7 x 11'8 (3.84m x 3.56m)

Modern fitted shaker style kitchen with high and low level storage units and contrasting worksurfaces. Cooker with stainless steel extractor fan over. Space for washing machine and American style fridge freezer. Stainless steel 1.5 bowl sink unit. Part tiled walls and tiled floor.

REAR HALL

Access to store with gas fired central heating boiler and space for tumble dryer. PVC double glazed rear door. Tiled floor.

BEDROOM 1

13'2 x 12'8 (4.01m x 3.86m)

widest points.

BEDROOM 2

14'6 x 9'10 (4.42m x 3.00m)

Twin windows to front elevation.

BEDROOM 3

9'11 x 9'6 (3.02m x 2.90m)

DELUXE FAMILY BATHROOM

Deluxe modern fitted four piece suite comprising bath, shower cubicle, with mains shower and drench shower head over, floating vanity unit and WC. Chrome towel radiator. Fully tiled walls and tiled floor.

EXTERNAL

Front garden in lawn.

Private gated driveway in brick pavior.

Rear garden in lawn with paved patio area.

PVC fascia, soffits and rainwater goods.

Outside tap and lighting.



Road Map



Hybrid Map



Terrain Map



Floor Plan

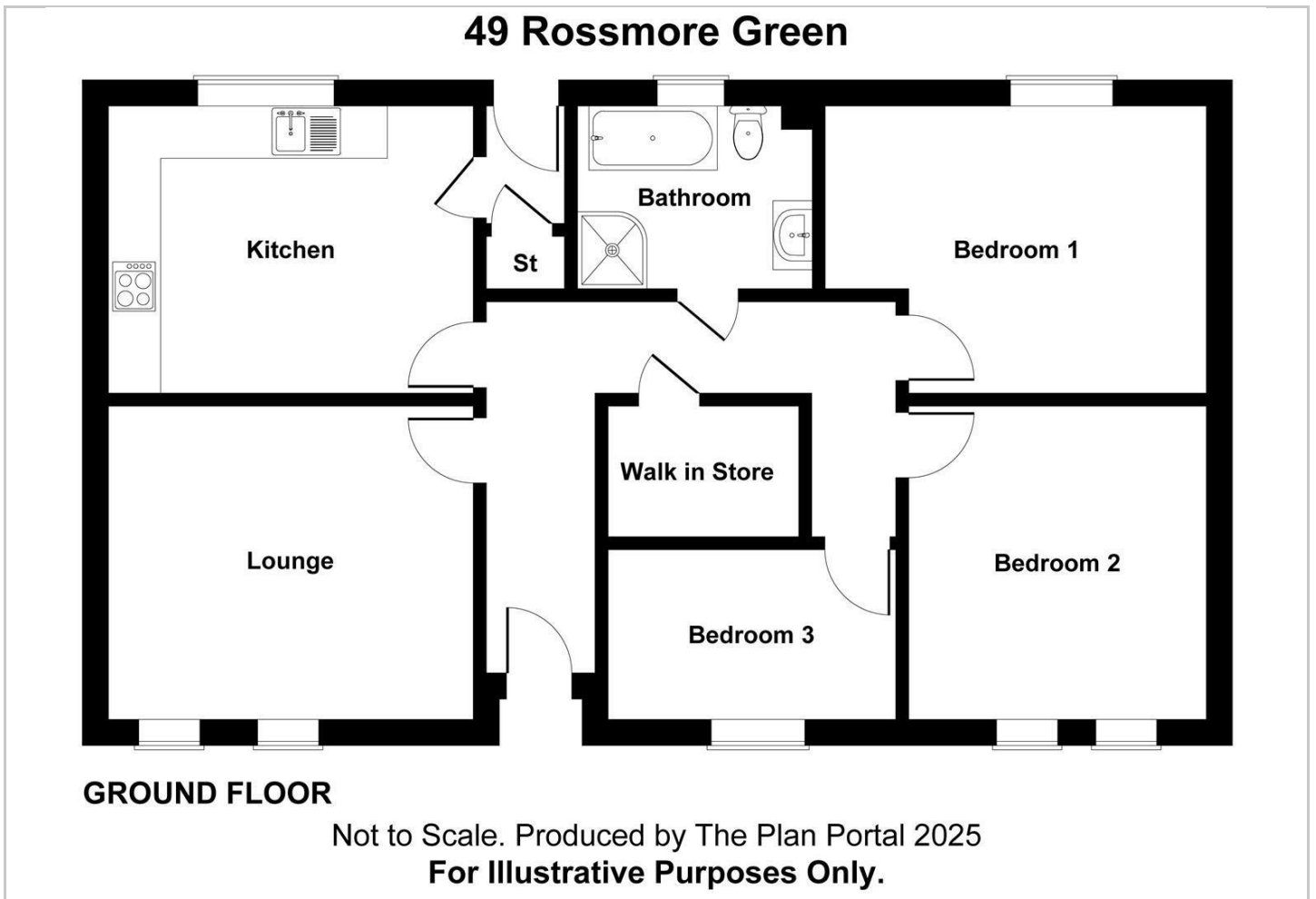

Viewing

Please contact our Ballymena Office on 02825655733 if you wish to arrange a viewing appointment for this property or require further information.

Energy Efficiency Graph

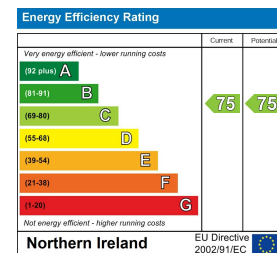

These particulars, whilst believed to be accurate are set out as a general outline only for guidance and do not constitute any part of an offer or contract. Intending purchasers should not rely on them as statements of representation of fact, but must satisfy themselves by inspection or otherwise as to their accuracy. No person in this firm's employment has the authority to make or give any representation or warranty in respect of the property. Edmondson Estates have not tested any services, equipment, or facilities within the premises and will not be liable, in negligence or otherwise, for any loss arising from the use of these particulars.