

Tim Martin
_co.uk



6.18 Acres or Thereabouts
Quality Agri Lands
Old Ballygowan Road
Comber
BT23 5RP

Offers Around
£125,000

www.timmartin.co.uk
Telephone 028 91 878956

Situated between the Ballygowan and Old Ballygowan Road with access from the Old Ballygowan Road.

We are pleased to offer 6.18 acres or thereabouts of quality agricultural lands contained in two fields. The lands are laid down to grass but and are thought to be equally suitable for grazing, cutting and arable purposes.

They provide the purchaser an opportunity to acquire lands to add to an existing farm, own their own lands to graze horses / ponies or a range of rural pursuits.

Available in lots.

Asking Price Offers Around £125,000

Viewing - Anytime

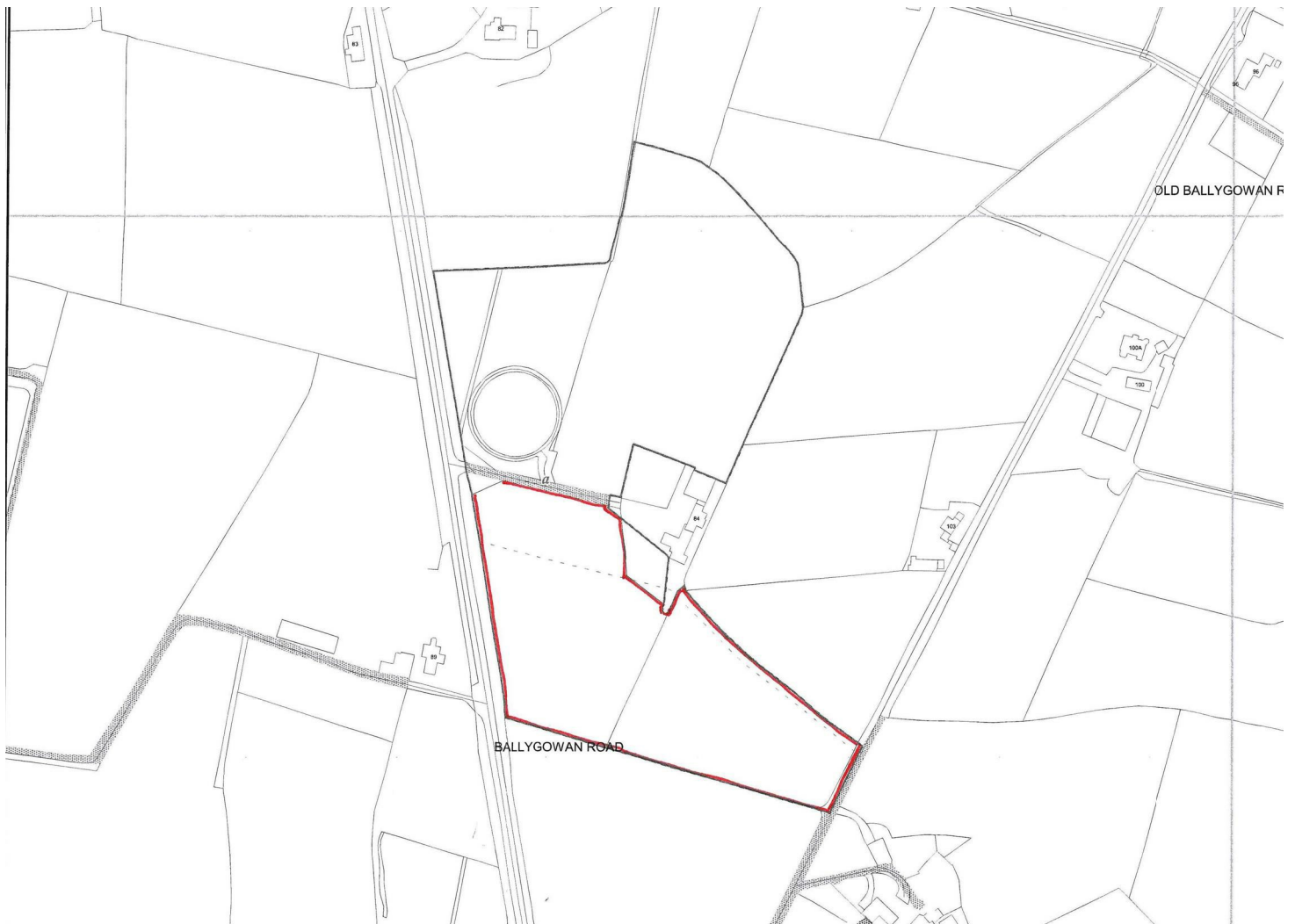

Energy Efficiency Rating		Current	Potential
<i>Very energy efficient - lower running costs</i>			
(92 plus)	A		
(81-91)	B		
(69-80)	C		
(55-68)	D		
(39-54)	E		
(21-38)	F		
(1-20)	G		
<i>Not energy efficient - higher running costs</i>			
Northern Ireland		EU Directive 2002/91/EC	

Comber ■
27 Castle Street, Comber, BT23 5DY
T 028 91 8789596

Saintfield
1B Main Street, Saintfield, BT24 7AA
T 028 97 568300

Tim Martin & Company for themselves and for the vendors of this property have endeavoured to prepare these sales details as accurate and reliable as possible for the guidance of intending purchasers or lessees. These particulars are given for general guidance only and do not constitute any part of an offer or contract. The seller and us as agents, do not make any representation or give any warranty in relation to the property. We would recommend that all information contained in this brochure about the property be verified by yourself or professional advisors. Services, fittings and equipment referred to in the sales details have not been tested (unless otherwise stated) and no warranty will be given as to their condition. All measurements contained within this brochure are approximate. Please contact us prior to viewing the property. If there is any point of particular importance to you we would be pleased to provide additional information or make further enquiries. We will also confirm that the property remains available. This is particularly important if you are contemplating travelling some distance to view the property.