



## 42 Quarter Road Cloughey, Newtownards, BT22 1JF

Located less than 1/2 mile from the beautiful Cloughey beach yet in the heart of rural countryside this detached home is deceptively spacious, at over 1,250 sq.ft. having benefited from a practical extension and roof space conversion some years ago.

It offers two reception rooms to the front, one with a feature tiled fireplace and adjacent to the kitchen, and 2 ground floor bedrooms including a spacious master to the rear. The bathroom has been prepared for a person with restricted mobility and would benefit from a refit to suit most tastes. The first floor offers two further bedrooms both with views of Kirkistown golf course and one with dual aspect offering additional countryside views to the rear.

The property is in overall good condition and a little paint and fresh floor coverings would quickly bring it up to date. The oil fired boiler was replaced within the last few years and windows and fascia are uPVC double glazed. Most buyers will choose to upgrade the bathroom and some may consider knocking through the kitchen and sitting room to provide a central living area, in keeping with modern tastes.

The location of this property is charming with the beach within easy reach and the golf course to the front plus open countryside to the rear - an ideal holiday home or practical family home depending on your situation.

**Offers Around £219,950**

# 42 Quarter Road

Cloughey, Newtownards, BT22 1JF



- Extended detached bungalow
- Sitting room with tiled fireplace
- uPVC double glazing & fascia
- Golf course & countryside views - Short walk to the beach

- 4 bedrooms - 2 on first floor with excellent views
- Kitchen
- Oil fired central heating

- Lounge
- Ground floor shower room
- Gardens to front and side with rear yard and utility shed

## Entrance

## Porch

4'3x4 (1.30mx1.22m)

## Hallway

## Sitting room

11'4x10'6 (3.45mx3.20m)

## Kitchen/diner

12'6x10'2 (3.81mx3.10m)

## Lounge

12'2x10'5 (3.71mx3.18m)

## Bedroom 1 (Rear GF)

15'8x10'2 (4.78mx3.10m)

## Shower room

8'9x8'6 (2.67mx2.59m)

## Bedroom 4 (GF)

12'11x8'2 (3.94mx2.49m)

## Landing

14'2x4 (4.32mx1.22m)

## Bedroom 2

14'2x11'7 (4.32mx3.53m)

## Bedroom 3

12x11'1 (3.66mx3.38m)

## Utility shed

## Outside

## Tenure

## Buyers notes

## Property misdescriptions



## Directions

Travelling through Cloughey in the Portaferry direction turn right onto Quarter Road just past the Primary School. Number 42 is the last of the row of properties on the left facing the Golf course.





Floor Plan

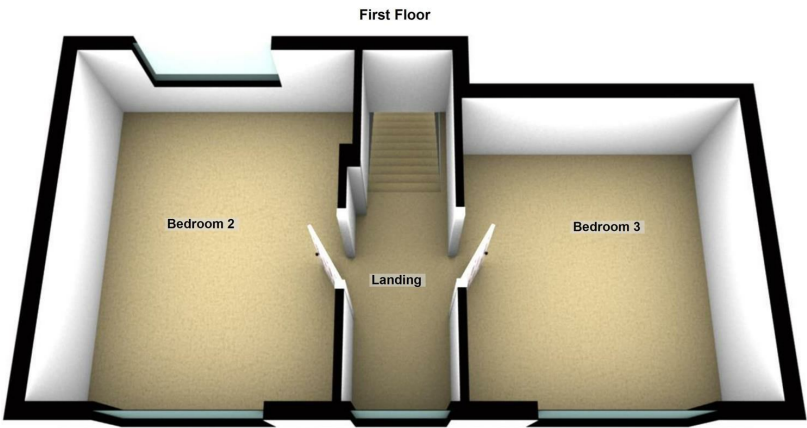
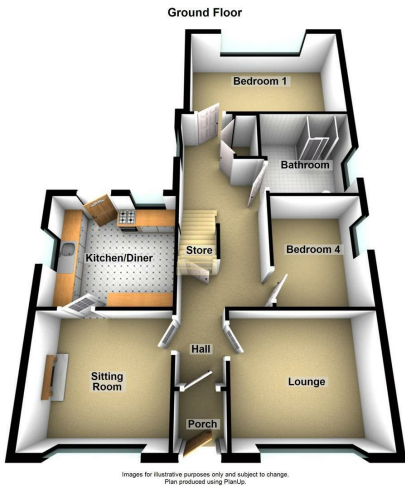

These particulars, whilst believed to be accurate are set out as a general outline only for guidance and do not constitute any part of an offer or contract. Intending purchasers should not rely on them as statements of representation of fact, but must satisfy themselves by inspection or otherwise as to their accuracy. No person in this firms employment has the authority to make or give any representation or warranty in respect of the property.

