

9261 2121
stewartestateagents.com

stewart
estate agents



33 CLAREMONT AVENUE

Moira BT67 0SS

Offers around
£157,500







Ground Floor

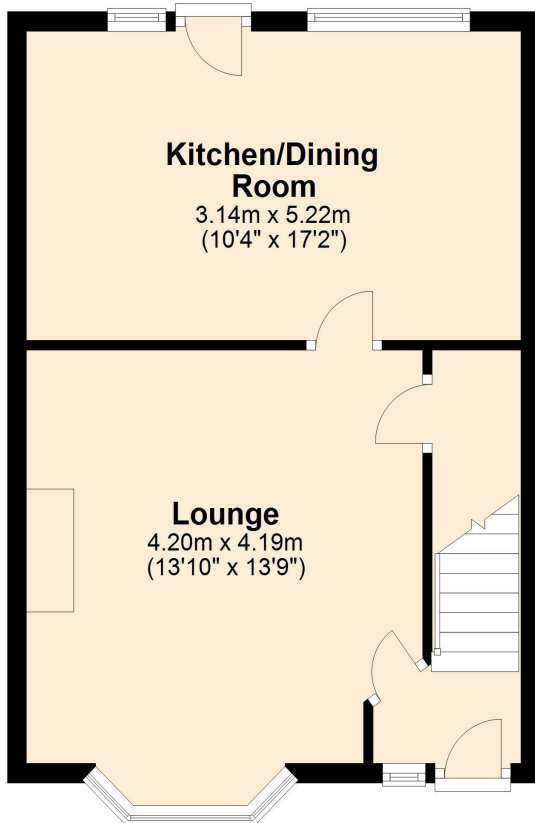

First Floor

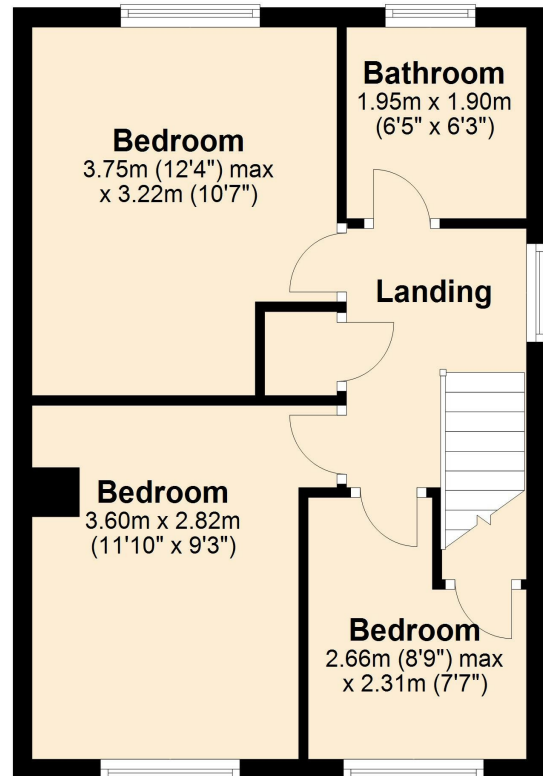

Description

A very stylish semi-detached home enjoying a good position within a smart cul-de-sac of similar homes and bungalows, located on the edge of Moira's bustling village for all major amenities and eateries as well as Rowandale Integrated Primary School, Moira Primary School, the Demesne and excellent road networks for commuters.

The property has a contemporary style kitchen with dining area, an attractive lounge with box bay window and a modern bathroom on the first floor with white suite. A wonderful opportunity for first time purchasers and investors. Viewing highly recommended!

Features:-

- Stylish semi detached home
- Three good sized bedrooms
- Bright entrance hallway with a PVC double glazed front door
- Lounge with an attractive fireplace and open fire. Feature bay window
- Open plan kitchen with dining area including well fitted kitchen units having ample high and low level storage cabinets
- Bathroom on the first floor with a modern white bathroom suite
- Gas fired central heating
- PVC double glazed windows
- Tarmac driveway to the side of the property
- Gardens front and rear



Score	Energy rating	Current	Potential
92+	A		
81-91	B		
69-80	C		70 C
55-68	D	63 D	
39-54	E		
21-38	F		
1-20	G		

These particulars do not constitute any part of an offer or contract. None of the statements contained in these particulars are to be relied on as statements or representations of fact and intending purchasers must satisfy themselves by inspection or otherwise to the correctness of each of the statements contained in these particulars. The vendor does not make or give, and neither Stewart Estate Agents, nor any person in its employment has any authority to make or give, any representation or warranty whatever in relation to this property. Stewart Estate Agents has not tested any equipment, apparatus, fittings or services and cannot verify that these are in working order.