

Tim Martin
.co.uk



34 Castle Street
Comber
BT23 5DZ

Offers Around
£62,500

www.timmartin.co.uk
Telephone 028 91 878956

SUMMARY

An excellent opportunity to acquire this prominent retail unit, situated in the heart of Comber, close to the bustling town square.

The property, suitable for a wide range of uses (subject to planning), comprises of a main retail unit, two offices and kitchen and WC facilities. Additional storage is located on the first floor (access through Slingsby type ladder). Outside, the property enjoys an enclosed rear garden.

Ideally located, the property is situated amongst an excellent range of new and well established businesses to include SuperValu, Indie Fude, Post Office and Hardys Hardware Store and is within close proximity to some residential developments.

The property is easily accessible from the surrounding towns of Lisbane, Killinchy, Ballygowan and Newtownards as well as Belfast city centre via an excellent road network and public transport links.

FEATURES

- Prominent Retail Unit Situated In The Heart Of Comber Village
- Comprising Of A Main Retail Unit, Offices, Kitchen And WC Facilities
- Additional Storage On First Floor (Access Through Slingsby Type Ladder)
- Suitable For A Wide Range Of Uses (Subject To Planning)
- Close To Comber Town Square
- Situated Amongst Many New And Established Retailers And Residential Developments
- Easily Accessible From Ballygowan, Lisbane, Killinchy, Newtownards And Belfast City Centre

Ground Floor

Retail

355 Sqft

Glazed hardwood entrance door; display window; wood laminate floor; recessed spotlights.

Office

124 Sqft (Average measurements)

Wood laminate floor.

Kitchen

37 Sqft

Single drainer stainless steel sink unit with Newlec hotwater tap; laminate cupboards under; laminate worktop; fluorescent lighting.

WC

Low flush WC.

Rear Hallway

Built in storage cupboards; fluorescent lighting.

Office

208 Sqft

Wood laminate floor; fluorescent lighting; access to rear.

First Floor

(Access via slingby type ladder)

Store

166 Sqft

Store

106 Sqft

Stairs to Second Floor Storage

Outside

Enclosed rear area laid out in paving stones and decorative gravel.

Tenure

Leasehold

Total Nav

£4050.00. Rates Payable = £2303.10 per annum (approximately)







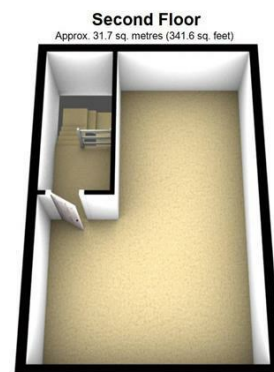
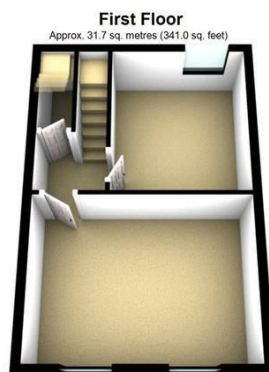
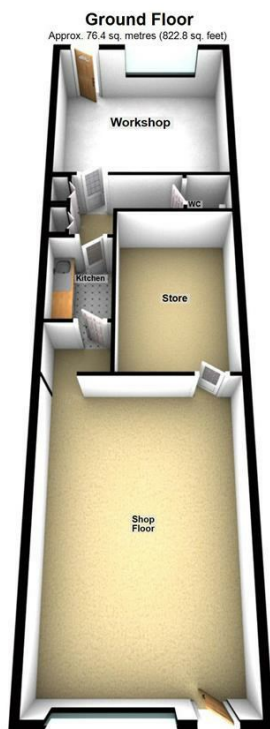

21 Oct 2020
 DWN
 DN24348BL
 1-1-125D
 2020/646124
 SGR/JW/CRC/CSBY
 14810SE

11

D labels:
 13488L

Information provided by the Land Registry and Ordnance Survey is intended to be used as a guide only. It is not intended to be used as a legal document. It is not intended to be used as a legal document. It is not intended to be used as a legal document. It is not intended to be used as a legal document. It is not intended to be used as a legal document.

Right Reserved
 The information on this page is provided by the Land Registry and Ordnance Survey. It is not intended to be used as a legal document. It is not intended to be used as a legal document. It is not intended to be used as a legal document. It is not intended to be used as a legal document.

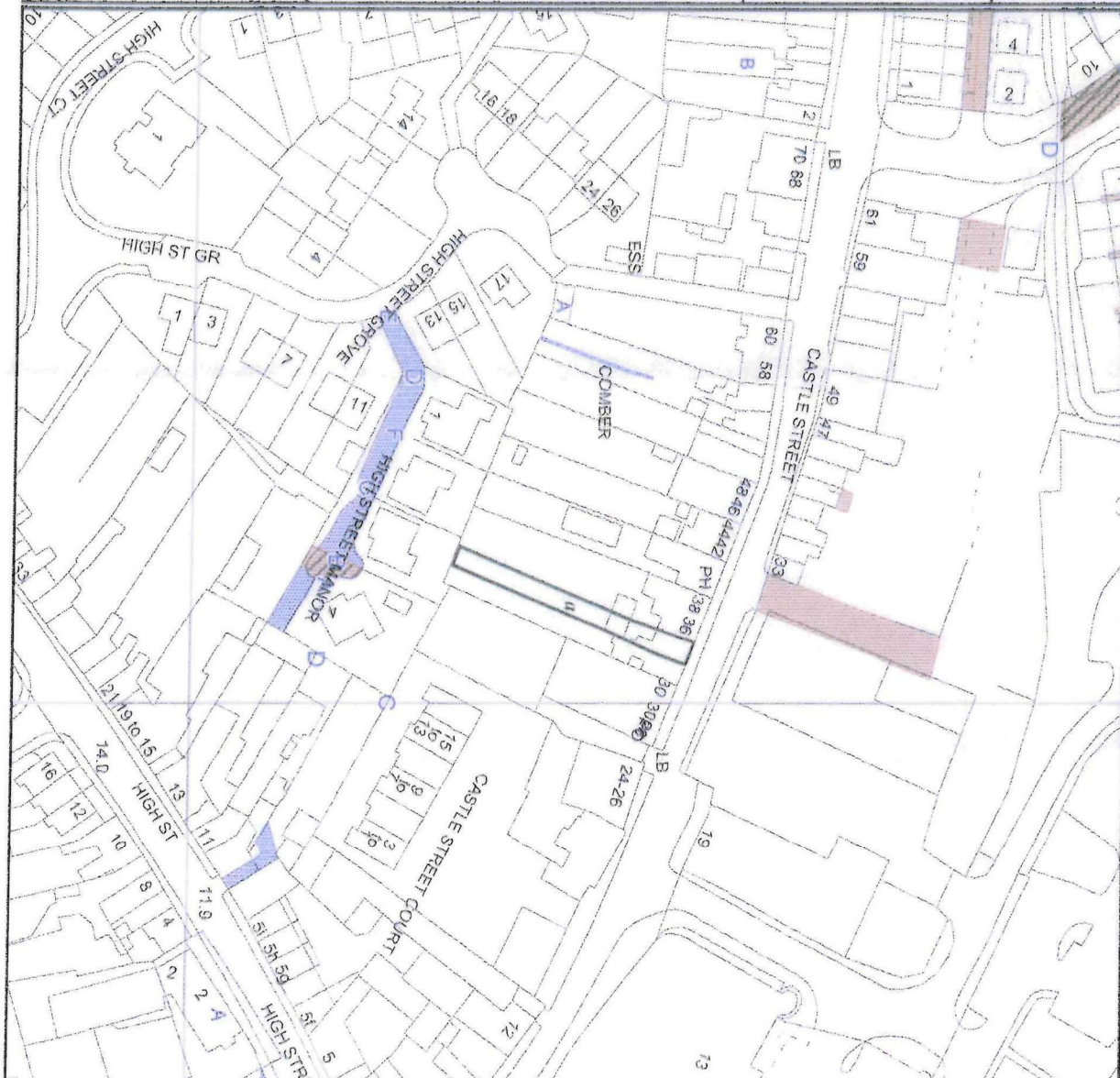

Energy Efficiency Rating		Current	Potential
Very energy efficient - lower running costs			
(92 plus)	A		
(81-91)	B		
(69-80)	C		
(55-68)	D		
(39-54)	E		
(21-38)	F		
(1-20)	G		
Not energy efficient - higher running costs			

Comber ■
 27 Castle Street, Comber, BT23 5DY
 T 028 91 8789596

Saintfield
 1B Main Street, Saintfield, BT24 7AA
 T 028 97 568300

Tim Martin & Company for themselves and for the vendors of this property have endeavoured to prepare these sales details as accurate and reliable as possible for the guidance of intending purchasers or lessees. These particulars are given for general guidance only and do not constitute any part of an offer or contract. The seller and us as agents, do not make any representation or give any warranty in relation to the property. We would recommend that all information contained in this brochure about the property be verified by yourself or professional advisors. Services, fittings and equipment referred to in the sales details have not been tested (unless otherwise stated) and no warranty will be given as to their condition. All measurements contained within this brochure are approximate. Please contact us prior to viewing the property. If there is any point of particular importance to you we would be pleased to provide additional information or make further enquiries. We will also confirm that the property remains available. This is particularly important if you are contemplating travelling some distance to view the property.