



62 DRUMANESS ROAD

Ballynahinch BT24 8LT

- Five bedrooms
- Large kitchen/ dining area
- Two bathrooms
- Spacious outside area
- Large garden
- Oil fired central heating
- Situated between Ballynahinch and Seaforde
- Living room
- In need of some modernisation
- Good location

Energy Efficiency Rating		Current	Potential
Very energy efficient - lower running costs			
(92 plus) A			
(81-91) B			
(69-80) C			
(55-68) D		64	68
(39-54) E			
(21-38) F			
(1-20) G			
Not energy efficient - higher running costs			
Northern Ireland		EU Directive 2002/91/EC	

Offers Around £250,000

62 Drumaness Road , Ballynahinch, BT24 8LT



Entrance Hall

18'5" x 8'2" (5.62m x 2.49m)

Glazed wooden front door, leading to entrance hall. Tiled flooring. Stairs leading to first floor. Storage space under stairs.

Living Room

14'5" x 16'0" (4.40m x 4.88m)

Spacious living room. Carpeted flooring. Two windows to rear, door to: entrance hall.

Kitchen/Dining Room

30'4" x 11'10" (9.24m x 3.61m)

Large kitchen/ dining room containing low and high rise units with space oven/hob, stainless steel extractor fan, plumbed for dishwasher, stainless steel sink. tiled flooring. Two windows to rear, window to side, window to front.

Bedroom 1

14'0" x 10'4" (4.27m x 3.15m)

Carpeted flooring. Window to rear, window to side.

Store

3'8" x 4'3" (1.12m x 1.30m)

Bedroom 2

11'7" x 11'9" (3.53m x 3.58m)

Carpeted flooring. Two windows to front.

Bedroom 3

11'7" x 12'4" (3.53m x 3.76m)

Carpeted flooring. Two windows to front, door to:

Bathroom

11'7" x 10'5" (3.53m x 3.18m)

White suite comprising stand alone shower cubicle, bath, low rise w.c. and wash hand basin. Tiled flooring and splash area. Two windows to front.

Landing

16'10" x 20'8" (5.13m x 6.30m)

Spacious landing with carpeted flooring. Two skylights. Storage space beside stairs.

Bedroom 4

16'10" x 12'9" (5.13m x 3.89m)

Large bedroom with carpeted flooring. Window to side.

Shower Room

White suite comprising low rise w.c, wash hand basin with vanity unit, stand alone shower cubicle. Skylight. Tiled flooring.

Bedroom 5

16'10" x 6'7" (5.13m x 2.00m)

Large bedroom with carpeted flooring. Window to side, Storage cupboard with sliding door.

Outside

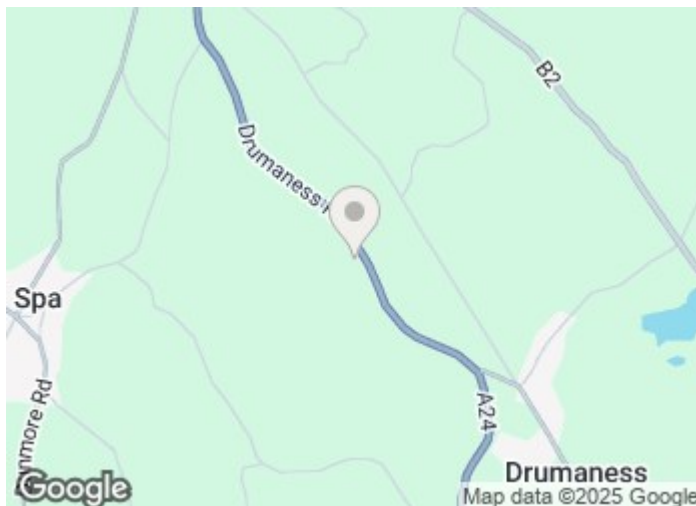

Directions



Floor Plan

Ground Floor

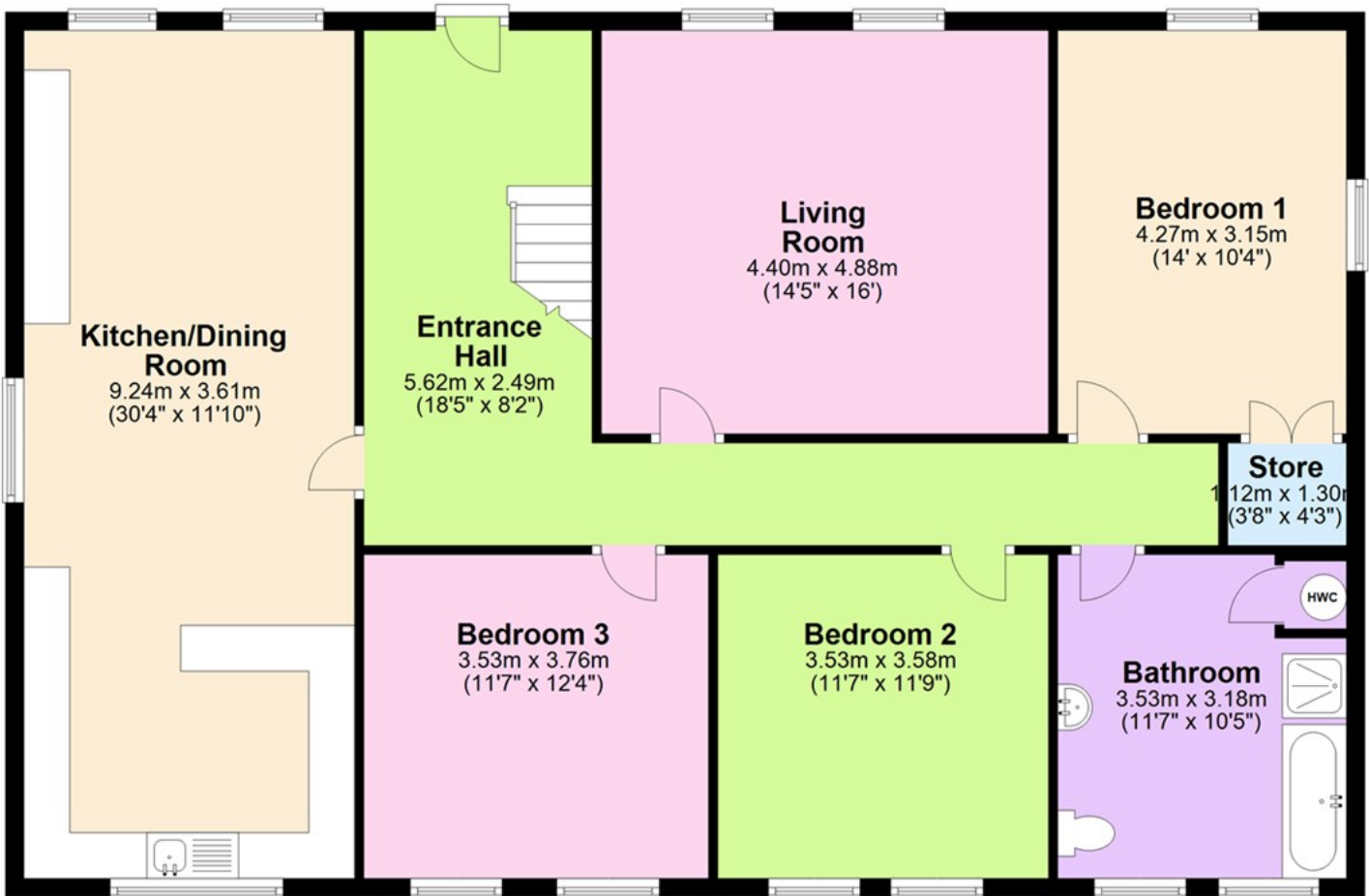

These particulars, whilst believed to be accurate are set out as a general outline only for guidance and do not constitute any part of an offer or contract. Intending purchasers should not rely on them as statements of representation of fact, but must satisfy themselves by inspection or otherwise as to their accuracy. No person in this firm's employment has the authority to make or give any representation or warranty in respect of the property.

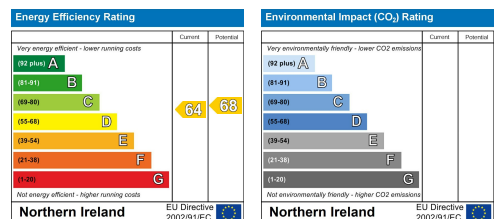

ULSTERPROPERTYSALES.CO.UK

ANDERSONSTOWN
028 9060 5200

BANGOR
028 9127 1185

DOWNPATRICK
028 4461 4101

GLENGORMLEY
028 9083 3295

RENTAL DIVISION
028 9070 1000

BALLYHACKAMORE
028 9047 1515

CARRICKFERGUS
028 9336 5986

DONAGHADEE
028 9188 8000

MALONE
028 9066 1929

BALLYNAHINCH
028 9756 1155

CAVEHILL
028 9072 9270

FORESTSIDE
028 9064 1264

NEWTOWARDS
028 9181 1444



Aaron Ferris trading under licence as Ulster Property Sales (Ballynahinch)
©Ulster Property Sales is a Registered Trademark