

**Tim Martin**  
co.uk



**Lands at the Junction of  
Ballylesson & Fort Rd  
Drumbo  
BT8 8JT**

**Price Guide  
£100,000**

[www.timmartin.co.uk](http://www.timmartin.co.uk)  
Telephone 028 91 878956

A rare opportunity exists to acquire 4.935 acres or thereabouts of high quality arable lands enjoying good frontage to the Ballylesson and Fort Roads. The lands accessed directly off the Fort Road, have been regularly planted in potatoes (season 2024) and wheat (season 2025) providing quality crops. The lands are thought equally suitable for cutting and / or grazing.

The lands have two boundaries undefined. It will be the responsibility of the purchaser to fence these boundaries.

The lands are let in conacre with vacant possession available of the harvesting of the central crop. Current rent will be apportioned between vendors and purchasers on completion of the sale of the lands on the assumption that the completion of the sale of the lands is prior to the removal of the crop.

Note: A 12 foot right of way and easement for a water pipe exists across a portion of these lands.

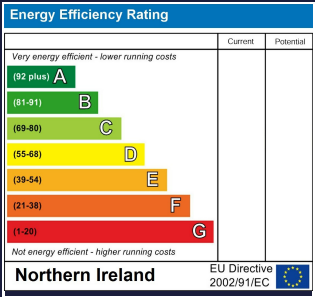
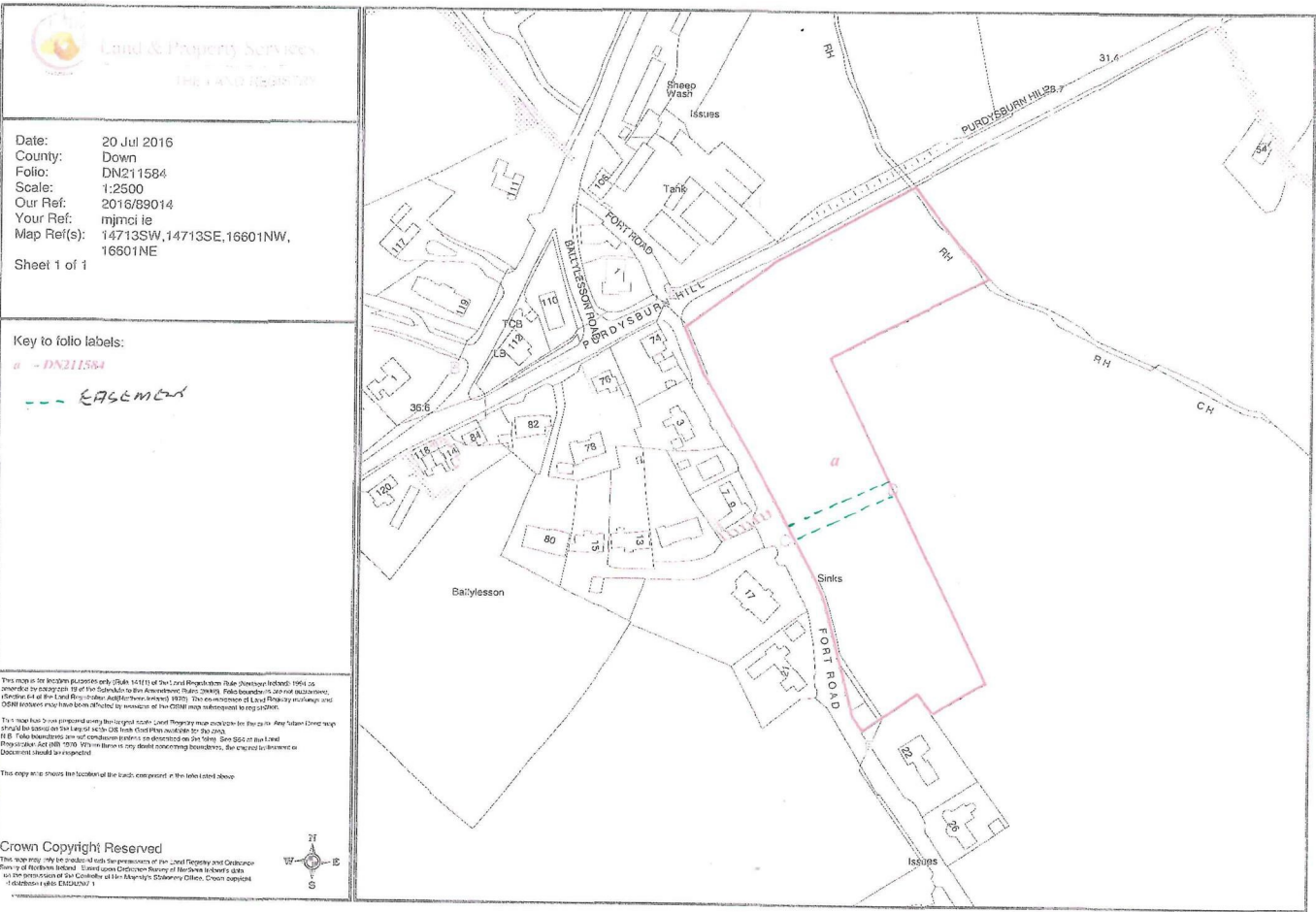

Comber  
27 Castle Street, Comber, BT23 5DY  
T 028 91 8789596

Saintfield  
1B Main Street, Saintfield, BT24 7AA  
T 028 97 568300

Tim Martin & Company for themselves and for the vendors of this property have endeavoured to prepare these sales details as accurate and reliable as possible for the guidance of intending purchasers or lessees. These particulars are given for general guidance only and do not constitute any part of an offer or contract. The seller and us as agents, do not make any representation or give any warranty in relation to the property. We would recommend that all information contained in this brochure about the property be verified by yourself or professional advisors. Services, fittings and equipment referred to in the sales details have not been tested (unless otherwise stated) and no warranty will be given as to their condition. All measurements contained within this brochure are approximate. Please contact us prior to viewing the property. If there is any point of particular importance to you we would be pleased to provide additional information or make further enquiries. We will also confirm that the property remains available. This is particularly important if you are contemplating travelling some distance to view the property.