



42 Ethel Street, Belfast, BT9 7FW

Price Guide £225,000

Conveniently located off the Lisburn Road, close to many restaurants and boutiques, this attractive mid terrace property offers potential purchasers the opportunity to purchase in one of the most popular areas of South Belfast. Bright and spacious the accommodation comprises open plan living / dining, large fitted kitchen, three good sized bedrooms and modern bathroom suite. A major advantage is the generous south facing garden to rear. Oil fired central heating and PVC double glazing have also been installed. With close proximity to the City Centre, main hospitals, an abundance of social and recreational amenities and excellent transport links, this area is proving extremely popular with first time buyers or investors seeking a lucrative rental income.

- Beautifully Presented Terraced Home
- Excellent Kitchen With Double Doors
- First Floor Bathroom Suite
- PVC Double Glazed Windows
- Open Plan Lounge / Dining
- Three Good Sized Bedrooms
- Oil Fired Central Heating
- Convenient Location With Walking Distance To Shops, Restaurants & Many Other Amenities

Energy Efficiency Rating		Current	Potential
(92-100)	A		
(81-91)	B		
(69-80)	C		
(55-68)	D		
(39-54)	E	48	56
(21-38)	F		
(1-20)	G		

Not energy efficient - higher running costs

Northern Ireland EU Directive 2002/91/EC

**THE ACCOMMODATION COMPRISES
ON THE GROUND FLOOR
ENTRANCE**



Composite front door.

LOUNGE 12'5" x 10'2" (3.8 x 3.1)



Open plan to dining. Feature cornice. Bay window.

DINING ROOM 11'9" x 10'5" (3.6 x 3.2)



Built in storage. Feature cornice.

KITCHEN 23'3" x 8'6" (7.1 x 2.6)



Excellent range of high and low level units, granite worktops, extractor fan, belfast sink, plumbed for dishwasher / washing machine, ceramic tiled floor and part tiled walls. Access to south facing garden.

ON THE FIRST FLOOR



BEDROOM ONE 13'9" x 10'2" (4.2 x 3.1)



Basin with vanity unit. Solid wood floor.

BEDROOM TWO 11'1" x 8'6" (3.4 x 2.6)



Enclosed shower.

BEDROOM THREE 13'5" x 8'2" (4.1 x 2.5)



Solid wood floor.

BATHROOM



Modern white suite comprising panel bath with shower over, low flush W.C, wash hand basin with built in storage, electric shower, part tiled walls.

OUTSIDE



Paved front garden, enclosed south facing garden to rear with outside tap.



Floor Plan

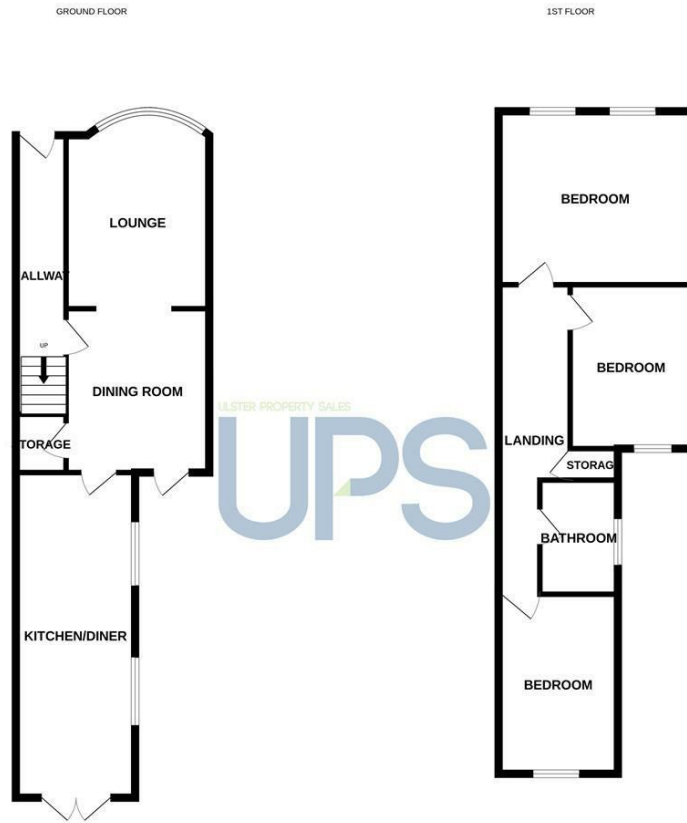

Whilst every attempt has been made to ensure the accuracy of the floorplan contained here, measurements of doors, windows, rooms and any other items are approximate and no responsibility is taken for any error, omission or mis-statement. This plan is for illustrative purposes only and should be used as such by any prospective purchaser. The services, systems and appliances shown have not been tested and no guarantee as to their operability or efficiency can be given. Made with Housify ©2024

Area Map

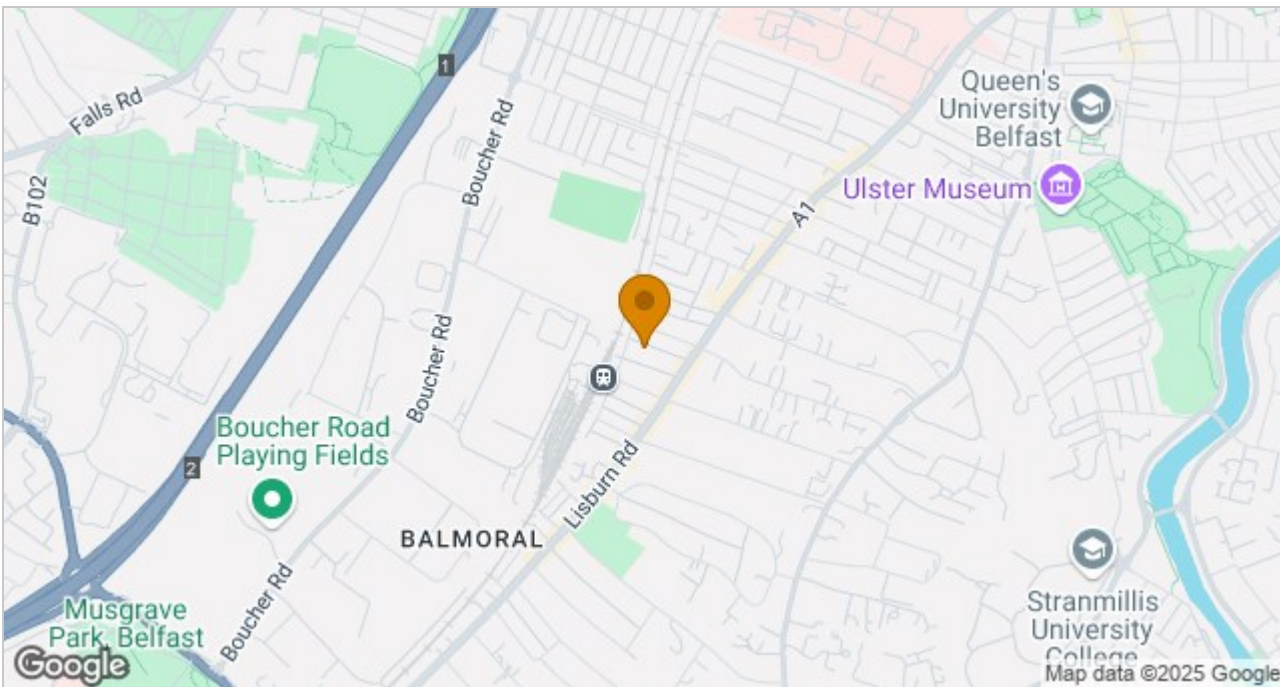

These particulars, whilst believed to be accurate are set out as a general outline only for guidance and do not constitute any part of an offer or contract. Intending purchasers should not rely on them as statements of representation of fact, but must satisfy themselves by inspection or otherwise as to their accuracy. No person in this firm's employment has the authority to make or give any representation or warranty in respect of the property.

ULSTERPROPERTYSALES.CO.UK

ANDERSONSTOWN
028 9060 5200

BANGOR
028 9127 1185

BALLYHACKAMORE
028 9047 1515

CARRICKFERGUS
028 9336 5986

BALLYNAHINCH
028 9756 1155

CAVEHILL
028 9072 9270

DONAGHADEE
028 9188 8000

DOWNPATRICK
028 4461 4101

FORESTSIDE
028 9064 1264

GLENGORMLEY
028 9083 3295

MALONE
028 9066 1929

NEWTOWNARDS
028 9181 1444

RENTAL DIVISION
028 9070 1000



John Thompson trading under licence as Ulster Property Sales (Downpatrick)
©Ulster Property Sales is a Registered Trademark