



## 102 Gallows Street

, Dromore, BT25 1BD

£109,950

Cairns and Downing Sales and Lettings are delighted to bring to the sales market this very attractive mid terrace property situated within a residential location on the edge of Dromore Town, convenient to the local amenities as well as primary & nursery schools and excellent road networks to other towns and cities.

Internally the property is comprised of entrance porch through to a spacious living room, a fitted kitchen with a range of high and low level units and dining bar. Moving on to the bedrooms, you will find 3 well-appointed rooms that offers a peaceful retreat at the end of a long day.

Outside you will find a spacious rear garden laid in paving with steps to lower garden.

### Viewing

Please contact our Cairns and Downing Office on 02896 223 011 if you wish to arrange a viewing appointment for this property or require further information.

- Well Presented Mid Terrace Property Situated Within A Popular Location Close To Dromore Town
- Spacious Lounge
- Spacious Kitchen And Dining Area With Dining Bar
- Three Bedrooms With Built In Storage
- Bathroom With Bath
- Separate WC
- Rear Garden Laid In Paving With Steps To Lower Garden
- Front Garden Laid In Stone And Paving With Path To Entrance Door
- Oil Fired Central Heating System





## Floor Plan

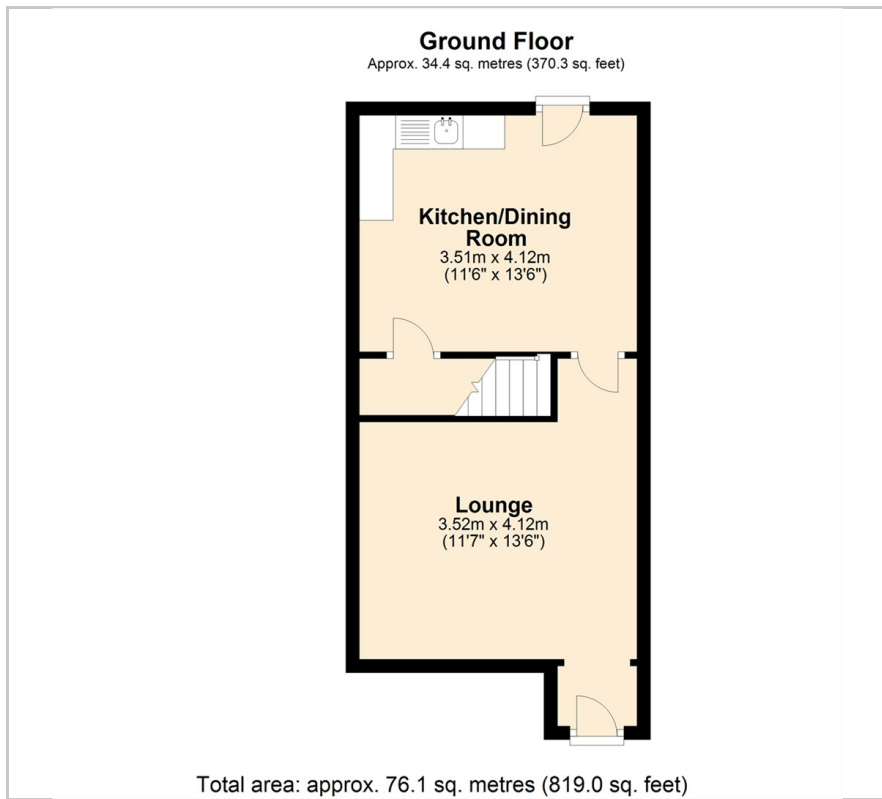

## Area Map



## Energy Efficiency Graph

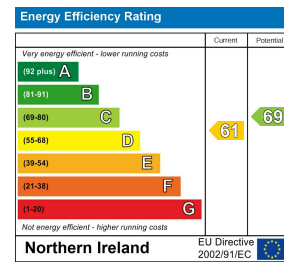

These particulars, whilst believed to be accurate are set out as a general outline only for guidance and do not constitute any part of an offer or contract. Intending purchasers should not rely on them as statements of representation of fact, but must satisfy themselves by inspection or otherwise as to their accuracy. No person in this firm's employment has the authority to make or give any representation or warranty in respect of the property.

1 Meeting Street, Dromore, Down, BT25 1AQ

Tel: 02896 223 011 Email: [info@cairnsanddowning.co.uk](mailto:info@cairnsanddowning.co.uk) <https://www.cairnsanddowning.co.uk>