



Date: 11 Dec 2024  
 County: Armagh  
 Folio: AR121524  
 Scale: 1:2500  
 Our Ref: 2024/1036986  
 Your Ref: WT/Kate Cumming  
 Map Ref(s): 24910NE,24910SE

Sheet 1 of 1

Key to folio labels:

*a* - AR121524

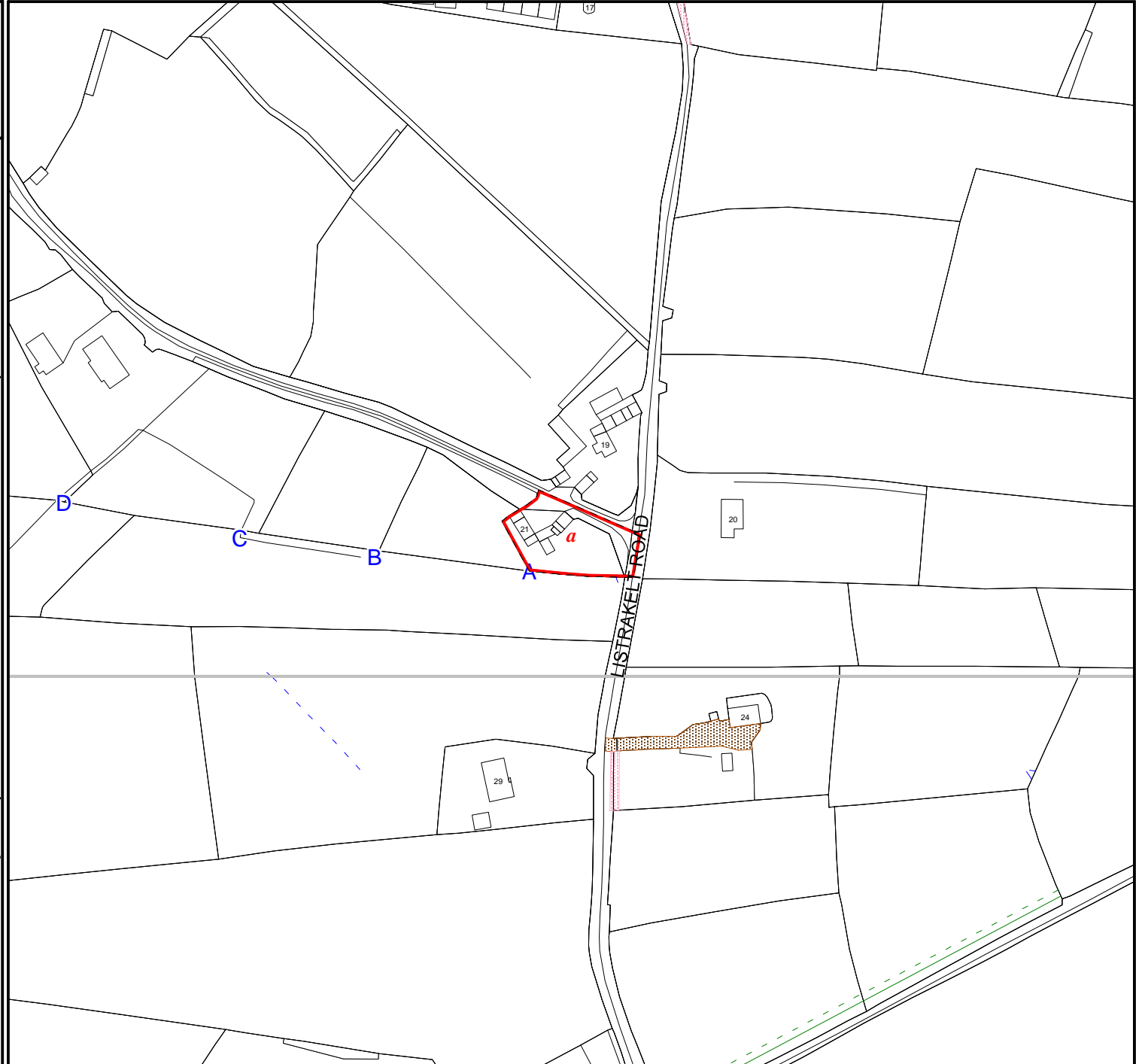

This map is for location purposes only (Rule 141(1) of the Land Registration Rule (Northern Ireland) 1994 as amended by paragraph 19 of the Schedule to the Amendment Rules 2000). Folio boundaries are not guaranteed, (Section 64 of the Land Registration Act(Northern Ireland) 1970). The co-incident of Land Registry markings and OSNI features may have been affected by revisions of the OSNI map subsequent to registration.

This map has been prepared using the largest scale Land Registry map available for the area. Any future Deed map should be based on the largest scale OS Irish Grid Plan available for the area.  
 N.B. Folio boundaries are not conclusive (unless so described on the folio). See S64 of the Land Registration Act (NI) 1970. Where there is any doubt concerning boundaries, the original Instrument or Document should be inspected.

This copy map shows the location of the lands comprised in the folio listed above.

Crown Copyright Reserved

This map may only be produced with the permission of the Land Registry and Ordnance Survey of Northern Ireland. Based upon Ordnance Survey of Northern Ireland's data with the permission of the Controller of Her Majesty's Stationery Office, Crown copyright and database rights EMOU207.1.

