



4 Eureka Drive, Belfast, BT12 5NR

Price Guide £110,000

This excellent end-terrace property is located just off the Donegall Road in South Belfast. Close to many amenities and within walking distance to the City Centre & City hospital this home would make an ideal first time buy or investment. The spacious accommodation comprises two good size bedrooms, comfortable living room, kitchen with dining, first floor bathroom and enclosed patio area with garden to rear. Further benefits include oil fired central heating and PVC Double Glazed windows. View now to avoid disappointment.

- End Terrace Property
- One Reception
- First Floor Bathroom Suite
- PVC Double Glazed Windows
- EPC E48
- Two Bedrooms
- Kitchen / Dining Area
- Oil Central Heating
- Suitable For A Range Of Buyers

Energy Efficiency Rating		Current	Potential
(92-100)	A		
(81-91)	B		
(69-80)	C		
(55-68)	D		
(39-54)	E	48	63
(21-38)	F		
(1-20)	G		
Not energy efficient - higher running costs			
Northern Ireland			
		EU Directive 2002/91/EC	

**THE ACCOMMODATION COMPRISES OF
ON THE GROUND FLOOR**

ENTRANCE

PVC Front door.

LIVING ROOM 15'1" x 9'10" (4.6 x 3.0)



KITCHEN / DINING 14'9" x 10'9" (4.5 x 3.3)



Range of high and low level units, extractor fan, sink unit with mixer tap, plumbed for washing machine, part tiled walls and wood effect floor. Built in storage.

ON THE FIRST FLOOR

BEDROOM ONE 15'8" x 9'10" (4.8 x 3.0)



Built in storage.

BEDROOM TWO 10'5" x 7'6" (3.2 x 2.3)



BATHROOM 7'6" x 7'2" (2.3 x 2.2)



White suite comprising, panel bath, low flush W.C, pedestal wash hand basin, extractor fan, wood paneled walls and vinyl floor.

OUTSIDE



Large patio area to rear with outhouse.

Floor Plan

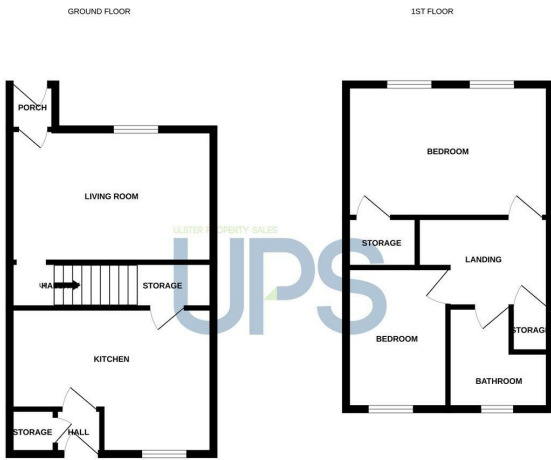

While every attempt has been made to ensure the accuracy of the description contained herein, measurements of plots, areas, etc. are only approximate and should not be relied upon for any legal or financial purposes. This plan is for guidance purposes only and should not be used as a substitute for a professional surveyor's report. The agent, vendor and purchaser shall be deemed to have accepted the accuracy of the description as shown on this plan. Made with Mapbox ES2024

Area Map

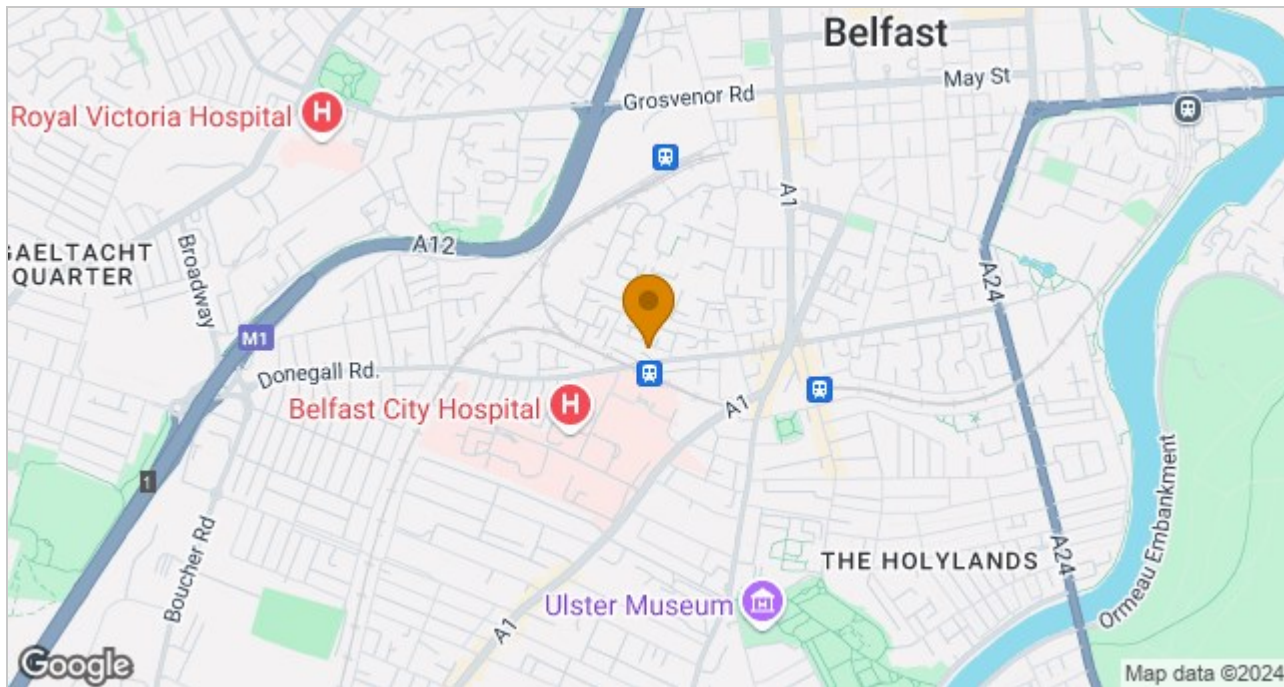

These particulars, whilst believed to be accurate are set out as a general outline only for guidance and do not constitute any part of an offer or contract. Intending purchasers should not rely on them as statements of representation of fact, but must satisfy themselves by inspection or otherwise as to their accuracy. No person in this firm's employment has the authority to make or give any representation or warranty in respect of the property.

ULSTERPROPERTYSALES.CO.UK

- | | | | | |
|--|---------------------------------------|--|-------------------------------------|---|
| ANDERSONSTOWN
028 9060 5200 | BALLYNAHINCH
028 9756 1155 | CAUSEWAY COAST
0800 644 4432 | FORESTSIDE
028 9064 1264 | NEWTOWNARDS
028 9181 1444 |
| BALLYHACKAMORE
028 9047 1515 | BANGOR
028 9127 1185 | CAVEHILL
028 9072 9270 | GLENGORMLEY
028 9083 3295 | RENTAL DIVISION
028 9070 1000 |
| BALLYMENA
028 2565 7700 | CARRICKFERGUS
028 9336 5986 | DOWNPATRICK
028 4461 4101 | MALONE
028 9066 1929 | |



John Thompson trading under licence as Ulster Property Sales (Downpatrick)
©Ulster Property Sales is a Registered Trademark