



# The Kerr (BH6)

Render finish. Site nos. 1, 2

3 Bedroom | Semi Detached | Total Area: 1135 sq ft

**GROUND FLOOR**

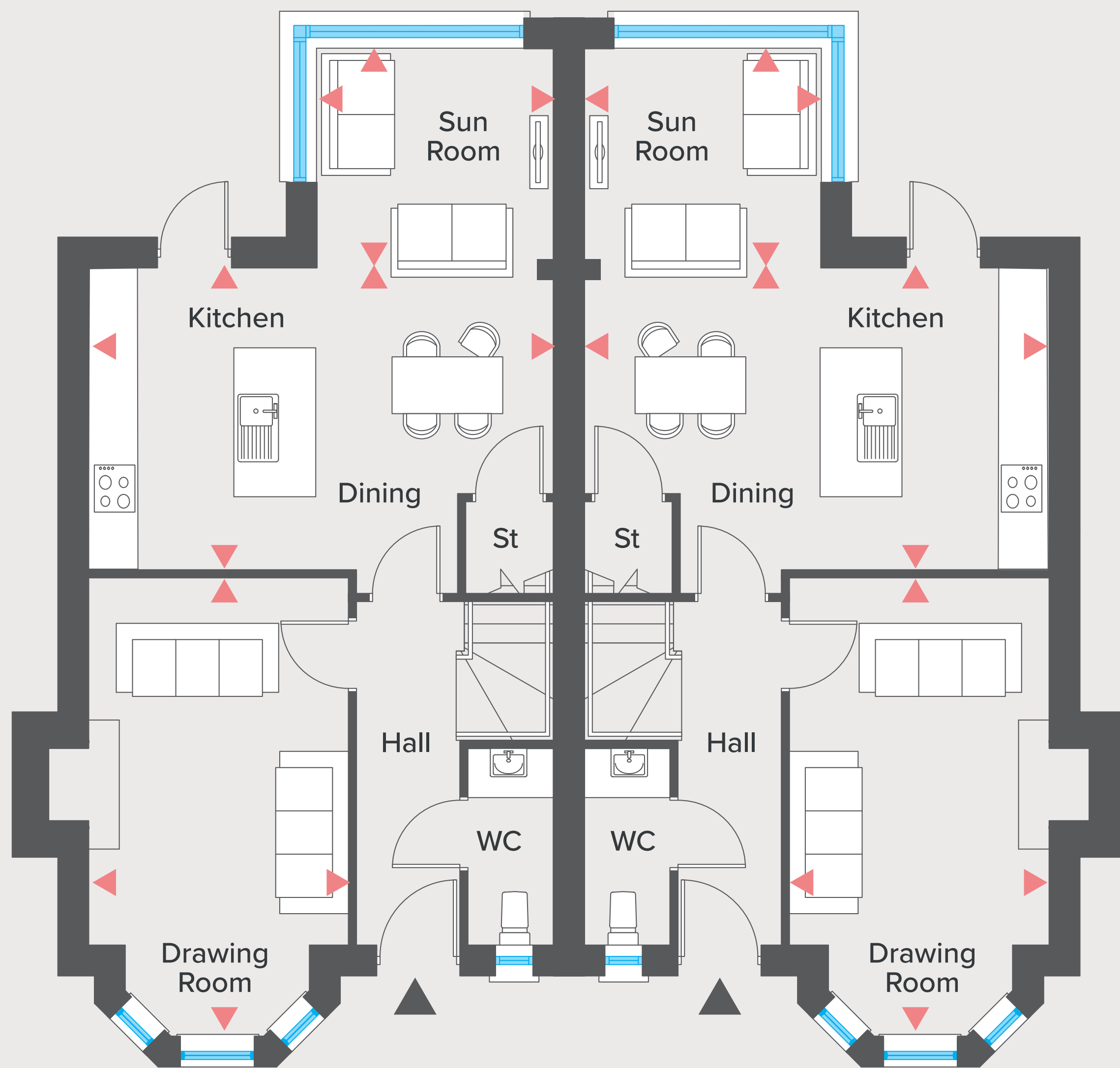

**GROUND FLOOR**

	Ft/Inch	Metres
Entrance Hall with separate WC		
Drawing Room inc bay	18'9" x 10'7"	5.73 x 3.22
Kitchen   Dining	19'0" x 12'2"	5.79 x 3.69
Sun Room	9'8" x 8'10"	2.98 x 2.70

**FIRST FLOOR**

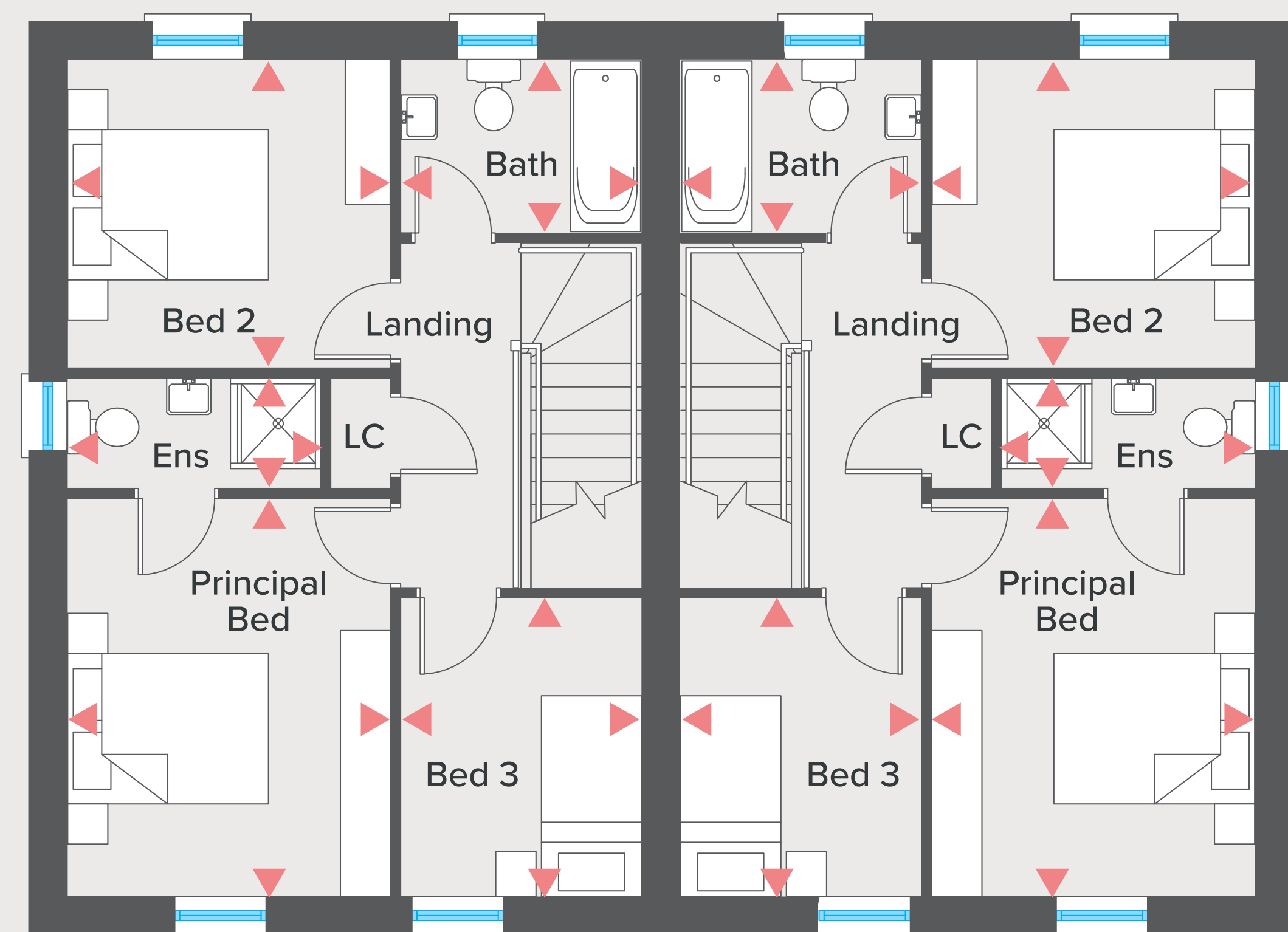

**FIRST FLOOR**

	Ft/Inch	Metres
Principal Bedroom max	13'1" x 10'8"	3.99 x 3.25
Ensuite	8'4" x 3'7"	2.55 x 1.10
Bedroom 2	10'8" x 10'2"	3.25 x 3.10
Bedroom 3	9'10" x 7'10"	3.00 x 2.44
Bathroom	7'10" x 5'9"	2.44 x 1.76

# The Kerr

(BH6) Site nos. 1, 2