



6 Carnvue Crescent

Carmoney, NEWTOWNABBEY, BT36 6NH

Detached Extended Family Bungalow.
2 Bedrooms, 3+ Receptions.
Oil-Fired Central Heating.
Detached Matching Garage.

A Barton Company is pleased to present FOR SALE, this attractive, spacious, detached and extended family bungalow in the convenient yet discrete 'Carnvue' area, just off the Carmoney Road in the heart of Carmoney village.

Well-maintained, with beautiful gardens and with space to grow, this is the ideal home for the growing family or the retiring couple. Register your interest for a viewing today!

For Sale

Offers Around £159,950

Viewing by appointment only through agents.

6 Carnvue Crescent

Carnmoney, NEWTOWNABBEY, BT36 6NH

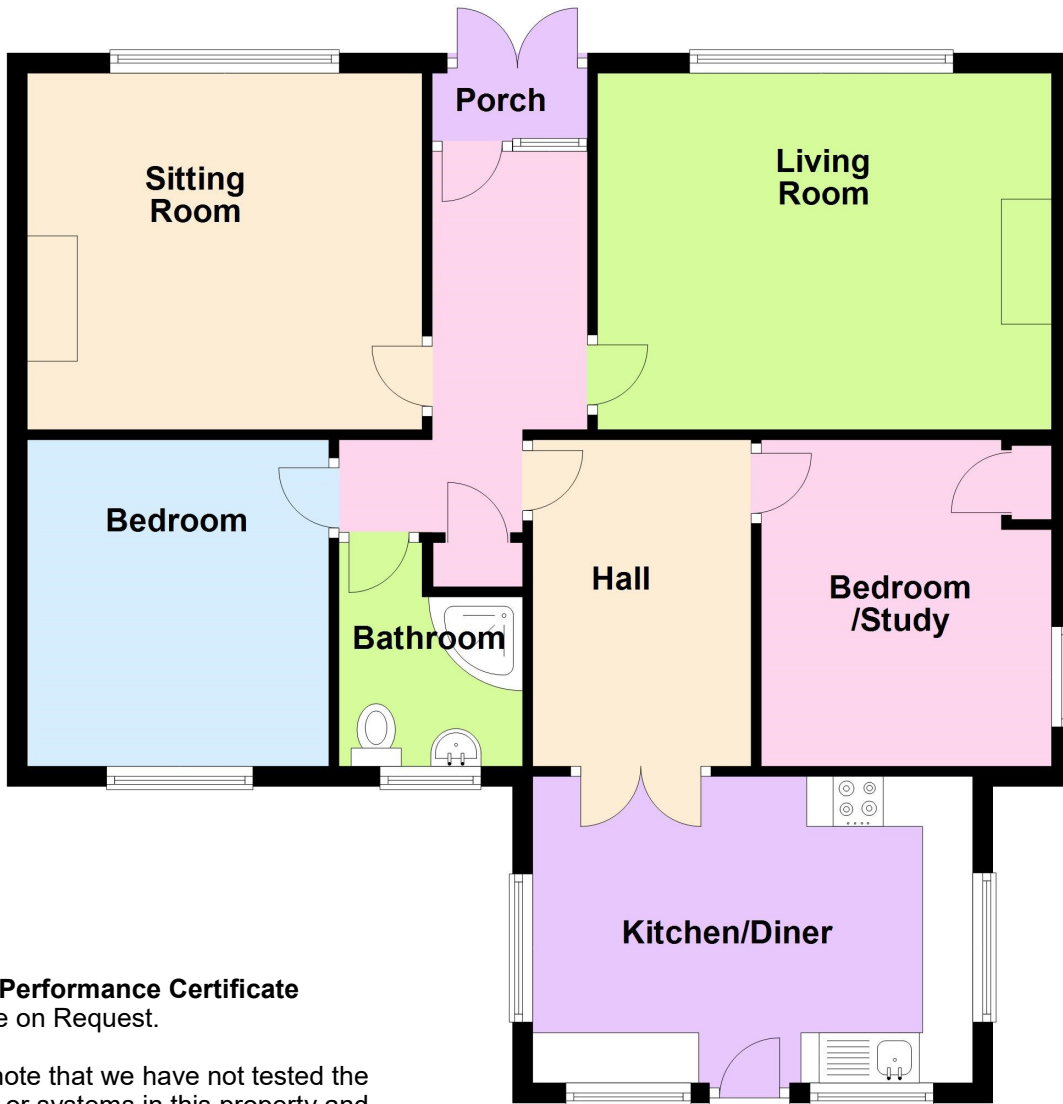

Energy Performance Certificate

Available on Request.

Please note that we have not tested the services or systems in this property and purchasers should make / commission their own inspections if they feel it is necessary.

All particulars presented are for guidance only and should not be construed as any part of an offer or contract.

Score	Energy rating	Current	Potential
92+	A		
81-91	B		
69-80	C		
55-68	D	57 D	68 D
39-54	E		
21-38	F		
1-20	G		

- Two Bedroom, Extended Family Bungalow.
- Oil-Fired Central Heating.
- Modern Fitted Kitchen.
- Modern Fitted Shower Room.
- uPVC framed, double glazed windows throughout.
- uPVC external front and rear doors.
- uPVC fascias, soffits and guttering.
- Security alarm system.
- Substantial, Mature Gardens.
- Greenhouse.
- Large Concrete Driveway.
- Detached Matching Garage.
- No chain.

6 Carnvue Crescent

Carnmoney, NEWTOWNABBEY, BT36 6NH

Accommodation Comprises:

Ground Floor

Entrance Porch

uPVC framed, double glazed, double French entrance doors.

Entrance Hall

uPVC framed, double glazed, entrance door. Carpeted. Feature Wall lighting. Double Radiator. Electric consumer unit cupboard. Cloaks cupboard.

Living Room

4.54 x 3.33m (14'11" x 10'11") max.

Carpeted. Wood burner inside fireplace with slate tiled hearth. Large scenic window. Large Double Radiator. Centre feature light.

Sitting Room

3.94 x 3.55m (12'11" x 11'8") max.

Carpeted. Tiled fireplace surround, mantelpiece and hearth. Double radiator. Centre feature light.

Master Bedroom

3.25 x 3.01m (10'8" x 9'11")

Carpeted. Double Radiator. Centre pendant light.

Shower Room

2.14 x 1.86m (7'0" x 6'1") max.

Three-piece, white, bathroom suite comprising: Corner glazed shower cubical with thermostatic shower unit and accessibility features, Pedestal Wash Hand Basin and Low-Flush, Push-Button W.C. Fully tiled walls and floors. Chromed Towel Radiator. Clad ceiling. Recessed Spot lighting.

Rear Hall / Family Room / Dining Room

3.26 x 2.18m (10'8" x 7'2")

Carpeted. Feature centre light. Radiator. Double French glazed panel doors to Kitchen.



6 Carnvue Crescent

Carnmoney, NEWTOWNABBEY, BT36 6NH

Kitchen / Diner

4.28 x 3.10m (14'1" x 10'2")

A 'walnut' country style kitchen suite comprising floor and eye level units and contrasting Formica worksurfaces. Space for freestanding electric 600 mm cooker. Concealed extractor unit. Space, power and plumbing for washing machine. Housing for tall fridge/freezer. Stainless steel sink and drainer with matching mixer taps. Part tiled walls. Vinyl flooring. LED strip lighting. uPVC framed, double glazed rear door.



Bedroom II / Study

3.26 x 2.80m (10'8" x 9'2")

Carpeted. Hot Press with Hot Water cylinder and internal immersion heater. Centre Pendant light. Radiator.



First Floor

Floored **roof space** with light and power. Access via 'Slingsby'-type ladder.

Exterior

Boundary wall and wrought iron railings and double entrance gates to front.

Front gardens laid principally in lawn with small shrubs and attractive beddings.

Concrete laid, long **driveway** and paths.

Other boundaries in wooden fencing and hedges.

Fully enclosed **rear gardens** laid principally in lawns, with concrete flagged patios and paths. Fitted drying lines. Glass green house. Oil Tank.

Detached Matching Garage

With light and power. Roller electric garage door. uPVC framed side window. Hardwood glazed side entrance door.



For Sale

Offers Around £159,950

Viewing by appointment only through agents.