



47 Empire Drive, Belfast, BT12 6GQ

Price Guide £80,000

This mid terrace property is situated on one of the more popular streets in the Donegall Road area. The property comprises spacious living room, fitted kitchen, ground floor bathroom and three bedrooms. Further benefits with Gas fired central heating and partial PVC double glazing. This property would make an ideal home for the first time buyer or astute investor seeking a reliable rental income. Empire drive is convenient to the many social, recreational and retail amenities of South Belfast including the bustling Lisburn Road, Boucher Road and Belfast City Centre, as well as both the City and Royal Victoria Hospitals. Bus and rail routes are close by, as are arterial transport routes such as the motorway network. With similar properties all selling quickly early viewing is recommended.

- Mid-Terrace Property
- One Reception
- Ground Floor Bathroom Suite
- Partial PVC Double Glazed Windows
- Suitable For A Range Of Buyers
- Three Bedrooms
- Kitchen With Dining Area
- Gas Central Heating
- Convenient Location

Energy Efficiency Rating		Current	Potential
(92-100)	A		
(81-91)	B		
(69-80)	C		
(55-68)	D		
(39-54)	E		
(21-38)	F		
(1-20)	G		
Not energy efficient - higher running costs			
		64	69
Northern Ireland		EU Directive 2002/91/EC	

**THE ACCOMODATION COMPRISES
ON THE GROUND FLOOR**

ENTRANCE

PVC Front door.

LIVING ROOM 12'1" x 10'2" (3.7 x 3.1)



Laminate floor, electric fire, decorative ceiling rose and under stairs storage.

KITCHEN 13'1" x 8'2" (4.0 x 2.5)



Range of high and low level units, formica work surfaces, single drainer stainless steel sink unit, 4 ring electric hob with built in oven, extractor fan, plumbed for washing machine, part tiled walls and vinyl floor. Ideal gas boiler.

BATHROOM 6'2" x 4'3" (1.9 x 1.3)



White suite comprising panel bath with thermostatic shower over, basin with vanity unit, low flush w.c, fully pvc cladded walls and tile flooring. Built in storage.

ON THE FIRST FLOOR

BEDROOM ONE 13'1" x 8'10" (4.0 x 2.7)



Laminate flooring. Feature fireplace.

BEDROOM TWO 9'6" x 5'10" (2.9 x 1.8)



BEDROOM THREE 6'10" x 6'2" (2.1 x 1.9)



Laminate flooring.

OUTSIDE

Large front garden with enclosed yard to rear.

Floor Plan

GROUND FLOOR

1ST FLOOR

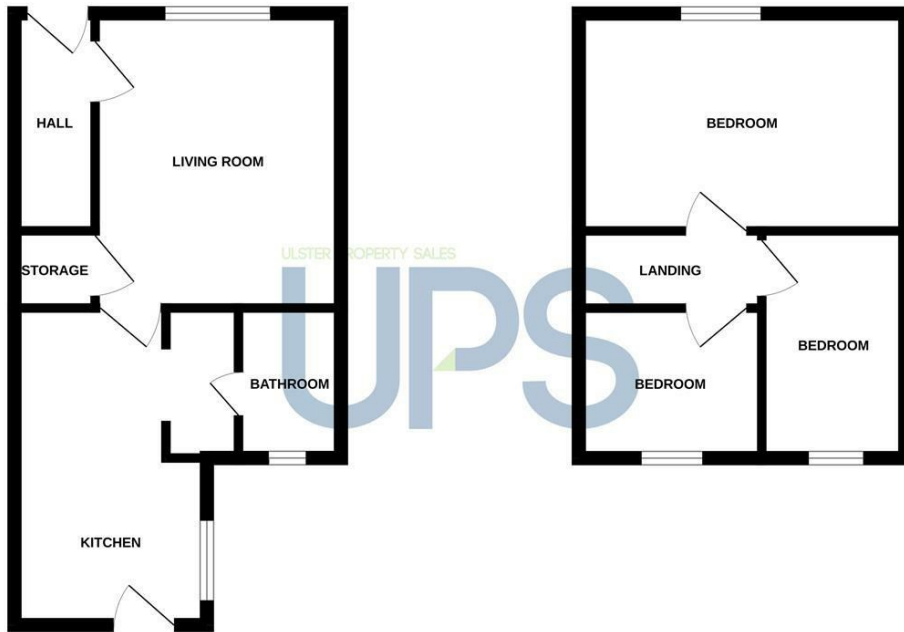

Whilst every attempt has been made to ensure the accuracy of the floorplan contained here, measurements of doors, windows, rooms and any other items are approximate and no responsibility is taken for any error, omission or mis-statement. This plan is for illustrative purposes only and should be used as such by any prospective purchaser. The services, systems and appliances shown have not been tested and no guarantee, as to their operability or efficiency can be given.
Made with Metropix ©2024

Area Map

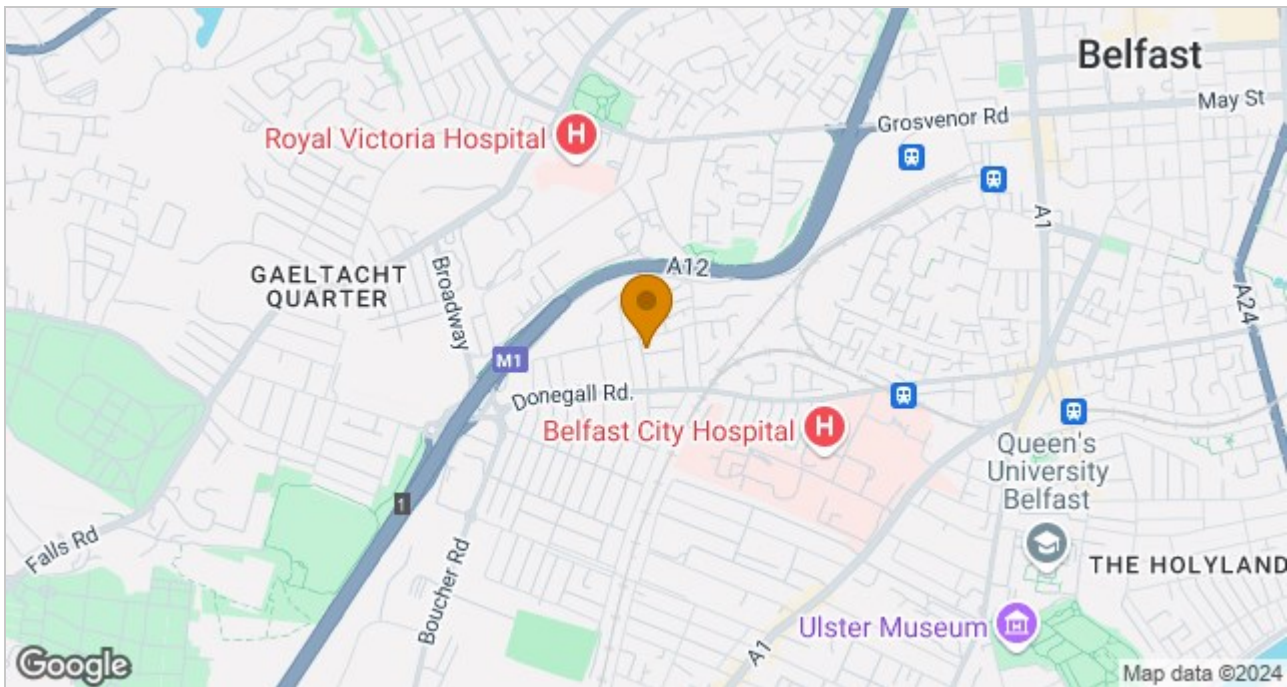

These particulars, whilst believed to be accurate are set out as a general outline only for guidance and do not constitute any part of an offer or contract. Intending purchasers should not rely on them as statements of representation of fact, but must satisfy themselves by inspection or otherwise as to their accuracy. No person in this firm's employment has the authority to make or give any representation or warranty in respect of the property.

ULSTERPROPERTYSALES.CO.UK

ANDERSONSTOWN
028 9060 5200
BALLYHACKAMORE
028 9047 1515
BALLYMENA
028 2565 7700

BALLYNAHINCH
028 9756 1155
BANGOR
028 9127 1185
CARRICKFERGUS
028 9336 5986

CAUSEWAY COAST
0800 644 4432
CAVEHILL
028 9072 9270
DOWNPATRICK
028 4461 4101

FORETSIDE
028 9064 1264
GLENGORMLEY
028 9083 3295
MALONE
028 9066 1929

NEWTOWNARDS
028 9181 1444
RENTAL DIVISION
028 9070 1000



John Thompson trading under licence as Ulster Property Sales (Downpatrick)
©Ulster Property Sales is a Registered Trademark