



12 MANOR COURT

Bangor BT20 3LQ

- 3 Bedrooms
- Lounge / Dining Area
- uPVC Double Glazing
- Phoenix Gas Heating System
- White Kitchen
- White Shower Room
- Cul De Sac
- No Onward Chain

Energy Efficiency Rating		Current	Potential
<i>Very energy efficient - lower running costs</i>			
(92 plus) A			
(81-91) B			
(69-80) C		70	71
(55-68) D			
(39-54) E			
(21-38) F			
(1-20) G			
<i>Not energy efficient - higher running costs</i>			
Northern Ireland		EU Directive 2002/91/EC	

Offers Over £120,000

12 Manor Court

, Bangor, BT20 3LQ



ACCOMMODATION

PVC entrance door into ...

ENTRANCE PORCH

6 Pane half glazed door into ...

LOUNGE

23'1" x 15'8" narrowing to 8'8"
(7.04m x 4.78m narrowing to
2.64m)

Open fireplace with tiled surround
and hearth, mahogany
mantelpiece. Built-in cloaks
cupboard.

KITCHEN

10'4" x 7'3" (3.15m x 2.21m)

Range of high and low level
cupboards and drawers with roll

edge work surfaces. Built-in
ceramic 4 ring hob and oven
under. Built-in extractor fan.

Single drainer stainless steel sink
unit with mixer taps. Plumbed for
washing machine.

STAIRS TO LANDING

Built-in storage cupboard.

BEDROOM 1

11'0" x 8'9" (3.35m x 2.67m)

BEDROOM 2

11'9" x 8'9" at widest pt (3.58m x
2.67m at widest pt)

Laminated wood floor.

BEDROOM 3

12'9" x 7'0" (3.89m x 2.13m)

Built-in wardrobe.

SHOWER ROOM

Comprising: Corner shower with
Unitchrome Triton Body jet
shower. Vanity unit with inset
wash hand basin and mixer taps.
W.C. PVC panelled walls. Ceramic
tiled floor. Pine ceiling.

OUTSIDE

FRONT

Garden in lawn.

REAR

Enclosed garden in lawn.

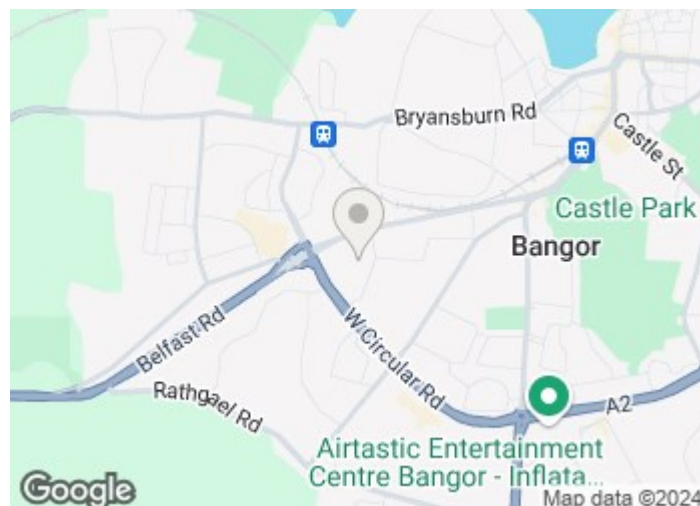

Directions



Floor Plan



12, Manor Court, BANGOR, BT20 3LQ

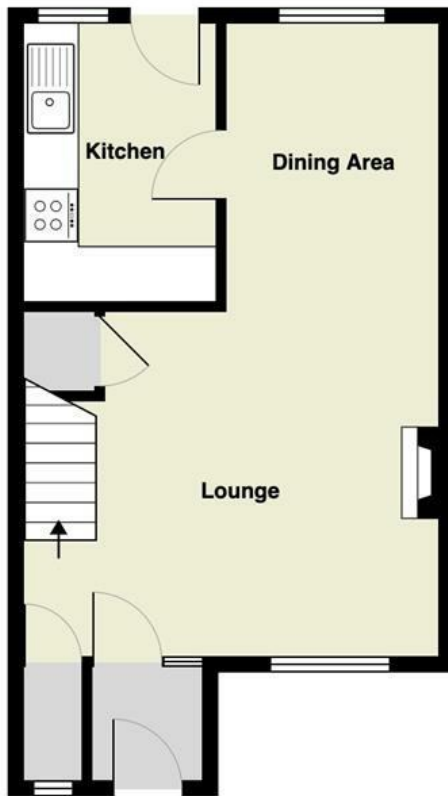

Ground Floor

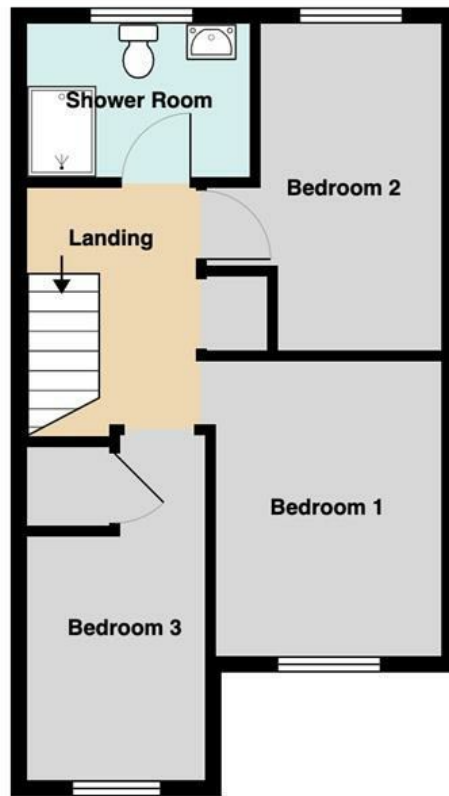

First Floor

Total Area: 68.2 m² ... 734 ft²

All measurements are approximate and for display purposes only

These particulars, whilst believed to be accurate are set out as a general outline only for guidance and do not constitute any part of an offer or contract. Intending purchasers should not rely on them as statements of representation of fact, but must satisfy themselves by inspection or otherwise as to their accuracy. No person in this firm's employment has the authority to make or give any representation or warranty in respect of the property.

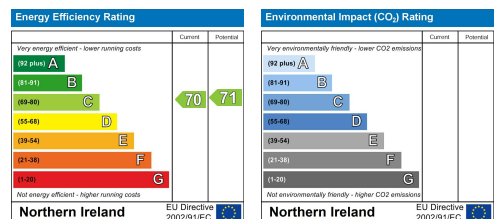

ULSTERPROPERTYSALES.CO.UK

- | | | | | |
|---------------------------------|--------------------------------|---------------------------------|------------------------------|----------------------------------|
| ANDERSONSTOWN
028 9060 5200 | BALLYNAHINCH
028 9756 1155 | CAUSEWAY COAST
0800 644 4432 | FORESTSIDE
028 9064 1264 | NEWTOWNARDS
028 9181 1444 |
| BALLYHACKAMORE
028 9047 1515 | BANGOR
028 9127 1185 | CAVEHILL
028 9072 9270 | GLENGORMLEY
028 9083 3295 | RENTAL DIVISION
028 9070 1000 |
| BALLYMENA
028 2565 7700 | CARRICKFERGUS
028 9336 5986 | DOWNPATRICK
028 4461 4101 | MALONE
028 9066 1929 | |



Jonathan Collins trading under licence as Ulster Property Sales (North Down)
©Ulster Property Sales is a Registered Trademark