



31 Nutts Corner Road, Nutts Corner, Crumlin

OIRO £375,000 Freehold

An excellent opportunity to purchase a detached bungalow on a generous, level site backing onto the picturesque Camlin River, pleasantly situated close to Nutts Corner, making for great accessibility to Belfast, Lisburn, Antrim, Moira and the International airport.

Detached bungalow | 4 Receptions | Kitchen/dining | 3 Bedrooms | Utility room | Garage | Extensive site | Hardwood double glazing | Oil fired central heating | No Onward Chain |

028 9266 3396

admin@falloonestateagents.com



An excellent opportunity to purchase a detached bungalow on a generous, level site backing onto the picturesque Camlin River, pleasantly situated close to Nutts Corner, making for great accessibility to Belfast, Lisburn, Antrim, Moira and the International airport. Crumlin village with local schools, shops and amenities is also just a short drive away.

This excellent family home offers the perfect blend of privacy and maturity and further benefits from the potential to develop the site further either by way of extension or an infill dwelling, subject to any necessary consents. Purchasers should note that Outline Planning Permission was granted on 5th December 2019 for a detached dwelling in the garden. This has now lapsed but may be renewable.

Externally there are large gardens in lawn to the front and side, a large driveway and tarmac parking area with detached garage. To the rear is a private, gated concreted area offering excellent scope for those needing extra parking at home and a further lawned garden with choice of outside seating areas, taking in the charm of the river and views to the rear. It has a southerly aspect, well orientated for afternoon and evening sun.

Inside the property is presented to a very impressive standard, and is ideal for modern family living. This home has double glazed windows and oil fired central heating adding to the comfort and economy on offer. Fast fibre broadband is connected and there is an EV charging point installed in the garage.

The accommodation comprises entrance hall, lounge, luxury open plan kitchen / dining area with arch to a formal dining room, family room double doors to the large conservatory, 3 double bedrooms, family bathroom, utility room and separate cloakroom toilet.

The excellent indoor and outdoor space future proofs this property to ensure it can adapt to meet the needs of purchasers for a long time.

For further information and viewing information on this beautiful country house, please contact us on 028 9266 3396.

Tenure: Freehold

Parking options: Off Street, Garage

Garden details: Private Garden

GROUND FLOOR :

Entrance hall

Hardwood door with glazed side panel. Tiled floor. Single panelled radiator.

Lounge

w: 3.67m x l: 5.01m (w: 12' x l: 16' 5")

Feature marble fireplace with granite hearth. Coal effect gas fire. Laminate flooring. Cornice. 2 double panelled radiators.

Dining Room

w: 3.82m x l: 4.41m (w: 12' 6" x l: 14' 6")

Feature cast iron fireplace and slate hearth. Coal effect gas fire. Tiled floor. Double panelled radiator.

Arch to kitchen/dining.

Family room

w: 2.98m x l: 3.59m (w: 9' 9" x l: 11' 9")

Glazed door from hallway. Tiled floor. Double panelled radiator. Glazed double doors to conservatory.

Conservatory

w: 3.95m x l: 5.5m (w: 13' x l: 18' 1")



PVC double glazed conservatory. Tiled floor. 2 double panelled radiators. Doors to both sides.

Kitchen/dining

w: 4m x l: 4.68m (w: 13' 1" x l: 15' 4")

Excellent range of high and low level units with oak doors and black granite worktops. Inset 1.5 bowl stainless steel sink unit, mixer tap. 'Rangemaster' range style cooker with extractor over. Integrated dishwasher. Integrated 'Neff' microwave. Space for american style fridge/freezer, wine rack over. Splashback wall tiling. Tiled floor

Utility Room

w: 1.65m x l: 1.72m (w: 5' 5" x l: 5' 8")

Range of oak units. Plumbed for washing machine. Tiled floor.

WC

Low flush WC. Pedestal wash hand basin, mixer tap. Single panelled radiator. Extractor fan.

Bedroom 1

w: 3.11m x l: 4.16m (w: 10' 2" x l: 13' 8")

Laminate flooring. Double panelled radiator.

Bedroom 2

w: 2.95m x l: 4.21m (w: 9' 8" x l: 13' 10")

Laminate flooring. Double panelled radiator.

Bedroom 3

w: 2.95m x l: 4.32m (w: 9' 8" x l: 14' 2")

Double panelled radiator.

Bathroom

w: 2.45m x l: 2.96m (w: 8' x l: 9' 9")

Corner bath with mixer tap and shower fitting. Shower enclosure with 'Aqualisa' mixer shower. Pedestal wash hand basin. Low flush WC. Fully tiled walls. Tiled floor. Extractor fan. Shaver point. Double panelled radiator.

Separate hotpress with copper cylinder and immersion heater.

Outside

Front garden laid in lawn. Parking with tarmac finish.

Enclosed rear with extensive concreted 'yard' area. Lawned area.

Oil storage tank. Hot and cold outside taps.

Backs on to small river, 'Camlin River', with steps providing access.

Detached Garage

w: 3.67m x l: 5.66m (w: 12' x l: 18' 7")

Roller door. PVC pedestrian door and window. Light and power. EV charging point. Oil fired boiler.

Tenure

We have been advised the tenure for this property is freehold, we recommend the purchaser and their solicitor verify the details.

Rates payable

Details from the LPSNI website - capital value of £180,000 with rates payable for 2024/25 of £1644.48



GROUND FLOOR

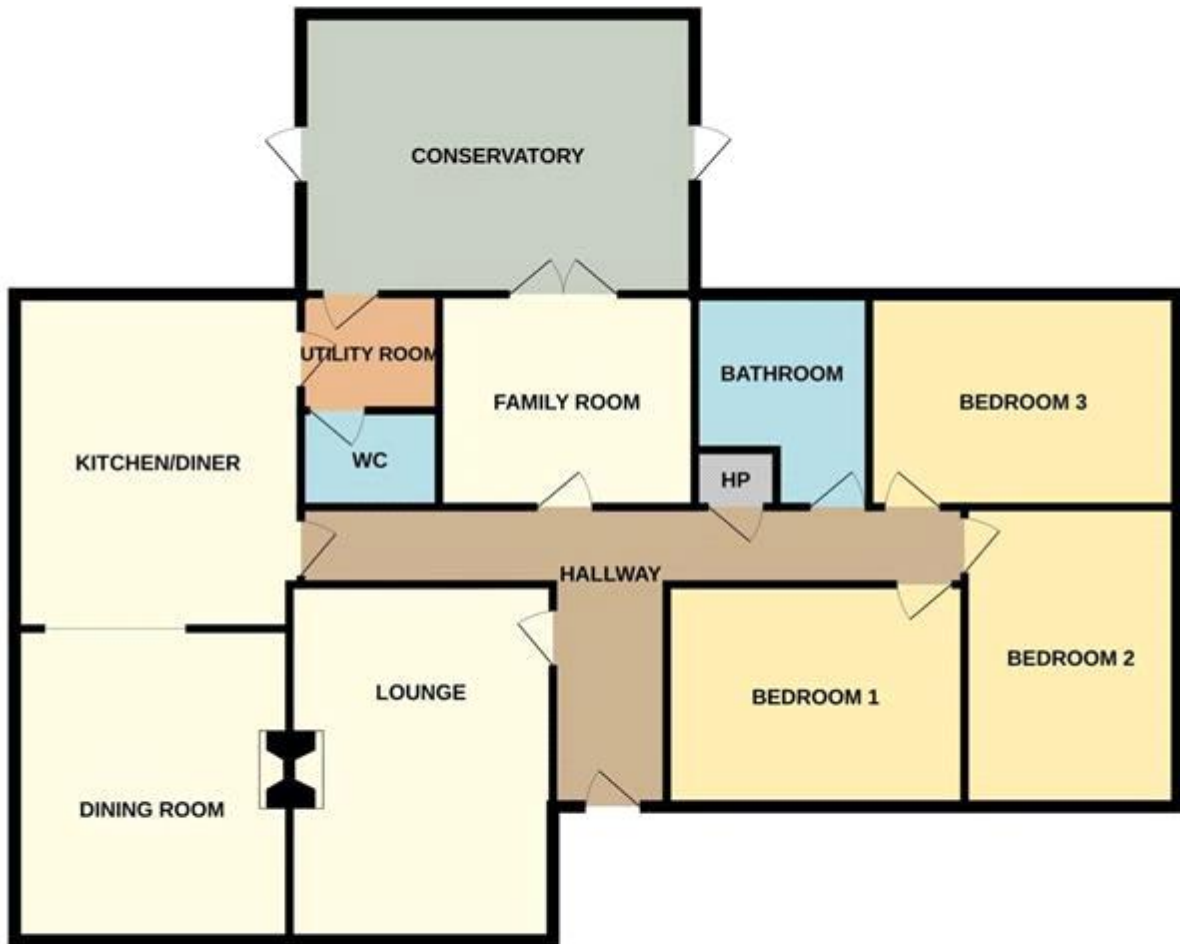

Whilst every attempt has been made to ensure the accuracy of the floorplan contained here, measurements of doors, windows, rooms and any other items are approximate and no responsibility is taken for any error, omission or mis-statement. This plan is for illustrative purposes only and should be used as such by any prospective purchaser. The services, systems and appliances shown have not been tested and no guarantee as to their operability or efficiency can be given.
Made with Metropix ©2024

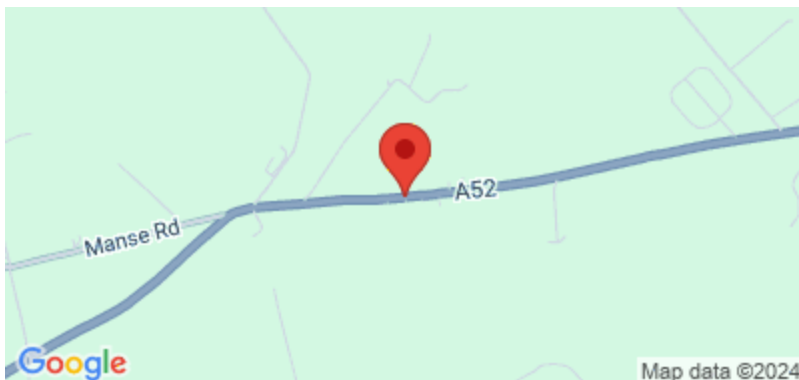

Energy Efficiency Rating		
	Current	Potential
Very energy efficient - lower running costs		
(92-100) A		
(81-91) B		
(69-80) C		
(55-68) D		
(39-54) E	47	51
(21-38) F		
(1-20) G		
Not energy efficient - higher running costs		
Northern Ireland	EU Directive 2002/91/EC	

The energy efficiency rating is a measure of the overall efficiency of a home. The higher the rating the more energy efficient the home is and the lower the fuel bills will be.

Whilst every effort is made to ensure the accuracy of these details, it should be noted that the measurements are approximate only. Floorplans are for representation purposes only and prepared according to the RICS Code of Measuring Practice by our floorplan provider. Therefore, the layout of doors, windows and rooms are approximate and should be regarded as such by any prospective purchaser. Any internal photographs are intended as a guide only and it should not be assumed that any of the furniture/fittings are included in any sale. Where shown, details of lease, ground rent and service charge are provided by the vendor and their accuracy cannot be guaranteed, as the information may not have been verified and further checks should be made either through your solicitor/conveyance. Where appliances, including central heating, are mentioned, it cannot be assumed that they are in working order, as they have not been tested. Please also note that wiring, plumbing and drains have not been checked.