

Highgrove, Ravarnet, Lisburn,  
County Down, BT27

**Asking Price: £184,950**  
**Leasehold**

 **Reeds Rains**

[reedsrains.co.uk](https://www.reedsrains.co.uk)

Highgrove, Ravarnet, Lisburn, County Down, BT27

Asking Price: £184,950 Leasehold

Council Tax Band:

EPC Rating: E

A most impressive and highly presented semi-detached family home pleasantly situated in this much admired and popular cul-de-sac location with in Ravarnet, close to Sprucefield Shopping Centre, Lisburn and Hillsborough alike.

Enclosed and private, part lawns and paved patio, oil fired boiler and oil storage tank.

The Reeds Rains branches at 350 Upper Newtownards Road, Ballyhackamore, Belfast, N Ireland BT4 3EX, 18 Main Street, Bangor, Co Down, N Ireland BT20 5AG, Somerset House, 240-242 Ormeau Road, Belfast, Co Antrim, N Ireland BT7 2FZ, 10 High Street, Carrickfergus, Co Antrim, N Ireland BT38 7AF, 8/8A Carrmoney Road, Glengormley, County Antrim, N Ireland BT36 6HN, 14/16 Market Street, Lisburn, County Antrim, N Ireland BT28 1AB and 2 Frances Street, Newtownards, County Down, N Ireland BT23 4JA are operated by Favscio NI Limited which is independently owned and operated under a Licence from Reeds Rains Limited.

### Entrance Hall

### Living Room

12'1" x 12'1" (3.68m x 3.68m)

Feature fireplace, wooden flooring, open plan to kitchen

### Kitchen/ Dining Room

18'6" x 10'9" (5.64m x 3.28m)

Exceptional modern fitted range of high and low level units, laminate work tops, single drainer stainless steel sink unit, ceramic hob and electric oven, integrated dishwasher/ fridge/ freezer, laminate flooring, open to dining room.

### Landing

### Bedroom 1

12'2" x 9'7" (3.7m x 2.92m)

### Bedroom 2

11'4" x 10'9" (3.45m x 3.28m)

Built-in robes

### Bedroom 3

8'8" x 8'6" (2.64m x 2.6m)

### Bathroom

White suite comprising panelled bath, wash hand basin, low level WC.

### Games Room/ Office/ Summer House

11'2" x 7'3" (3.4m x 2.2m)

Laminate flooring. Light and power.

### Rear Gardens

We may refer you to recommended providers of ancillary services such as Conveyancing, Mortgages, Insurance and Surveying. We may receive a referral fee for recommending their services. You are not under any obligation to use the services of the recommended provider, which may also be an associated company of Reeds Rains.

All Measurements  
All Measurements are Approximate.

Laser Tape Clause  
All measurements have been taken using a laser tape measure and therefore, may be subject to a small margin of error.

Floorplan Clause  
Measurements are approximate. Not to Scale. For illustrative purposes only.

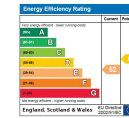

For full EPC please contact the branch.

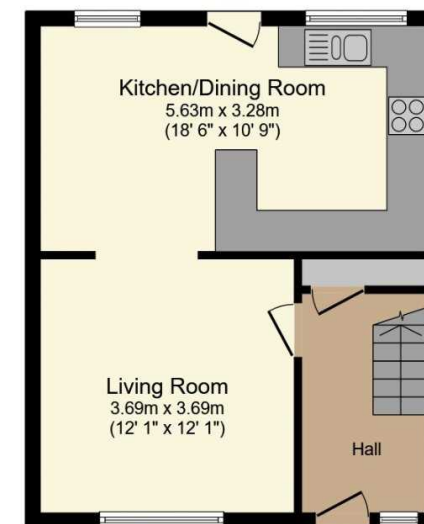

Ground Floor

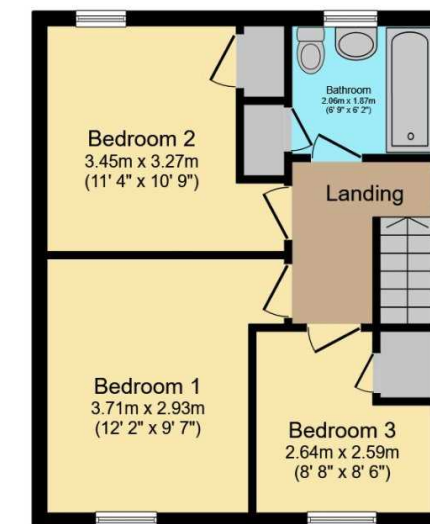

First Floor

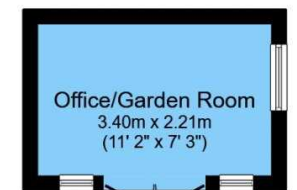

Outbuilding

Total floor area 87.1 m<sup>2</sup> (938 sq.ft.) approx

This floor plan is for illustrative purposes only. It is not drawn to scale. Any measurements, floor areas (including any total floor area), openings and orientation are approximate. No details are guaranteed, they cannot be relied upon for any purpose and they do not form part of any agreement. No liability is taken for any error, omission or misstatement. A party must rely upon its own inspection(s).  
Powered by [www.focalagent.com](http://www.focalagent.com)

Other important information which you will need to know about this property can be found at [reedsrains.co.uk](http://reedsrains.co.uk)