

Ballantine Gardens, Lisburn,
County Down, BT27

 Reeds Rains

Asking Price: £279,950
Freehold

reedsrains.co.uk

Ballantine Gardens, Lisburn, County Down, BT27

Asking Price: £279,950 Freehold

Council Tax Band:

EPC Rating: C

Charming and characterful throughout, No. 142 is a delightful Cottage Style End Townhouse and is exceptionally presented within, beautifully decorated by the current owners, giving a luxurious feeling, as soon as you enter the front door.

10'5" x 8'8" (3.18m x 2.64m)

Bathroom

White deluxe suite comprising roll top bath, wash hand basin, low level WC, tiled flooring.

Car Parking/ Driveway

To side. car parking space.

Enclosed Rear Gardens

Enclosed and secluded in part lawns, paved patio.

Reception Hall

Laminate flooring.

Living Room

17'9" x 12'4" (5.4m x 3.76m)

Feature fireplace with gas fire inset

Kitchen/ Dining

23'5" x 10'4" (7.14m x 3.15m)

Exceptional fitted range of high and low level units, granite work tops, Belfast sink unit, built-in rangemaster cooker, gas hob and electric oven, feature island unit, integrated fridge/freezer and dishwasher, wall and floor tiling.

The Reeds Rains branches at 350 Upper Newtownards Road, Ballyhackamore, Belfast, N Ireland BT4 3EX, 18 Main Street, Bangor, Co Down, N Ireland BT20 5AG, Somerset House, 240-242 Ormeau Road, Belfast, Co Antrim, N Ireland BT7 2FZ, 10 High Street, Carrickfergus, Co Antrim, N Ireland BT38 7AF, 8/8A Carnmoney Road, Glengormley, County Antrim, N Ireland BT36 6HN, 14/16 Market Street, Lisburn, County Antrim, N Ireland BT28 1AB and 2 Frances Street, Newtownards, County Down, N Ireland BT23 4JA are operated by Favscio NI Limited which is independently owned and operated under a Licence from Reeds Rains Limited.

Utility Room

6'11" x 6'10" (2.1m x 2.08m)

Range of units, plumbed for washing machine.

All Measurements
All Measurements are Approximate.

WC

Low level WC, wash hand basin

Laser Tape Clause
All measurements have been taken using a laser tape measure and therefore, may be subject to a small margin of error.

Landing

Floorplan Clause
Measurements are approximate. Not to Scale. For illustrative purposes only.

Master Bedroom

12'1" x 11'10" (3.68m x 3.6m)

En-suite

Stunning recently installed shower cubicle with glazed screen, controlled shower unit, wash hand basin, low level WC, wall and floor tiling. Chrome towel rail, velux window.

Bedroom 2

14'6" x 10'5" (4.42m x 3.18m)

Bedroom 3

We may refer you to recommended providers of ancillary services such as Conveyancing, Mortgages, Insurance and Surveying. We may receive a referral fee for recommending their services. You are not under any obligation to use the services of the recommended provider, which may also be an associated company of Reeds Rains.

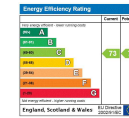

For full EPC please contact the branch.



Ground Floor

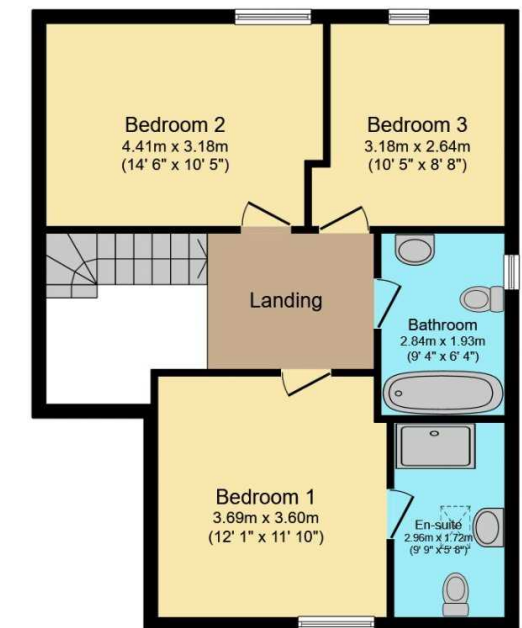

First Floor

Total floor area 121.7 m² (1,309 sq.ft.) approx

This floor plan is for illustrative purposes only. It is not drawn to scale. Any measurements, floor areas (including any total floor area), openings and orientation are approximate. No details are guaranteed, they cannot be relied upon for any purpose and they do not form part of any agreement. No liability is taken for any error, omission or misstatement. A party must rely upon its own inspection(s).

Powered by www.focalagent.com

Other important information which you will need to know about this property can be found at reedsrains.co.uk