

# Proposed Conversion and Reuse of Existing Buildings of Permanent Construction

25m West of 20 Birch Hill Road, Antrim  
 Co. Antrim, BT41 2QH  
 Dwg Scale 1:500

Date: June 2020  
 Client: Miss Nancy Montgomery

## PLANTING SCHEDULE

Areas of proposed planting to be of native species, oak, beech and birch mix

- Oak: 
- Beech: 
- Birch: 

To be carried out first planting season after occupation

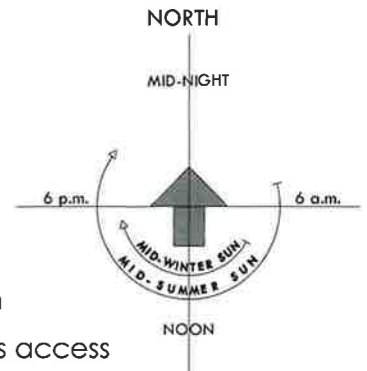

### Detailed Roads access

Layout to be in accordance w/ Diagram 2 (rear to form RS 1)

Visibility splays as indicated x = 2.4m y = 70m

The area w/in the visibility splay shall be cleared to provided a level surface no higher than 250mm above the level of the adjoining carriageway. New trees or shrubs should be planted at least 3m back from visibility splays

Gradient of the driveway does not exceed 8% over the first 5m outside the public road boundary, in accordance w/ guidance offered by DOE Roads

Driveway to be 5m for the first 10m from the public road,

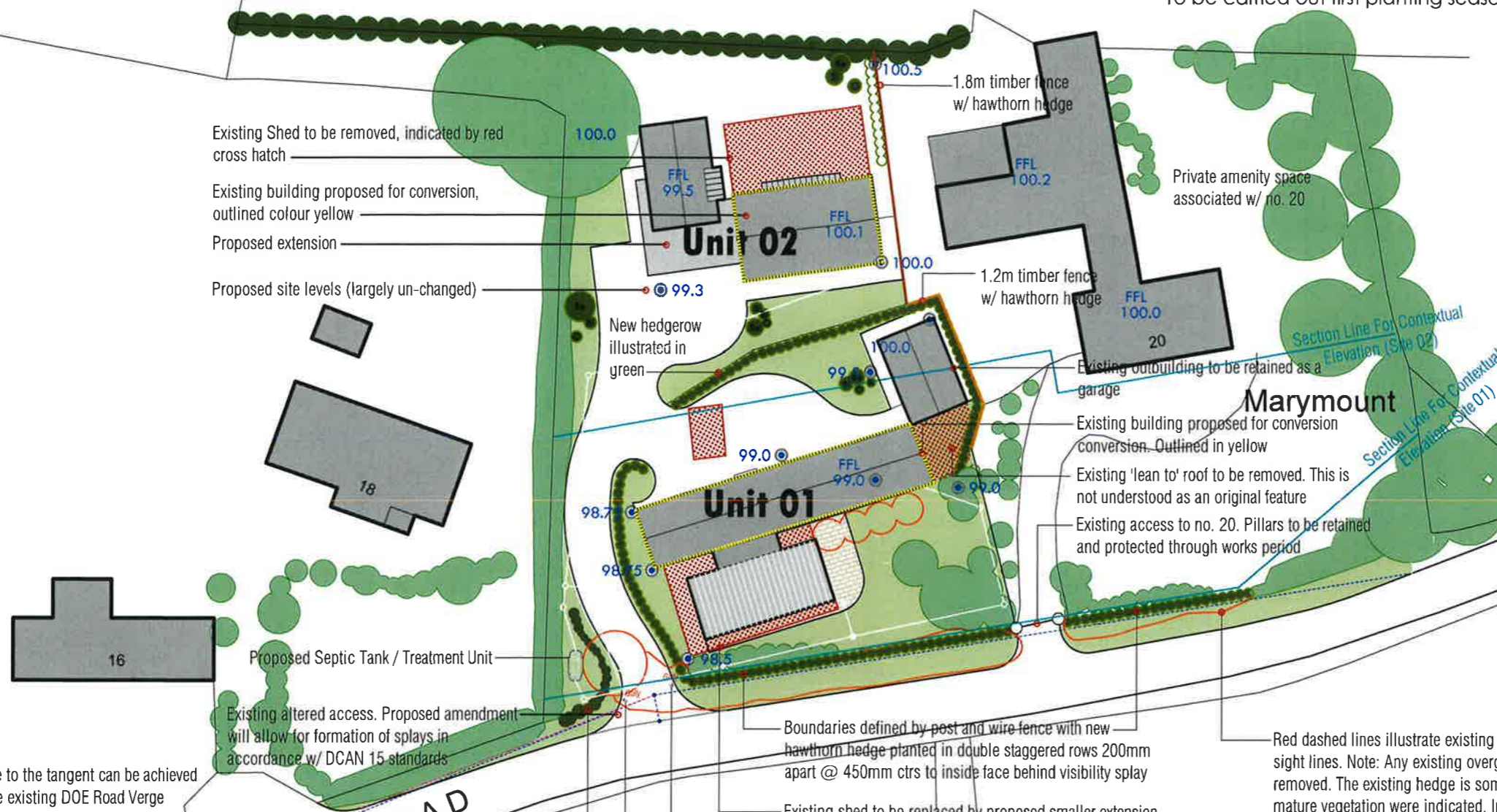

Drawing Number..... 06/3



Red dashed lines illustrate existing vegetation to be removed to facilitate proposed improved sight lines. Note: Any existing overgrown features located within this area should also be removed. The existing hedge is some metres deep. It will be possible to retain areas of existing mature vegetation were indicated. In addition it is proposed that new hawthorn hedge be provided behind the visibility splay. To be planted in double staggered rows, 300mm apart @ 450mm ctrs

Proposed new boundary hedging to be augmented with native species trees, to be planted as generally indicated

New boundaries formed w/ post and wire fence w/ beech hedge planted to inside face in double staggered row 300mm apart @ 450mm ctrs

Existing hedges and trees to boundary to be retained and supplement w/ new hedging and native species tree, as indicated

Planning Section RECEIVED 07 DEC 2020  
 File No.....

"This copy has been made by or with the authority of Antrim and Newtownabbey Borough Council pursuant to Section 47 of the Copyright Designs and Patent Act 1988. Unless the Act provides a relevant exception to copyright the copy must not be copied without the prior permission of the copyright owner"