

MARC FEGAN
BESPOKE ESTATE AGENT



33 Beechfield Lodge, Craigavon, BT67 0GA
Asking price £299,950

4 3 4

MARC
BESPOKE ES

Floor Plan

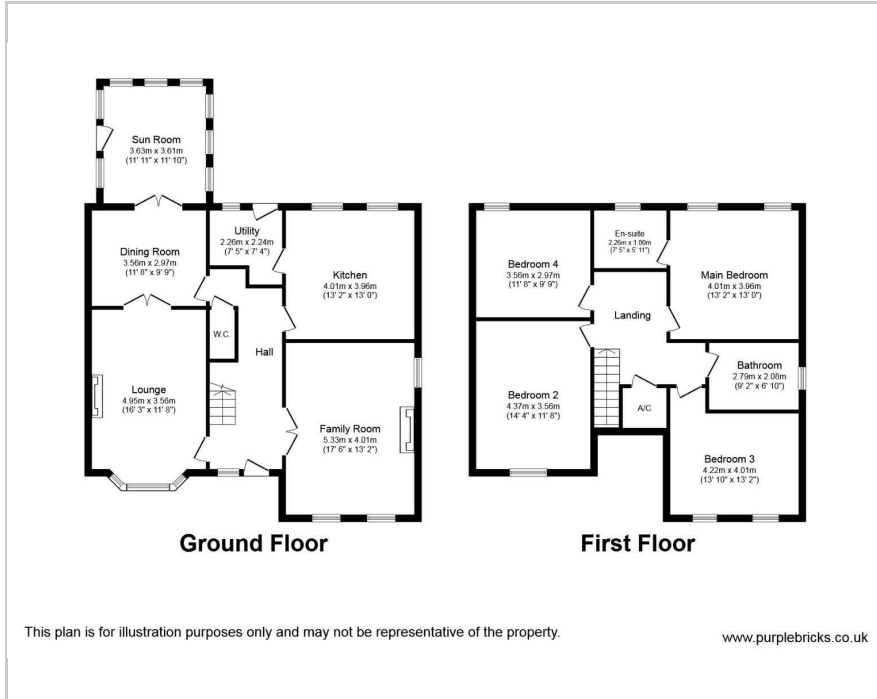

Area Map

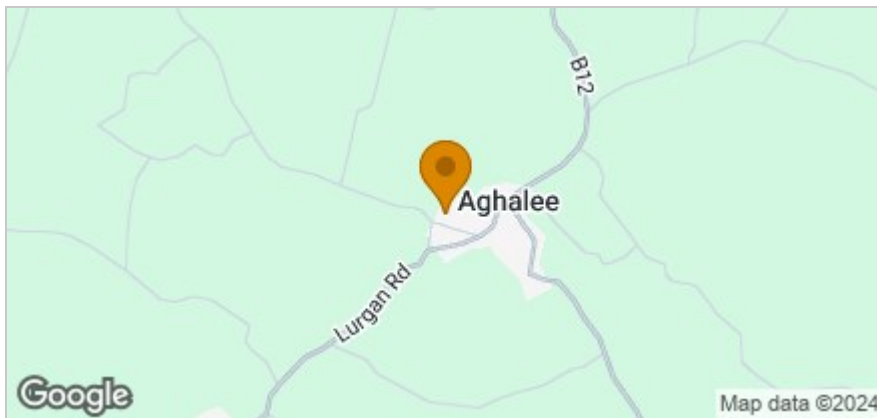

Accommodation

- Stunning Detached Family Home
- Glorious Corner Site With Picturesque Gardens
- Four Double Bedrooms - Master En-Suite
- Three Reception Rooms Plus Sun Room
- Fitted Kitchen & Utility Room
- Downstairs WC & Family Bathroom on 1st Floor
- Extremely Spacious & Well Presented Accommodation
- Detached Garage With Light & Power
- Quiet, Sought After Residential Development
- Oil Fired Central Heating & Double Glazed Windows



Viewing

Please contact our Marc Fegan Bespoke Estate Agent Office on 02838894608 if you wish to arrange a viewing appointment for this property or require further information.

Energy Efficiency Graph

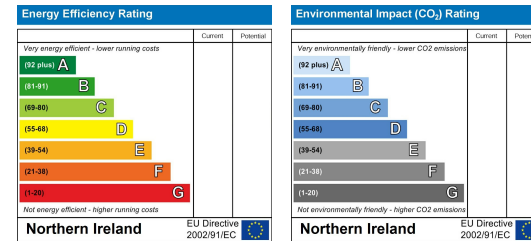

These particulars, whilst believed to be accurate are set out as a general outline only for guidance and do not constitute any part of an offer or contract. Intending purchasers should not rely on them as statements of representation of fact, but must satisfy themselves by inspection or otherwise as to their accuracy. No person in this firm's employment has the authority to make or give any representation or warranty in respect of the property.