



12 Drumcain Close, Milltown Road, Belfast, BT8 8HQ

Asking Price £125,000

Deceptively spacious, this semi detached bungalow, is ideally located with a cul de sac setting, close to many amenities, and for those who enjoys the outdoors, Shaw's Bridge and Belvoir Park forest are only a short distance from the property. The bungalow has 2 well proportioned bedrooms, both with built in robes, spacious lounge, fitted kitchen with an area to dine in, and a white bathroom. Outside there is shared off street parking to the rear, with a lawn garden area to the rear and a pleasant woodland aspect also to the front of the property. This is a chain free sale and one that will appeal to so many, given its attractive asking price, location and also the fact that bungalows are in high demand, but also in short supply.

- Semi detached bungalow
- Spacious lounge
- White bathroom suite
- Gardens to the front and to the rear
- Cul de sac position
- Two good size bedrooms, both with built in storage
- Kitchen / dining area
- Gas central heating / double glazed windows
- Off street parking (shared driveway)
- Chain free onward sale

Energy Efficiency Rating		Current	Potential
(92-100)	A		
(81-91)	B		
(69-80)	C		
(55-68)	D		
(39-54)	E		
(21-38)	F		
(1-20)	G		
Not energy efficient - higher running costs			
Northern Ireland		66	69
EU Directive 2002/91/EC			

The accommodation comprises

Pvc double glazed front door leading to the entrance hall.

Entrance hall



Laminate floor, built in storage, hot press, access to the roof space. light and insulated.

Lounge 14'4 x 10'4 (4.37m x 3.15m)



Laminate flooring.

Kitchen / dining 11'5 x 10'1 (3.48m x 3.07m)



Range of high and low level units, double drainer sink unit with mixer taps, formica work surfaces, part tiled walls, cooker space, fridge freezer space, plumbed for washing machine, gas boiler.

Additional kitchen image

Rear hallway



Ideal storage area.

Bedroom 1 10'9 x 10'1 (3.28m x 3.07m)



Laminate flooring, Built in storage.

Bedroom 2 10'9 x 9'8 (3.28m x 2.95m)



Laminate flooring, Built in storage.

Bathroom 8'3 x 5'2 (2.51m x 1.57m)



White suite comprising panelled bath, low flush w/c, wash hand basin with storage below, Shower force 1500xt shower, part tiled walls, extractor fan.

Outside

Front gardens



Low maintenance gardens to the front.

Rear gardens

Gardens to the rear laid in lawn with neat flower beds. outside tap.

Parking



Shared driveway to the rear with off street parking.

Floor Plan

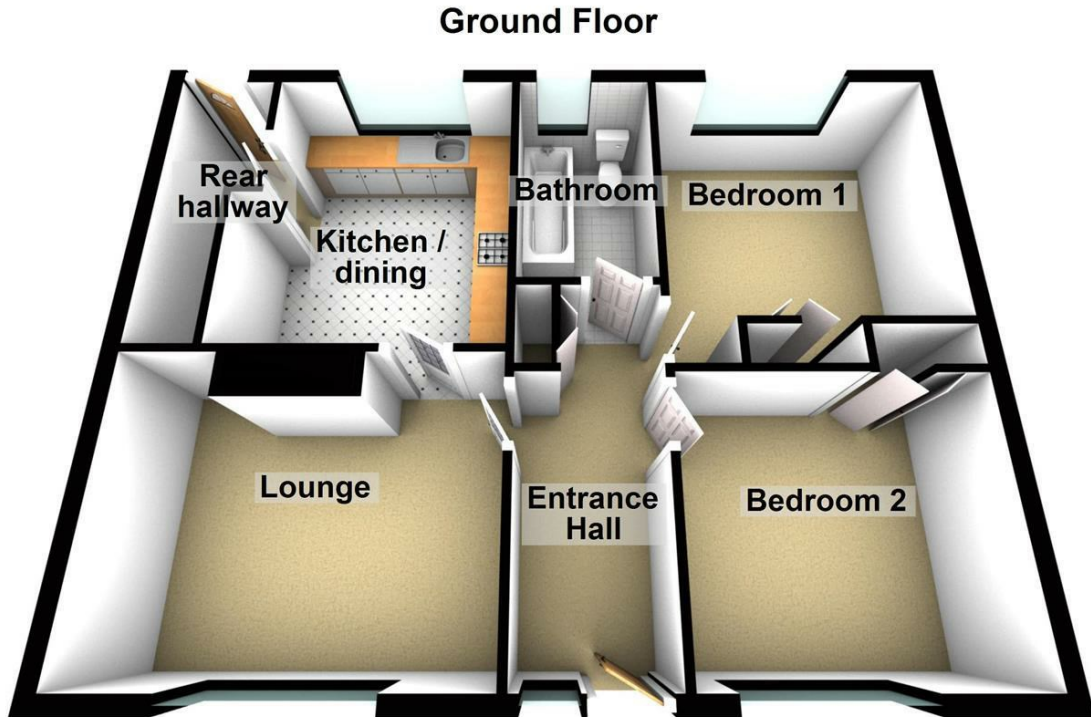

Please note this floor plan is for marketing purposes only, is not to scale and is to be used as a guide only. No liability is accepted in respect of any consequential loss arising from the use of this plan. Plan produced using PlanUp.

Area Map

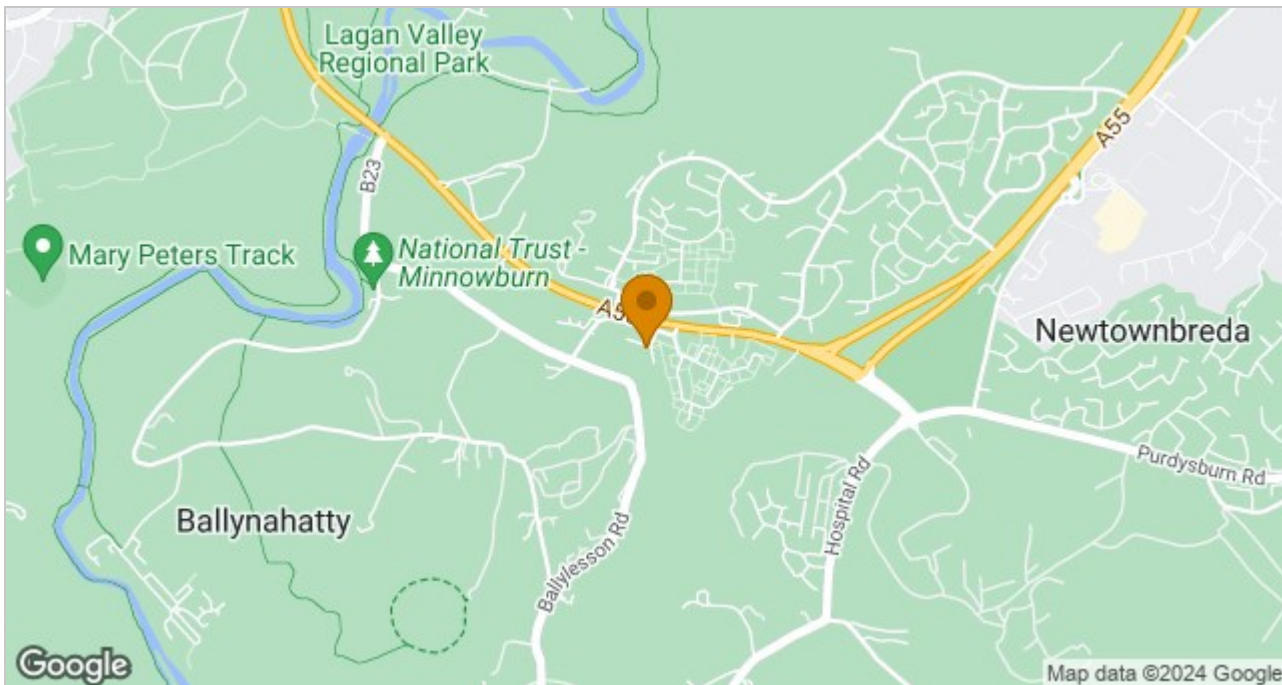

These particulars, whilst believed to be accurate are set out as a general outline only for guidance and do not constitute any part of an offer or contract. Intending purchasers should not rely on them as statements of representation of fact, but must satisfy themselves by inspection or otherwise as to their accuracy. No person in this firm's employment has the authority to make or give any representation or warranty in respect of the property.

ULSTERPROPERTYSALES.CO.UK

ANDERSONSTOWN
028 9060 5200
BALLYHACKAMORE
028 9047 1515
BALLYMENA
028 2565 7700

BALLYNAHINCH
028 9756 1155
BANGOR
028 9127 1185
CARRICKFERGUS
028 9336 5986

CAUSEWAY COAST
0800 644 4432
CAVEHILL
028 9072 9270
DOWNPATRICK
028 4461 4101

FORESTSIDE
028 9064 1264
GLENGORMLEY
028 9083 3295
MALONE
028 9066 1929

NEWTOWNARDS
028 9181 1444
RENTAL DIVISION
028 9070 1000



John Thompson trading under licence as Ulster Property Sales (Downpatrick)
©Ulster Property Sales is a Registered Trademark