



6B Seymour Hill Mews, Dunmurry, BT17 9PW

Price Guide £130,000

Situated just off Kingsway close to Dunmurry Village, we are pleased to offer for sale this beautiful first floor apartment in a quiet courtyard setting. The accommodation comprises spacious living / dining room, modern kitchen with casual dining space, two good sized bedrooms, shower room & utility room. Outside there is resident and visitor car parking. Gas fired central heating and double glazing are in place. Ready to move into, this apartment will be of interest to first time buyers, investors or those downsizing. Close to many amenities including shops and cafes along with easy commuting distance to both Belfast & Lisburn City Centres, early viewing is highly recommended.

- Well Presented First Floor Apartment
- Spacious Living / Dining Room
- Fitted Kitchen & Seperate Utility Room
- Quiet Courtyard Development
- An Ideal First Time Buy Or Suited For Those Looking To Downsize
- Two Good Sized Bedrooms
- Shower Room
- Gas Fired Central Heating / Double Glazing
- Close To The Shops & Cafes Of Dunmurry Village

| Energy Efficiency Rating | | Current | Potential |
|--------------------------|---|-------------------------|-----------|
| (92-100) A | Very energy efficient - lower running costs | | |
| (81-91) B | | | |
| (69-80) C | | | |
| (55-68) D | | | |
| (39-54) E | | | |
| (21-38) F | | | |
| (1-20) G | Not energy efficient - higher running costs | | |
| Northern Ireland | | EU Directive 2002/91/EC | |

THE ACCOMMODATION COMPRISES

ON THE GROUND FLOOR

Steps to apartment 6B.

ON THE FIRST FLOOR

ENTRANCE HALL



LIVING / DINING 22'3" x 13'1" (6.8 x 4.0)



Feature fireplace with electric fire. Juliette balcony.

KITCHEN 12'5" x 10'5" (3.8 x 3.2)



Excellent range of high and low level units,

integrated oven, 4 ring gas hob & stainless steel extractor fan, integrated dishwasher, integrated fridge / freezer, part tiled walls.

BEDROOM ONE 11'1" x 9'10" (3.4 x 3.0)



BEDROOM TWO 11'1" x 8'6" (3.4 x 2.6)



SHOWER ROOM



White suite comprising low flush W.C, wash hand basin with storage below, walk in shower.

UTILITY ROOM 5'10" x 4'11" (1.8 x 1.5)

High & low level units, plumbed for washing machine.

Floor Plan

FIRST FLOOR

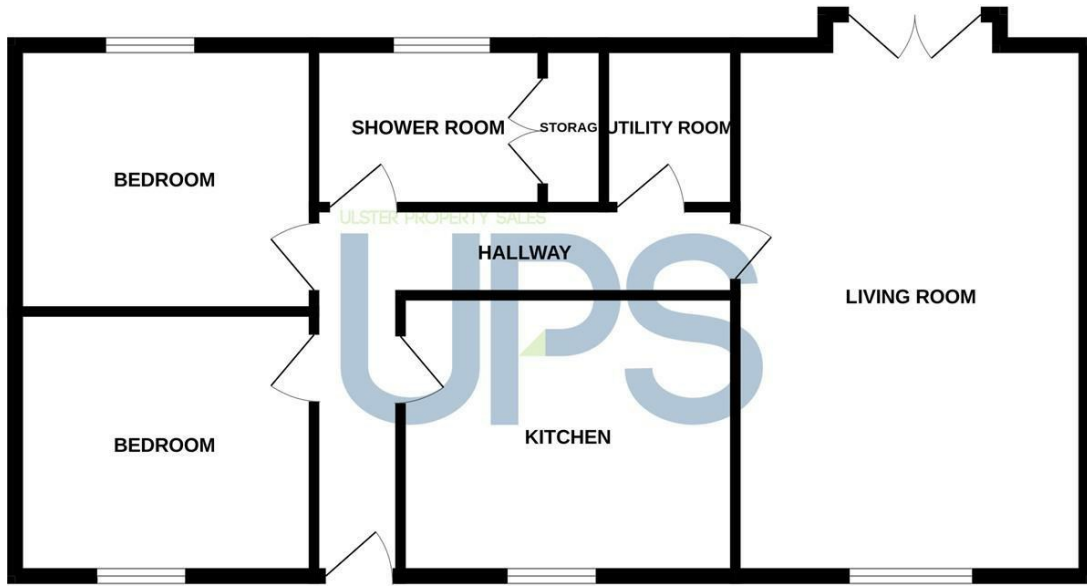

Whilst every attempt has been made to ensure the accuracy of the floorplan contained here, measurements of doors, windows, rooms and any other items are approximate and no responsibility is taken for any error, omission or mis-statement. This plan is for illustrative purposes only and should be used as such by any prospective purchaser. The services, systems and appliances shown have not been tested and no guarantee as to their operability or efficiency can be given.
Made with Metropix ©2024.

Area Map



These particulars, whilst believed to be accurate are set out as a general outline only for guidance and do not constitute any part of an offer or contract. Intending purchasers should not rely on them as statements of representation of fact, but must satisfy themselves by inspection or otherwise as to their accuracy. No person in this firm's employment has the authority to make or give any representation or warranty in respect of the property.

ULSTERPROPERTYSALES.CO.UK

ANDERSONSTOWN
028 9060 5200
BALLYHACKAMORE
028 9047 1515
BALLYMENA
028 2565 7700

BALLYNAHINCH
028 9756 1155
BANGOR
028 9127 1185
CARRICKFERGUS
028 9336 5986

CAUSEWAY COAST
0800 644 4432
CAVEHILL
028 9072 9270
DOWNPATRICK
028 4461 4101

FORESTSIDE
028 9064 1264
GLENGORMLEY
028 9083 3295
MALONE
028 9066 1929

NEWTOWNARDS
028 9181 1444
RENTAL DIVISION
028 9070 1000



John Thompson trading under licence as Ulster Property Sales (Downpatrick)
©Ulster Property Sales is a Registered Trademark