

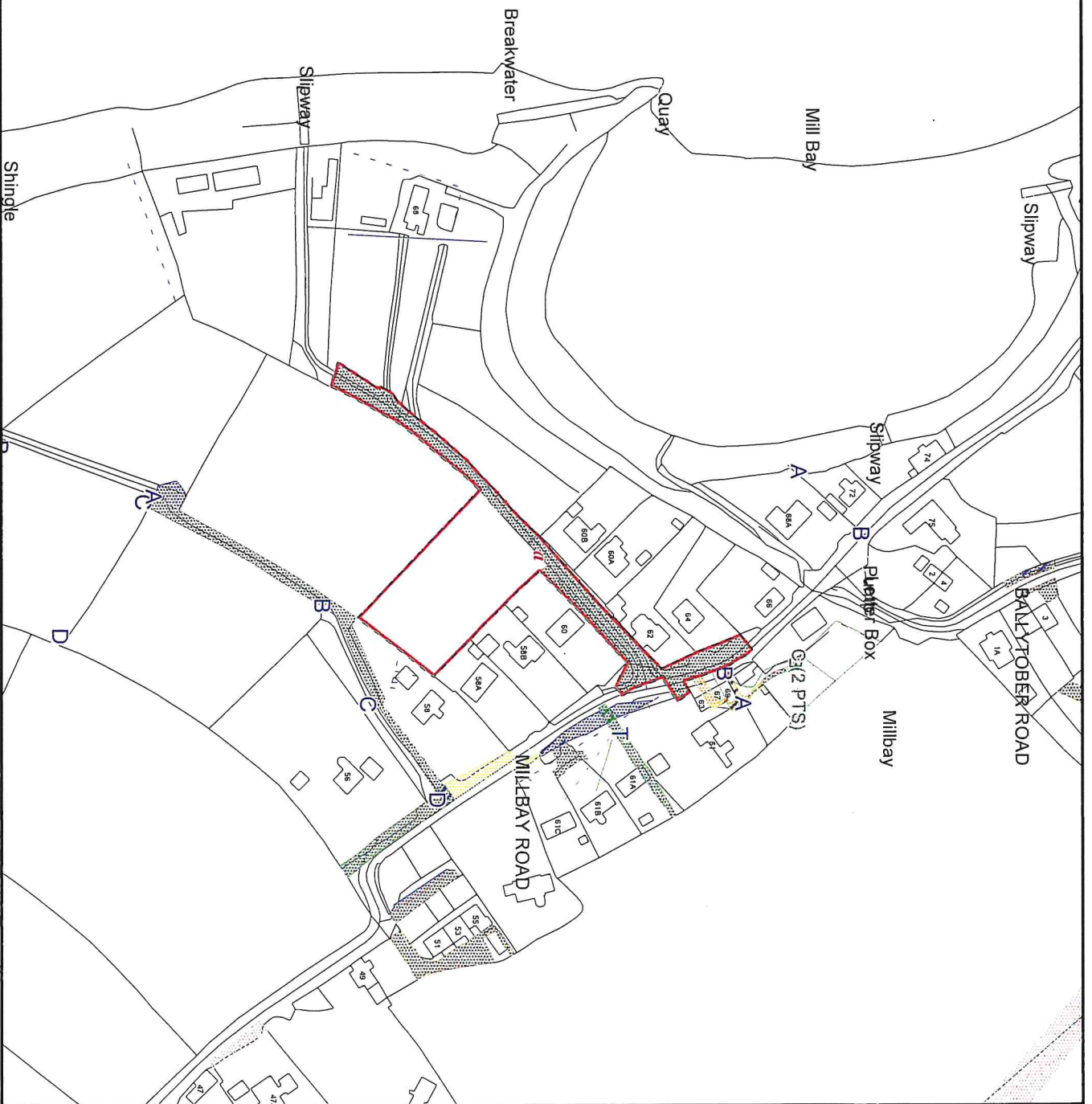

Land & Property Services  
Seirbhís Talún & Maoinne  
THE LAND REGISTRY | CLARLANN NA TALÚN

Date: 03 Apr 2023  
County: Antrim  
Folio: AN123465  
Scale: 1:2500  
Our Ref: 2023/273114  
Your Ref: Bayshore Homes new to open  
Map Ref(s): 07114SW  
Sheet 1 of 1

Key to folio labels:  
A - AN123465



This map is for location purposes only. (Rule 14(1) of the Land Registration Rules (Northern Ireland) 1994 as amended by paragraph 19 of the schedule to the Amendment Rules 2000). Folio boundaries are not guaranteed. (Section 84 of the Land Registration Act (Northern Ireland) 1970). The boundaries of land and property (including OSN features) may have been altered by revision of the OSN map subsequent to map creation.  
This map has been prepared using the largest scale Land Registry map available for the area. Any future Deed map should be based on the largest scale OS Grid Plan available for the area. The boundaries of land and property (including OSN features) may have been altered by revision of the OSN map subsequent to map creation. Registration Act (NI) 1970. Where there is any doubt concerning boundaries, the original Instrument or Document should be inspected.  
This copy map shows the location of the lands comprised in the folio listed above.

**Crown Copyright Reserved**  
This map may only be produced with the permission of the Land Registry and Ordnance Survey of Northern Ireland. Based upon Ordnance Survey of Northern Ireland's data with the permission of the Controller of Her Majesty's Stationery Office. Crown copyright and database right. S100(2)(1).  
N  
W  
E  
S