

**Tim Martin**  
— .co.uk



**5 Winchester Drive  
Carryduff  
BT8 8QD**

**Offers Around  
£157,500**

[www.timmartin.co.uk](http://www.timmartin.co.uk)  
Telephone 028 91 878956

## SUMMARY

Situated just off the Ballynahinch Road in the ever-popular Winchester area, this well-presented, semi-detached home is ideally located to take advantage of the array of local amenities and good transport links.

Downstairs, the open plan lounge and dining room benefit from a feature fireplace and solid wood flooring, while the fitted kitchen leads to the fully enclosed rear garden. Upstairs comprises 3 bedrooms, with wood laminate flooring, and bathroom.

Externally, the property is set on a spacious site providing off street parking. To the rear, the garden is laid out in lawn with a flagged patio area, making it ideal for summer BBQ's, and benefits from a bitmac storage area.

Carryduff offers a wide range of amenities including supermarket, eateries, churches and the Lough Moss Leisure Centre. There are primary schools in the immediate area, and public transport links to secondary schools in Belfast, Lisburn and Ballynahinch. The town benefits from a good road network making this property an easy commute to Belfast and the Motorway networks.

This home is ideal for first time buyers – early viewing is recommended.

## FEATURES

- Well-Presented, Semi-Detached Home
- Lounge with Feature Fireplace Open Plan to Dining Room
- Fitted Kitchen Leading to Rear Garden
- 3 Bedrooms with Wood Laminate Flooring
- Bathroom with White Suite
- Bitmac Driveway Providing Parking for 3 Cars
- Easily Maintained Front Garden
- Fully Enclosed Rear Garden with Patio Area
- Superb Location in this Popular Development within Walking Distance to the Local Amenities
- Ideal for First Time Buyers

## **Entrance Hall**

Solid wood flooring

## **Lounge**

**11'4 x 13'1 (3.45m x 3.99m )**

TV aerial and telephone connection point; solid wood flooring; cast iron fireplace with granite hearth and cast iron effect surround; under stairs storage cupboard; open plan to:-

## **Dining Room**

**10'2 x 7'4 (3.10m x 2.24m )**

Solid wood flooring; telephone connection point.

## **Kitchen**

Good range of laminate eye and floor level cupboards; single drainer stainless steel sink unit with mixer taps; space and plumbing for washing machine and dishwasher; Zanussi electric oven and grill with ceramic hob; extractor unit and light; space for fridge / freezer; glazed uPVC door to rear.

## **Stairs to First Floor Landing**

Access to roof space.

## **Bathroom**

**8'5 x 6'1 (2.57m x 1.85m )**

White suite comprising panelled bath with mixer taps; Mira Sport electric shower with telephone shower attachment over; glass panel; pedestal wash hand basin with chrome mixer tap; close coupled WC; hotpress with lagged copper cylinder; tiled floor; part tiled walls; extractor fan

## **Bedroom 1**

**11'7 x 8'2 (3.53m x 2.49m )**

Wood laminate flooring

## **Bedroom 2**

**11'2 x 8'10 (3.40m x 2.69m)**

Wood laminate flooring

## **Bedroom 3**

**7'9 x 6'9 (max measurements) (2.36m x 2.06m (max measurements))**

Wood laminate flooring; built in storage cupboard with louvered doors.

## **Garden**

Easily maintained front garden laid out in lawn and planted with a selection of ornamental shrubs.

## **Rear Garden**

Laid out in lawn with pebbled flowerbed; flagged patio area; boiler house with Rielle oil fired boiler; corrugated tin garden shed; bit mac storage area to side; oil storage tank.

## **Tenure**

Leasehold

## **Ground Rent**

£35 Per Annum

## **Capital / Rateable Value**

£100,000 = Rates Payable £870.00 per annum (approximately)

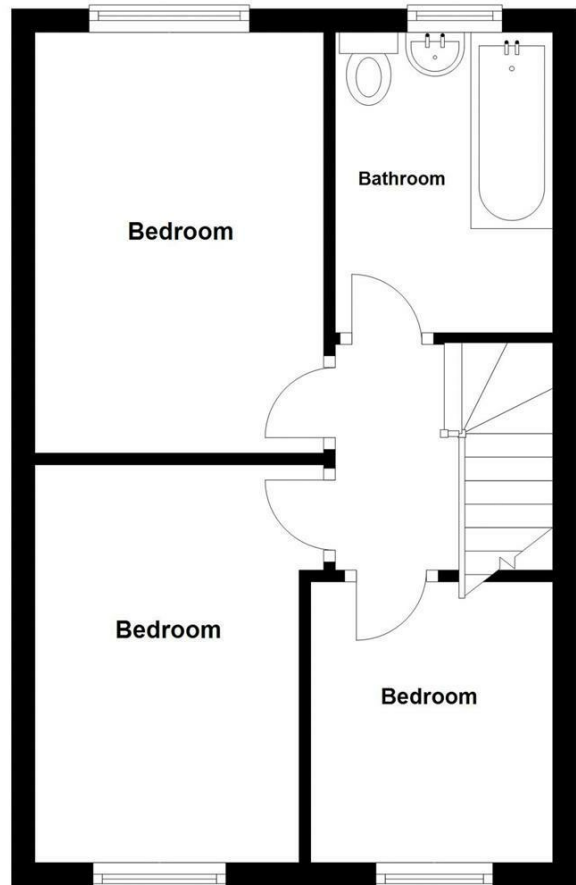
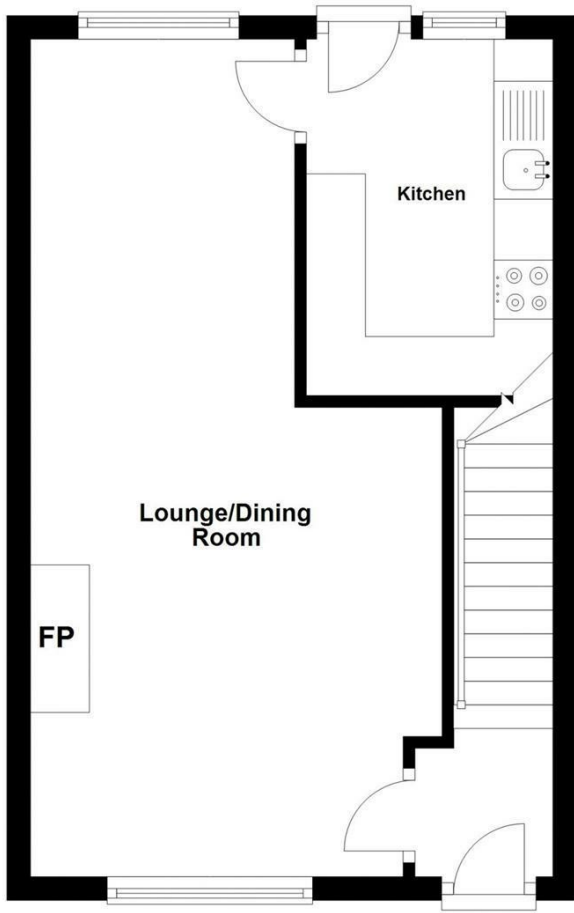















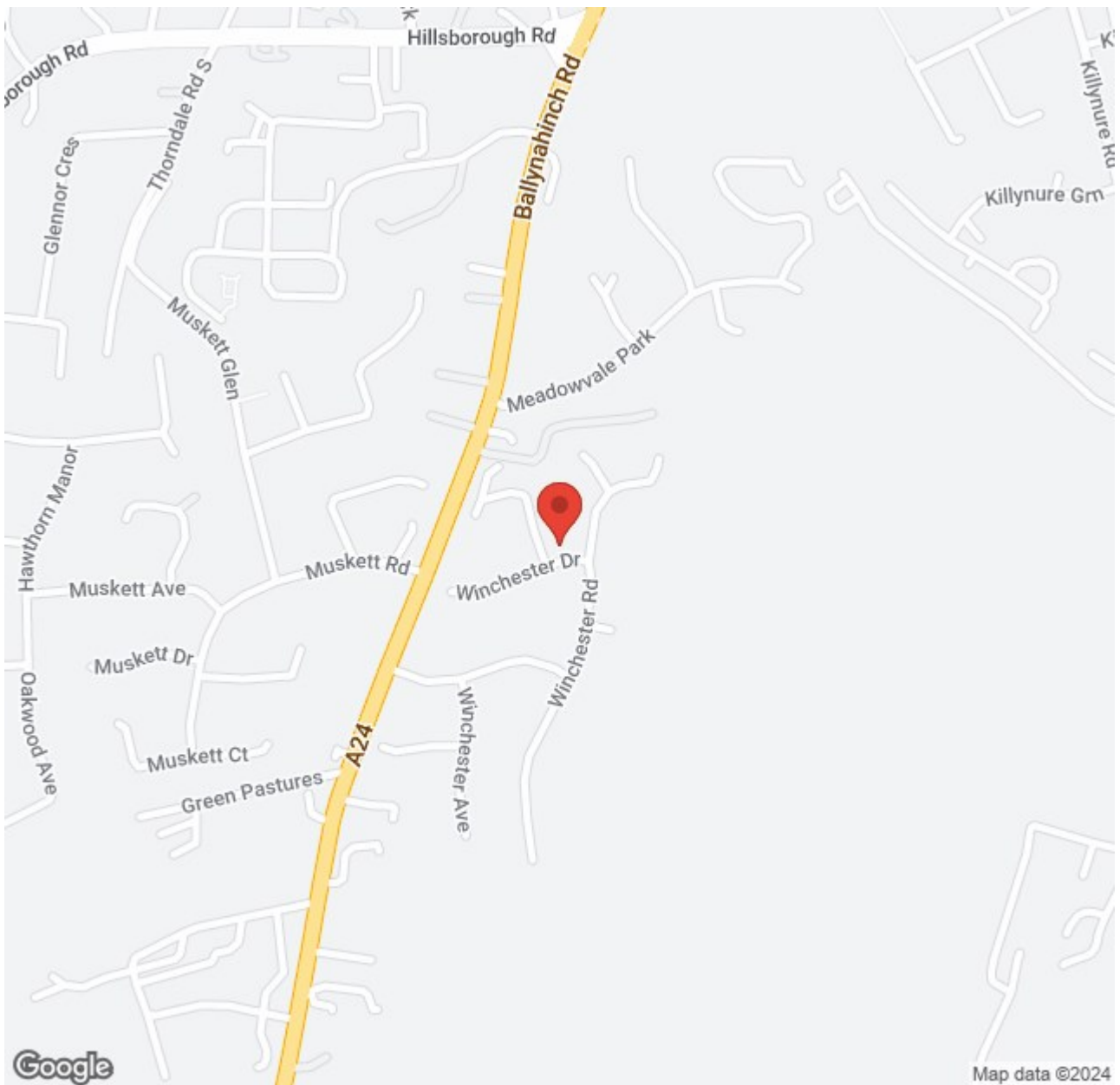

Energy Efficiency Rating		Current	Potential
Very energy efficient - lower running costs			
(92 plus) <b>A</b>			
(81-91) <b>B</b>			
(69-80) <b>C</b>			
(55-68) <b>D</b>			
(39-54) <b>E</b>			
(21-38) <b>F</b>			
(1-20) <b>G</b>			
Not energy efficient - higher running costs			
		53	67

Comber  
 27 Castle Street, Comber, BT23 5DY  
 T 028 91 8789596

Saintfield  
 1B Main Street, Saintfield, BT24 7AA  
 T 028 97 568300

Tim Martin & Company for themselves and for the vendors of this property have endeavoured to prepare these sales details as accurate and reliable as possible for the guidance of intending purchasers or lessees. These particulars are given for general guidance only and do not constitute any part of an offer or contract. The seller and us as agents, do not make any representation or give any warranty in relation to the property. We would recommend that all information contained in this brochure about the property be verified by yourself or professional advisors. Services, fittings and equipment referred to in the sales details have not been tested (unless otherwise stated) and no warranty will be given as to their condition. All measurements contained within this brochure are approximate. Please contact us prior to viewing the property. If there is any point of particular importance to you we would be pleased to provide additional information or make further enquiries. We will also confirm that the property remains available. This is particularly important if you are contemplating travelling some distance to view the property.