

**Tim Martin**  
.co.uk

A rare opportunity exists to purchase 6.7 acres or thereabouts of quality arable lands situated close to the village of Dundrum.

The lands are currently in stubble and divided into two fields with access via a concrete lane leading off the Old Road.

The lands front onto the Mill Pond providing a pleasing setting for the lands which are thought suitable for cropping, grazing and/or cutting.

LOCATION: From Dundrum, proceed out the Newcastle Road, take the first road to the right into Old Road, then right up a concrete lane immediately before the cricket ground. Go to the end of the lane and the field is on the right hand side.

**Quality Arable Lands 'Damfield'**  
**Adjacent To 5 Old Road**  
**Dundrum**  
**BT30 0NH**

**Offers Around**  
**£135,000**

[www.timmartin.co.uk](http://www.timmartin.co.uk)  
Telephone 028 97 568300

# MAP REFERRED TO

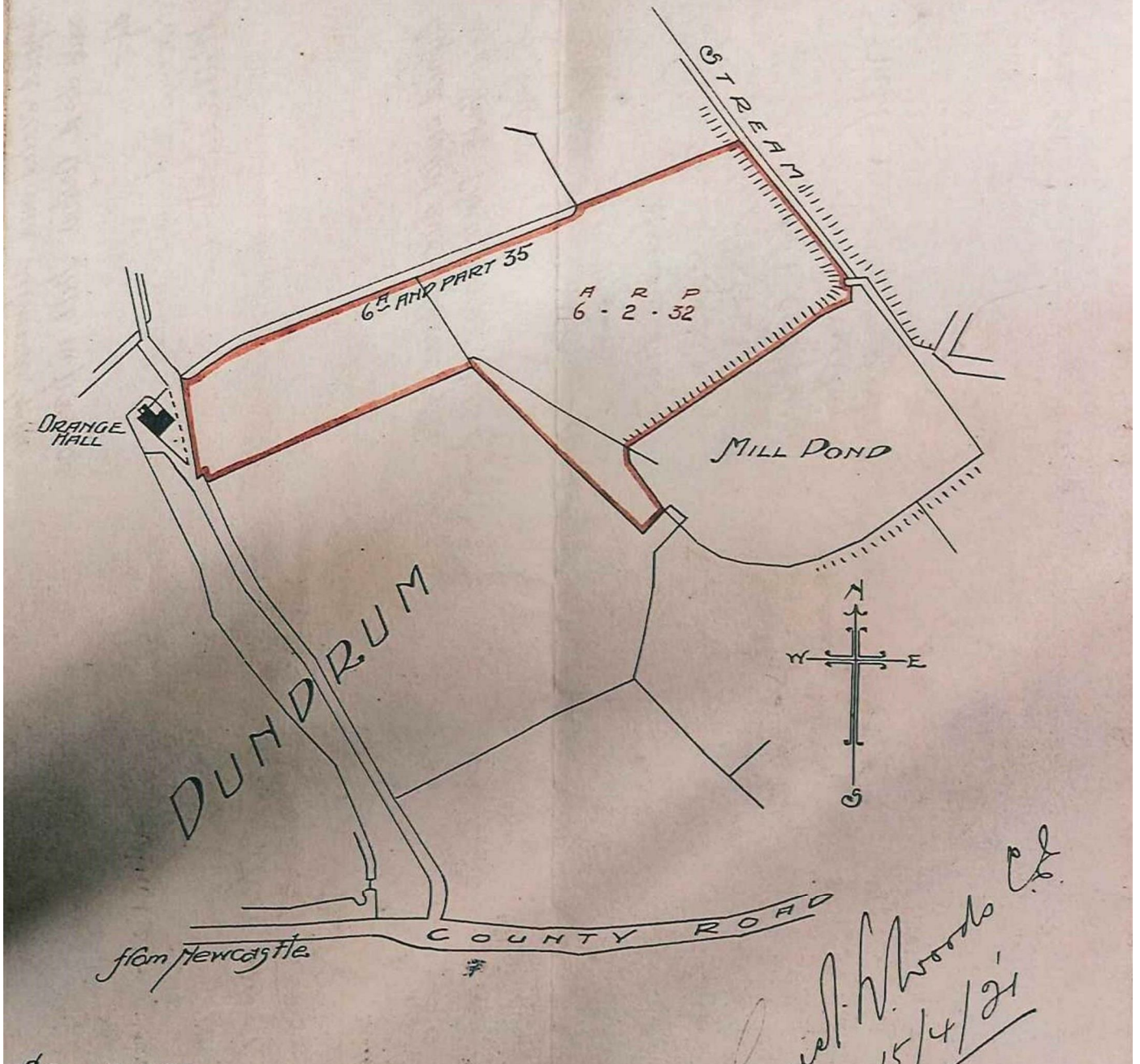

Comber ■  
27 Castle Street, Comber, BT23 5DY  
T 028 91 8789596

Saintfield  
1B Main Street, Saintfield, BT24  
7AA  
T 028 97 568300

Tim Martin & Company for themselves and for the vendors of this property have endeavoured to prepare these sales details as accurate and reliable as possible for the guidance of intending purchasers or lessees. These particulars are given for general guidance only and do not constitute any part of an offer or contract. The seller and us as agents, do not make any representation or give any warranty in relation to the property. We would recommend that all information contained in this brochure about the property be verified by yourself or professional advisors. Services, fittings and equipment referred to in the sales details have not been tested (unless otherwise stated) and no warranty will be given as to their condition. All measurements contained within this brochure are approximate. Please contact us prior to viewing the property. If there is any point of particular importance to you we would be pleased to provide additional information or make further enquiries. We will also confirm that the property remains available. This is particularly important if you are contemplating travelling some distance to view the property.