



Bond  
Oxborough  
Phillips

*Changing Lifestyles*

20 Carpenter Way

Tavistock

PL19 0FL



**Asking Price - £290,000**



Changing Lifestyles

01822 600700

# 20 Carpenter Way, Tavistock, PL19 0FL.

A spacious three bedroom terraced home, a short walk from the village center of Tavistock with generous garden and parking...



- Generous Plot Size
- Modern Interior
- Short Walk to Town Centre
- Three Bedrooms
- Three Bathrooms
- Designated Parking Area
- Kitchen/ Dining area
- Enclosed Rear Garden
- Garden Seating area
- EPC - B



Nestled within the serene surroundings of Embden Grange, this remarkable opportunity presents itself—a charming terraced property boasting three bedrooms and a designated parking space, all for the enticing price.

Step into modern comfort and coziness as you enter this inviting abode. To your immediate left, the spacious living room welcomes you with open arms, offering an ideal layout for hosting gatherings and creating lasting memories. Transition seamlessly into the well-appointed kitchen, complete with contemporary appliances, ensuring a move-in-ready experience for its new occupants.

Beyond the kitchen lies access to the garden—a private oasis, enclosed for your tranquility. Stretching back to reveal a delightful summer garden shelter, it sets the scene for countless family occasions and serene moments of relaxation.



Ascend the stairs to discover the upper level, where two generously sized guest bedrooms await, each bathed in natural light and offering ample space for comfort and convenience. Continuing onward, sits the family bathroom exuding a modernized elegance that harmonizes perfectly with the home's aesthetic. Adjacent lies the master bedroom, providing sanctuary and space for a double bed, promising restful nights and peaceful mornings.

We wholeheartedly recommend experiencing this property firsthand to fully appreciate its spaciousness, potential, and the unique charm it offers within the enchanting town of Tavistock. Schedule your viewing today and embark on a journey to discover your dream home.



# Changing Lifestyles

Tavistock is a thriving stannary market town in West Devon, nestled on the western edge of Dartmoor National Park. Tavistock is an ancient town, rich in history dating back to the 10th century and famed for being the birthplace of Sir Francis Drake. Largely the 19th-century town centre is focused around Bedford Square which is a short stroll from this property.

The town offers a superb range of shopping, boasting the famous Pannier Market and a wide range of local and national shops. Also there are public houses, cafes, restaurants, social clubs, riverside park, leisure centre, theatre, doctors surgery, dentists and Tavistock Hospital. There are excellent educational facilities including primary and secondary schools in the state and private sector. The town has superb recreation and sporting facilities including; Tennis club, bowls club, golf club, cricket clubs, football club and athletics track.

Plymouth, some 15 miles to the south, offers extensive amenities. The cathedral city of Exeter lies some 40 miles to the northeast, providing transport connections to London and the rest of the UK via its railway links and the M5 motorway.

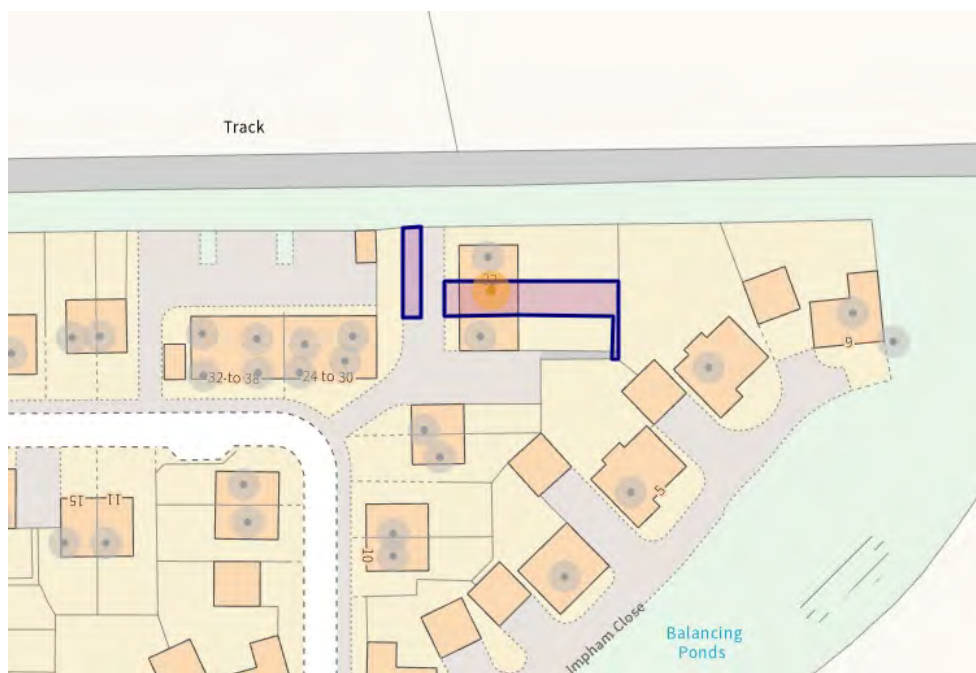

Please do not hesitate to contact  
the team at  
Bond Oxborough Phillips  
Sales & Lettings on  
**01822 600700**  
for more information or to  
arrange an accompanied viewing  
on this property.

Scan here for  
our Virtual Tour:





Floor 0 Building 1

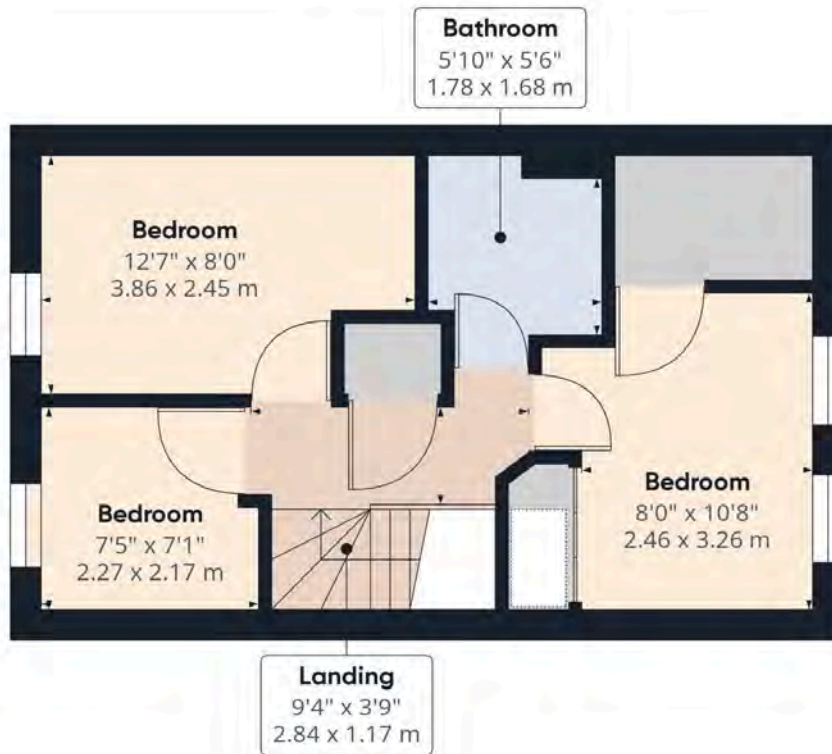

Floor 1 Building 1

## Have a property to sell or let?

If you are considering selling or letting your home, get in contact with us today on 01822 600700 to speak with one of our expert team who will be able to provide you with a free valuation of your home.

We have the facility to refer purchasers and vendors to conveyancing, mortgage advisors and Surveyors. It is your decision if you choose to deal with any of these companies however should you choose to use them we would receive a referral fee from them for recommending you. We will receive a referral fee between £50 - £300 depending on the company & individual circumstances. We have carefully selected these associates for the quality of their work and customer service levels.

Consumer Protection Regulations: We have not tested any apparatus, equipment, fixtures and fittings or services and so cannot verify that they are in working order or fit for the purpose. References to the Tenure of a Property are based on information supplied by the seller. We have not had sight of the Title Documents. A buyer is advised to obtain verification from their solicitor or surveyor. Floorplans shown are for guidance only and should not be relied upon. Items shown in photographs are NOT included unless specifically mentioned within these details. They may however be able by separate negotiation. You are advised to check the availability of this property before travelling any distance to view. Particulars are produced in good faith to the best of our knowledge and are set out as a general guide only.