

1 Cloverhill Gardens, Bangor,
County Down, BT19 6XU

Asking Price: £155,000

 **Reeds Rains**

reedsrains.co.uk

1 Cloverhill Gardens, Bangor, BT19 6XU
Asking Price: £155,000

EPC Rating: TBC

Description

Located in a quiet residential cul de sac this 3 bedroom semi detached will appeal to both first time buyers and first time movers alike. The accommodation comprises of a lounge open plan to the dining room and a modern fitted kitchen on the ground floor. The 1st floor reveals 3 bedrooms and a bathroom with a white suite. Fully upvc double glazed the property also boasts oil fired heating and an attached garage. Externally there are gardens to both front and rear in lawns and flowerbeds. All in all an excellent property offered to the market chain free.

Entrance Hall

uPVC double glazed front door, built in storage cupboard.

Lounge

13'5" x 11'3" (4.1m x 3.43m)
Brick fireplace and hearth, archway to dining room.

Dining Room

9'9" x 8'9" (2.97m x 2.67m)

Kitchen

11'6" x 8'9" (3.5m x 2.67m)
Single drainer stainless steel sink unit with mixer taps, excellent range of high and low level units with laminated work surfaces, stainless steel chimney extractor fan, plumbed for washing machine, integrated fridge freezer, ceramic tiled floor, part tiled walls, uPVC double glazed door to garden.

First floor landing

Hot press, access to roof space.

Bedroom 1

13'1" x 8'8" (4m x 2.64m)

Bedroom 2

11'7" x 9'10" (3.53m x 3m)

Bedroom 3

8'2" x 8' (2.5m x 2.44m)

Built in robe.

Bathroom

White suite comprising: Panelled bath with tiled splashback, fully tiled built in shower cubicle with Redring electric shower, low flush WC, pedestal wash hand basin.

Outside

Paved driveway to off street parking and access to garage.

Attached Garage

Roller door, power and light, oil fired boiler, rear access.

Gardens

Front garden in lawns and shrubs. Enclosed rear garden with a south-westerly aspect. Gardens are in lawns, flowerbeds, and shrubs with patio area and boundary hedging. PVC Oil tank.

The Reeds Rains branches at 350 Upper Newtownards Road, Ballyhackamore, Belfast, N Ireland BT4 3EX, 18 Main Street, Bangor, Co Down, N Ireland BT20 5AG, Somerset House, 240-242 Ormeau Road, Belfast, Co Antrim, N Ireland BT7 2FZ, 10 High Street, Carrickfergus, Co Antrim, N Ireland BT38 7AF, 8/8A Carnmoney Road, Glengormley, County Antrim, N Ireland BT36 6HN, 14/16 Market Street, Lisburn, County Antrim, N Ireland BT28 1AB and 2 Frances Street, Newtownards, County Down, N Ireland BT23 4JA are operated by Favscos NI Limited which is independently owned and operated under a Licence from Reeds Rains Limited.

All Measurements
All Measurements are Approximate.

Laser Tape Clause
All measurements have been taken using a laser tape measure and therefore, may be subject to a small margin of error.

Floorplan Clause

Measurements are approximate. Not to Scale. For illustrative purposes only.

For full EPC please contact the branch.



Ground Floor

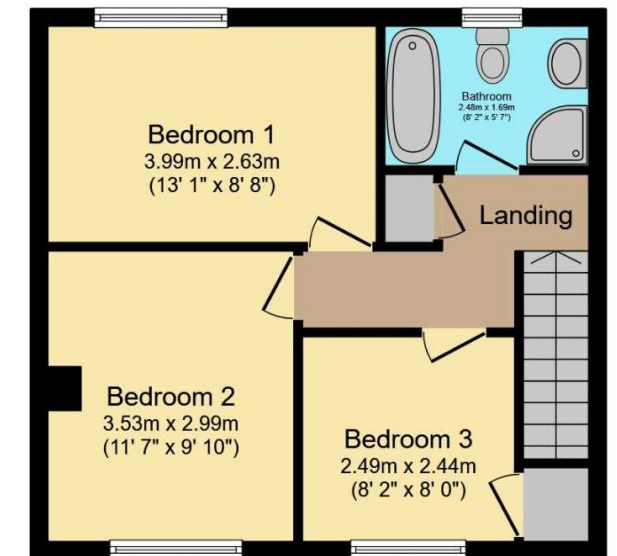

First Floor

Total floor area 83.4 m² (898 sq.ft.) approx

This floor plan is for illustrative purposes only. It is not drawn to scale. Any measurements, floor areas (including any total floor area), openings and orientation are approximate. No details are guaranteed, they cannot be relied upon for any purpose and they do not form part of any agreement. No liability is taken for any error, omission or misstatement. A party must rely upon its own inspection(s).
Powered by www.focalagent.com

We may refer you to recommended providers of ancillary services such as Conveyancing, Mortgages, Insurance and Surveying. We may receive a referral fee for recommending their services. You are not under any obligation to use the services of the recommended provider, which may also be an associated company of Reeds Rains.

Other important information which you will need to know about this property can be found at reedsrains.co.uk