

MARC FEGAN

BESPOKE ESTATE AGENT



38 Drumard Park

Knockmore Road, Lisburn, BT28 2HU

Asking price £129,950



Marc Fegan Bespoke Estate Agents are delighted to welcome to the market this superb three bedroom mid terrace home in the ever popular Drumard Park area just off the Knockmore Road in Lisburn. This stunning home was completely renovated throughout in 2017 and would make an ideal purchase for first time buyers. It is in immaculate condition throughout with a modern finish and good gardens to the front and rear.

Located on the outskirts on Lisburn City Centre this property offers easy access to local schools, amenities and transport links.

Viewings are strictly by appointment only.



Area Map



Floor Plans

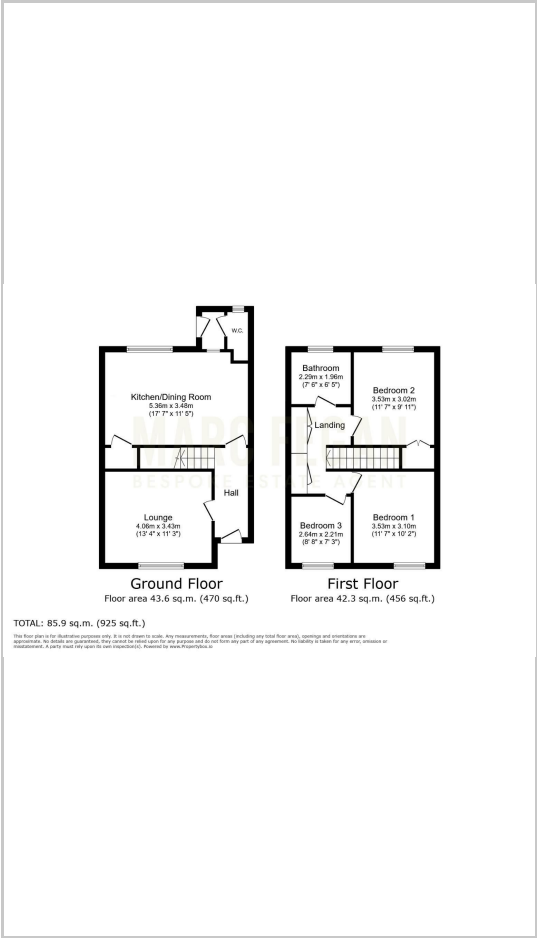

Energy Efficiency Graph

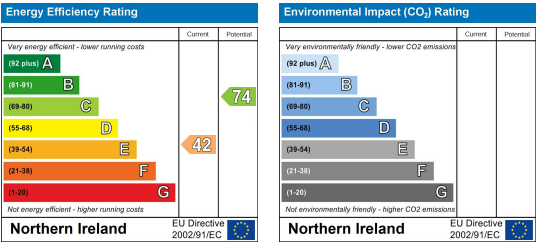

These particulars, whilst believed to be accurate are set out as a general outline only for guidance and do not constitute any part of an offer or contract. Intending purchasers should not rely on them as statements of representation of fact, but must satisfy themselves by inspection or otherwise as to their accuracy. No person in this firm's employment has the authority to make or give any representation or warranty in respect of the property.