



## 29 Rossdale

Ballymena, BT42 2SA

Offers Around £145,000





# 29 Rossdale

, Ballymena, BT42 2SA

Offers Around £145,000



## GROUND FLOOR

### Hallway

Laminate flooring.

### Living Room

13'10" x 11'0" (4.22 x 3.37)

Open fire with period inset. Laminate flooring.

### Cloakroom

6'5" x 6'6" (1.98 x 2.00)

WC and WHB.

### Kitchen / Dining Room

17'6" x 11'1" (5.35 x 3.38)

High and low level units. Gas hob with stainless steel hood. Electric oven. Stainless steel sink, Space for dishwasher. Tiled splashback. Laminate flooring. Space for large family dining table.

### Utility Room

9'6" x 6'5" (2.92 x 1.97)

High and low level units. Plumbed for washing machine, space for tumble dryer. Tiled splashback. Back door.

## FIRST FLOOR

### Landing

### Bedroom 1 - Front

13'10" x 11'0" (4.22 x 3.37)

### En-suite

WC and WHB. Shower cubicle.

### Bedroom 2 - Rear

14'4" x 6'6" (4.39 x 2.00)

### Family Bathroom

9'10" x 8'3" (3.01 x 2.53)

### Bedroom 3 - Front

7'10" x 6'6" (2.39m x 1.98m)

### External

Front garden in lawn.

Private driveway in tarmac.

Generous sized, low maintenance rear garden to the rear.

Outside lighting.



## Road Map



## Hybrid Map



## Terrain Map



## Floor Plan

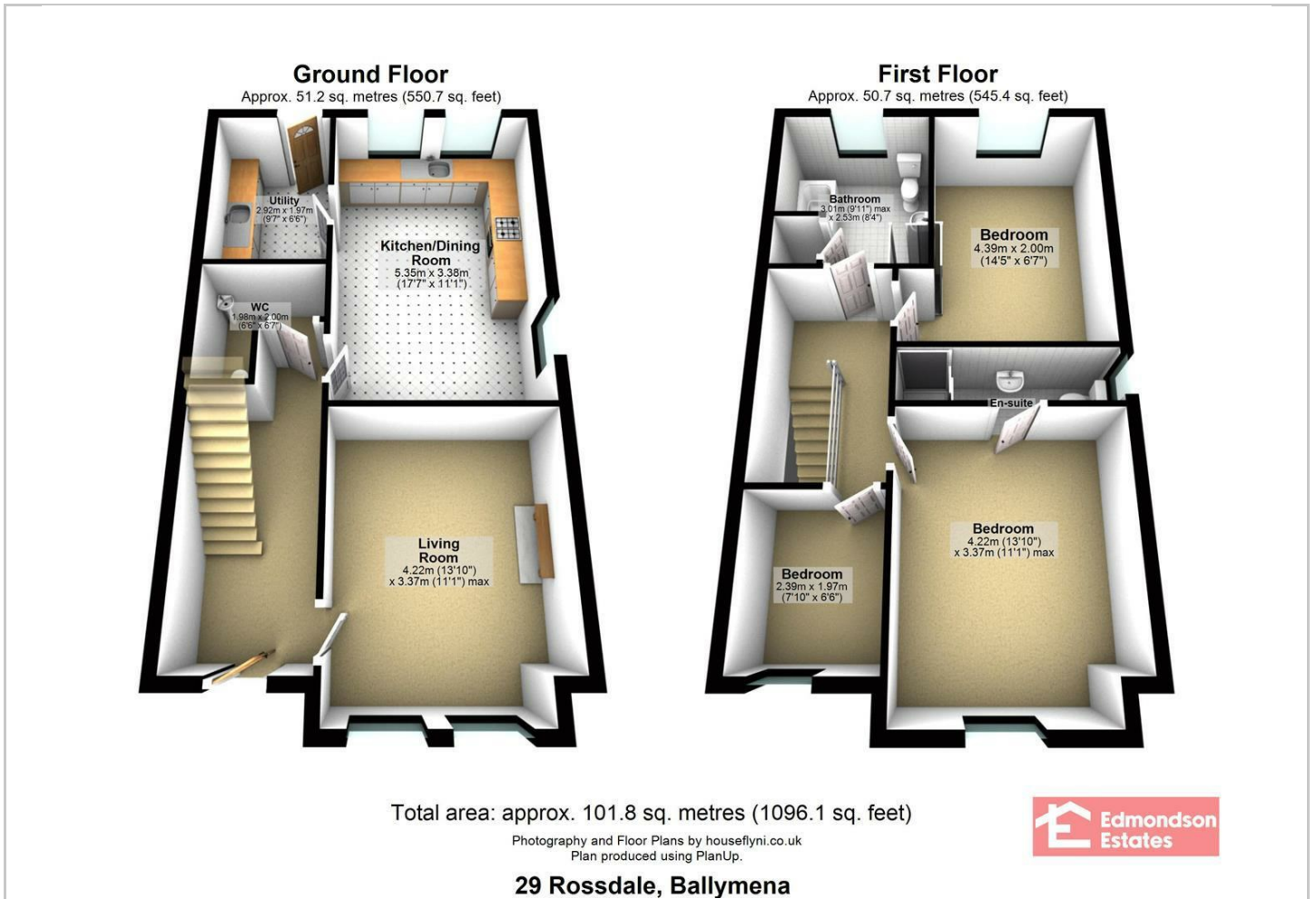

## Viewing

Please contact our Ballymena Office on 02825655733 if you wish to arrange a viewing appointment for this property or require further information.

## Energy Efficiency Graph

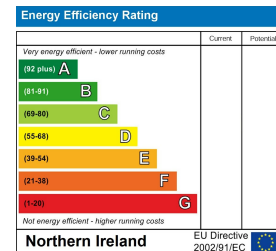

These particulars, whilst believed to be accurate are set out as a general outline only for guidance and do not constitute any part of an offer or contract. Intending purchasers should not rely on them as statements of representation of fact, but must satisfy themselves by inspection or otherwise as to their accuracy. No person in this firm's employment has the authority to make or give any representation or warranty in respect of the property. Edmondson Estates have not tested any services, equipment, or facilities within the premises and will not be liable, in negligence or otherwise, for any loss arising from the use of these particulars.