



5 Ardenlee Park, Ravenhill Road, Belfast, BT6 8QR

Asking Price £155,000

Situated within the ever popular Ardenlee Green development off the Ravenhill Road, this spacious 1st floor apartment comprises two double bedrooms, both with built in storage, one reception room, a fitted kitchen and recently fitted white bathroom suite. In addition to electric heating system and double glazing this property has been well maintained and is only further complemented by it's internal presentation and finish leaving any potential purchaser with little to do but add furniture. For those who enjoy keeping fit there is access to the on site gymnasium and for those who enjoy the outdoors Ormeau Park is just a few minutes walk away. An excellent first time purchase and or investment, located in a high demand location, it is one that can only be appreciated upon internal inspection.

- 1st floor apartment
- Two good size bedrooms, both with built in storage
- Spacious lounge / dining
- Fitted kitchen
- Brand new bathroom suite
- Economy 7 heating
- Double glazed windows
- Balcony from bedroom 2
- Parking to the rear
- Cul de sac setting

Energy Efficiency Rating		Current	Potential
(92-100) A	Key energy efficient - lower running costs		81
(81-91) B		77	
(69-80) C			
(55-68) D			
(39-54) E			
(21-38) F			
(1-20) G	Not energy efficient - higher running costs		
Northern Ireland		EU Directive 2002/91/EC	

The accommodation comprises

Hardwood front door leading to the reception hall

Reception hall

Inner door leading to the lounge

Lounge 14'2 x 13'8 (4.32m x 4.17m)



Laminate flooring.

Kitchen 10'2 x 8'3 (3.10m x 2.51m)



Range of high and low level units, single drainer 1 1/2 bowl sink unit with mixer taps, formica work surfaces, 4 ring hob and under oven, extractor fan, plumbed for washing machine, fridge freezer space, tiled floor.

Bathroom 6'9 x 6'6 (2.06m x 1.98m)



New white bathroom suite comprising panelled bath, Triton T80 shower, low flush w/c, pedestal wash hand basin, wash hand basin with storage below. part tiled walls, tiled floor.

Bedroom 11'2 x 10'3 (3.40m x 3.12m)



Built in sliding robes.

Bedroom 2 11'7 x 8'5 (3.53m x 2.57m)



Laminate flooring, built in robe. Access to the balcony.

Balcony



Access from bedroom 2.

Outside

Communal area to the rear with ample parking facilities.

Management charges

CSM management £42.29 per month

Floor Plan

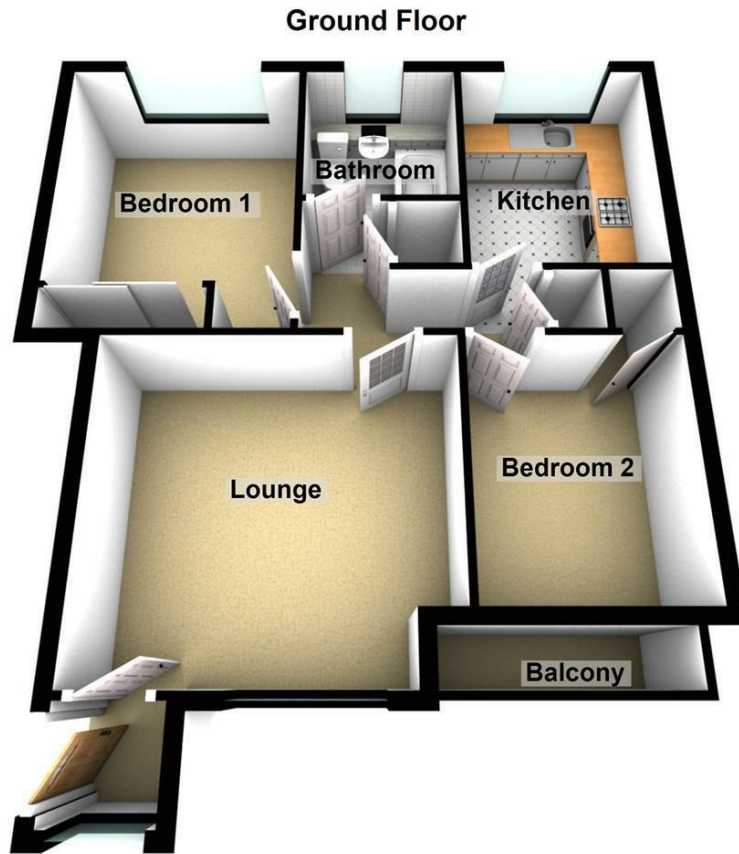

Please note this floor plan is for marketing purposes only, is not to scale and is to be used as a guide only. No liability is accepted in respect of any consequential loss arising from the use of this plan.
Plan produced using PlanUp.

Area Map

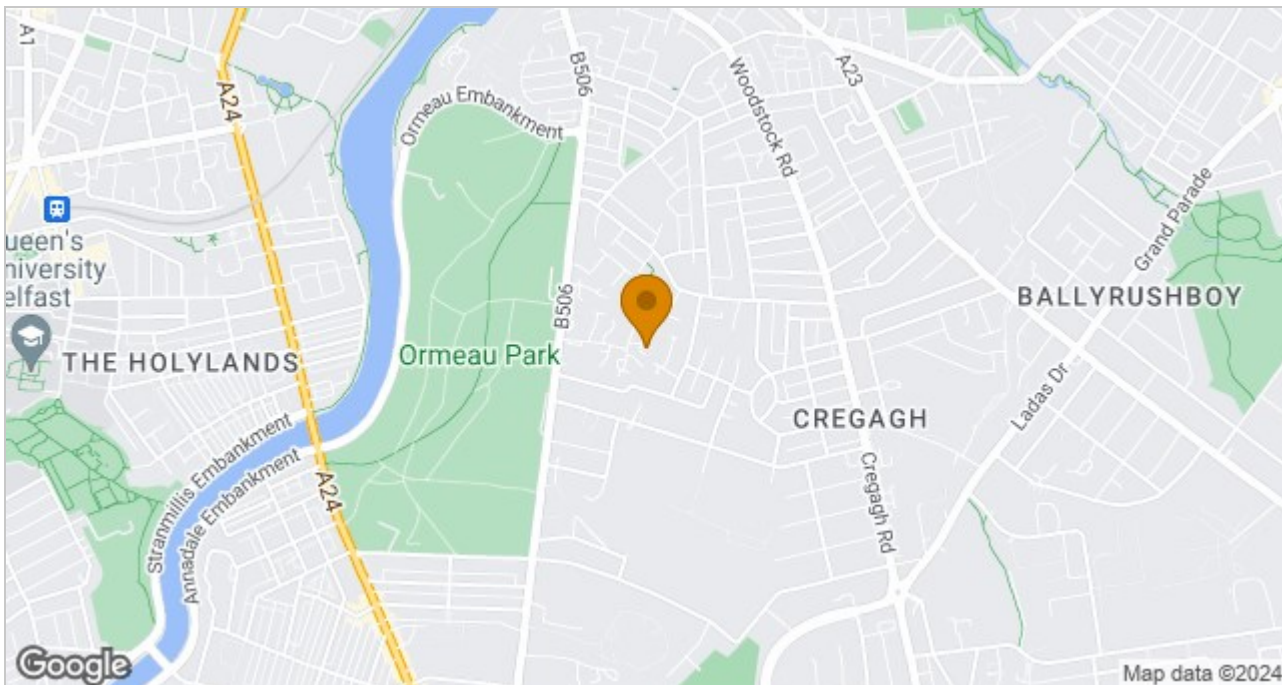

These particulars, whilst believed to be accurate are set out as a general outline only for guidance and do not constitute any part of an offer or contract. Intending purchasers should not rely on them as statements of representation of fact, but must satisfy themselves by inspection or otherwise as to their accuracy. No person in this firm's employment has the authority to make or give any representation or warranty in respect of the property.

ULSTERPROPERTYSALES.CO.UK

ANDERSONSTOWN
028 9060 5200

BALLYHACKAMORE
028 9047 1515

BALLYMENA
028 2565 7700

BALLYNAHINCH
028 9756 1155

BANGOR
028 9127 1185

CARRICKFERGUS
028 9336 5986

CAUSEWAY COAST
0800 644 4432

CAVEHILL
028 9072 9270

DOWNPATRICK
028 4461 4101

FORETSIDE
028 9064 1264

GLENGORMLEY
028 9083 3295

MALONE
028 9066 1929

NEWTOWNARDS
028 9181 1444

RENTAL DIVISION
028 9070 1000



John Thompson trading under licence as Ulster Property Sales (Downpatrick)
©Ulster Property Sales is a Registered Trademark