



29 Culross Drive

Dundonald, Belfast, BT16 2SQ

With demand for well presented properties high in this area we are delighted to offer this charming end terraced home to the market.

The property is neatly presented throughout and has been kept up to date by its present owners of over 50 years. It offers 3 bedrooms, all with built in storage cupboards, a bathroom, a bright and airy lounge, with laminate wood flooring and mock fireplace, plus a kitchen/diner with pleasant white units and granite effect worktops. It benefits from uPVC double glazing & fascia and Phoenix gas central heating.

Externally there are gardens in lawn to front & side plus an enclosed terraced garden to the rear with off street parking area and pleasant views from the elevated site.

For first time buyers or healthcare workers employed in the local hospital this could be your ideal home and we recommend early viewing to avoid disappointment.

Offers Around £129,950

29 Culross Drive

Dundonald, Belfast, BT16 2SQ



- End terraced home
- Lounge with laminate flooring
- uPVC double glazing & fascia
- Nicely presented throughout
- Kitchen/diner
- Phoenix gas central heating
- 3 bedrooms - all with built in storage
- Bathroom
- Gardens to front, side & rear with off street parking to rear.
- Elevated sites with pleasant views.

Entrance

Entrance Hall

Lounge

14x14'2 (4.27mx4.32m)

Kitchen/Diner

17'3x10'2 (5.26mx3.10m)

Landing

Bathroom

6'3x5'6 (1.91mx1.68m)

Bedroom 1

12x10'11 (3.66mx3.33m)

Bedroom 2

10'10x10 (3.30mx3.05m)

Bedroom 3

9'2x8'4 (2.79mx2.54m)

Outside

Tenure

Property Misdescriptions



Directions

From the Newtownards dual carriageway turn into Craigleith Drive (Ballybeen). Turn left into Rosneath Gardens then right into Cairnsmore Avenue and proceed all the way to the end, turning right to where number 29 is on the right.



Floor Plan

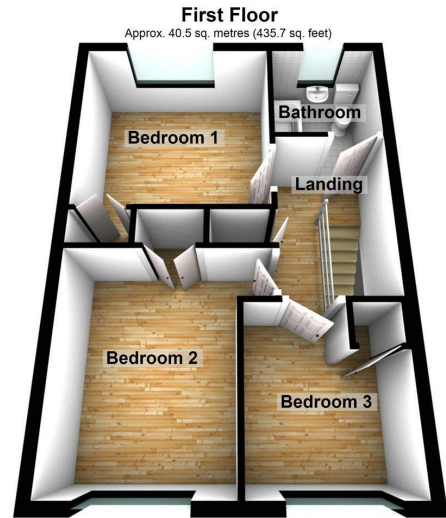
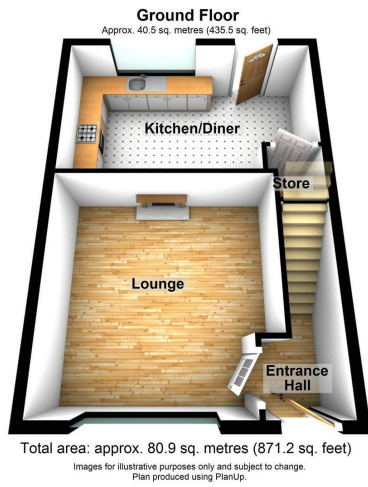

These particulars, whilst believed to be accurate are set out as a general outline only for guidance and do not constitute any part of an offer or contract. Intending purchasers should not rely on them as statements of representation of fact, but must satisfy themselves by inspection or otherwise as to their accuracy. No person in this firm's employment has the authority to make or give any representation or warranty in respect of the property.

