



## 4 THE DRUMLINS Ballynahinch BT24 8HW

- Detached Bungalow
- Garage with Utility Area
- Three Bedrooms
- Family Bathroom
- Living Room with Bay Window
- Kitchen
- Dining Room with feature fireplace
- Well Maintained Gardens
- Convenient Location
- Master bedroom ensuite

Energy Efficiency Rating		Current	Potential
Very energy efficient - lower running costs			
(92 plus) <b>A</b>			
(81-91) <b>B</b>			
(69-80) <b>C</b>			
(55-68) <b>D</b>			
(39-54) <b>E</b>			
(21-38) <b>F</b>			
(1-20) <b>G</b>			
Not energy efficient - higher running costs			
<b>Northern Ireland</b>		EU Directive 2002/91/EC	

**Offers Around £199,950**

## 4 The Drumlins

, Ballynahinch, BT24 8HW



### Entrance Hall

Wooden glazed front door and side panel window leading into bright and spacious entrance hall with wooden laminate flooring.

### Living Room

16'2" x 10'&2 (4.93m x 3.05m&0.61m)  
Bright living room with feature bay window, cornicing and ceiling rose. Mahogany fireplace with tiled inset. Wooden laminate flooring.

### Kitchen

12'7" x 9'3" (3.84m x 2.82m)  
Range of high and low rise units with stainless steel sink and drainer and tiled splash backs. Recess for cooker and dish washer. Space for dining. Tiled floor. Stable style door leading to garage and utility area.

### Utility

15'9" x 10'3" (4.80m x 3.12m)  
Utility area located in garage and accessed from kitchen. Plumbed for washing machine and space for free standing fridge/freezer. Storage units and tiled floor.

### Dining Room / Sitting Room

15'5" x 10'3" (4.70m x 3.12m)  
Feature Inglenook fireplace with feature wooden over mantle. Wooden laminate flooring. Double patio doors to rear.

### Bedroom One

20'5" x 11'4" (6.22m x 3.45m)  
Rear facing. Separate dressing area. Built in wardrobes and storage units.

### Ensuite

White suite comprising low flush w.c, shower and wash hand basin.

### Bedroom Two

11'4" x 9'6" (3.45m x 2.90m)  
Front facing. Built in storage.

### Bedroom Three

8'6" x 8'0" (2.59m x 2.44m)  
Front facing. Built in storage.

### Bathroom

10'8" x 8'8" (3.25m x 2.64m)  
White suite encompassing low flush W/C, wash hand basin and walk in shower. Towel radiator.

### GARAGE

Roller door. Power and light.

### OUTSIDE

To the front - tarmaced driveway with ample space for off street parking. To the rear - paved patio area with stoned areas.



### Directions



# Floor Plan

## Ground Floor

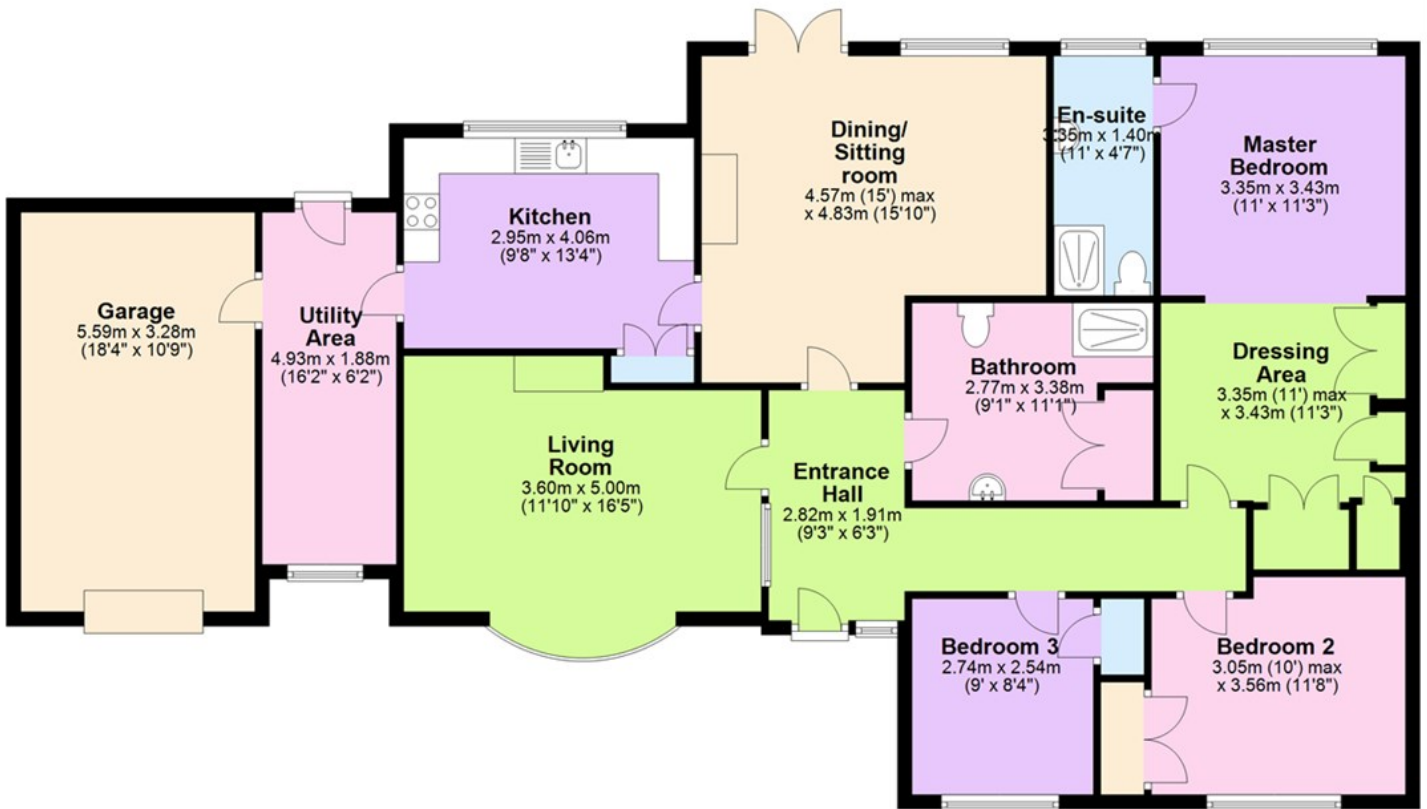

These particulars, whilst believed to be accurate are set out as a general outline only for guidance and do not constitute any part of an offer or contract. Intending purchasers should not rely on them as statements of representation of fact, but must satisfy themselves by inspection or otherwise as to their accuracy. No person in this firm's employment has the authority to make or give any representation or warranty in respect of the property.

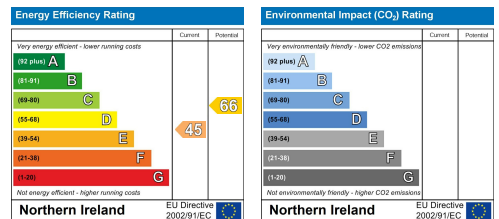

ULSTERPROPERTYSALES.CO.UK

ANDERSONSTOWN  
028 9060 5200

BALLYNAHINCH  
028 9756 1155

CAUSEWAY COAST  
0800 644 4432

FORESTSIDE  
028 9064 1264

NEWTOWARDS  
028 9181 1444

BALLYHACKAMORE  
028 9047 1515

BANGOR  
028 9127 1185

CAVEHILL  
028 9072 9270

GLENGORMLEY  
028 9083 3295

RENTAL DIVISION  
028 9070 1000

BALLYMENA  
028 2565 7700

CARRICKFERGUS  
028 9336 5986

DOWNPATRICK  
028 4461 4101

MALONE  
028 9066 1929



Aaron Ferris trading under licence as Ulster Property Sales (Ballynahinch)  
©Ulster Property Sales is a Registered Trademark