



302 Donegall Road, Belfast, BT12 6FW

Price Guide £120,000

This excellent mid-terrace property with gas fired central heating and double glazed windows offers convenient easy to maintain living close to Belfast City Centre. Bright and spacious throughout the property comprises two good good size bedrooms, comfortable lounge, open plan kitchen / dining area and modern shower suite. Outside there is a small front garden and large enclosed yard to rear. Early viewing is advised to avoid disappointment.

- Spacious Mid-Terrace Property
- Comfortable Lounge
- Modern Shower Suite
- Partial Double Glazed Windows
- Two Good Size Bedrooms
- Open Plan Kitchen / Dining Area
- Gas Fired Central Heating
- Convenient To City Centre

Energy Efficiency Rating		Current	Potential
(92-100)	A		
(81-91)	B		
(69-80)	C		
(55-68)	D	59	69
(39-54)	E		
(21-38)	F		
(1-20)	G		

Not energy efficient - higher running costs

Northern Ireland EU Directive 2002/91/EC

THE ACCOMMODATION COMPRISES

ON THE GROUND FLOOR

ENTRANCE

Hardwood front door.

LIVING ROOM 11'9" x 11'1" (3.6 x 3.4)



Laminate floor. Open fire.

KITCHEN / DINING 16'0" x 14'9" (4.9 x 4.5)



Range of high and low level units, integrated oven, 4 ring electric hob, stainless steel extractor fan, plumbed for washing machine, stainless steel sink unit with drainer, part tiled walls and tiled floor.

ON THE FIRST FLOOR

BEDROOM ONE 15'1" x 9'6" (4.6 x 2.9)



BEDROOM TWO 9'2" x 7'6" (2.8 x 2.3)



SHOWER



White suite comprising wash hand basin with vanity unit, walk in thermostatic shower with rise bar, low flush W.C, fully PVC cladded walls and tile effect floor.

OUTSIDE

Large enclosed yard to rear and storage.

Floor Plan

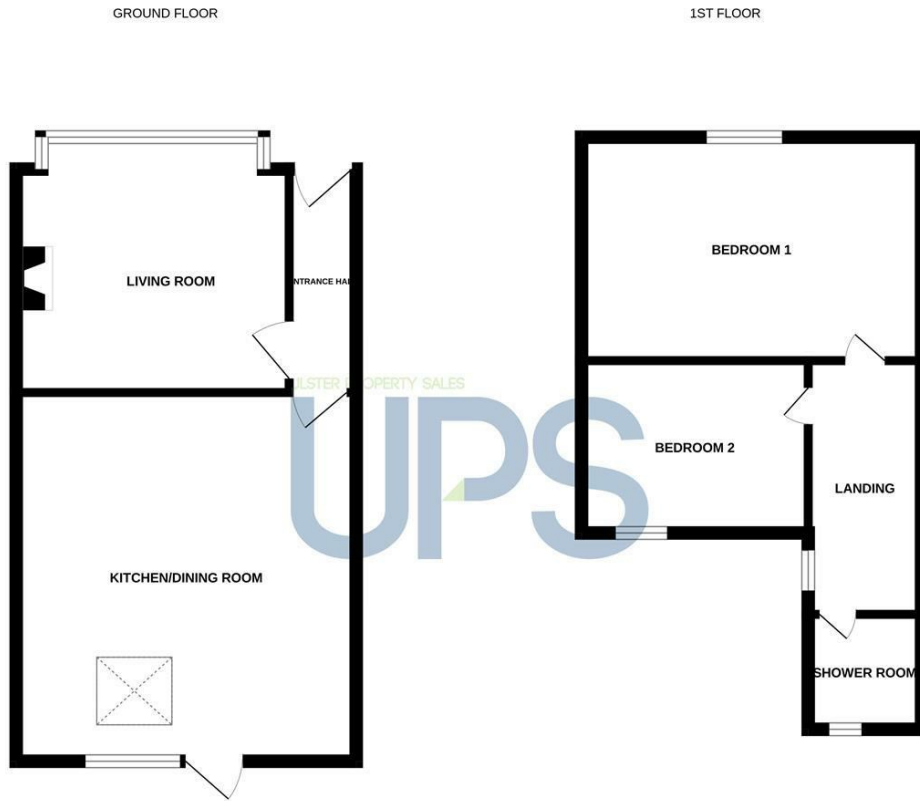

Whilst every attempt has been made to ensure the accuracy of the floorplan contained here, measurements of doors, windows, rooms and any other items are approximate and no responsibility is taken for any error, omission or mis-statement. This plan is for illustrative purposes only and should be used as such by any prospective purchaser. The services, systems and appliances shown have not been tested and no guarantee, as to their operability or efficiency can be given. Made with Metropix ©2024

Area Map



These particulars, whilst believed to be accurate are set out as a general outline only for guidance and do not constitute any part of an offer or contract. Intending purchasers should not rely on them as statements of representation of fact, but must satisfy themselves by inspection or otherwise as to their accuracy. No person in this firm's employment has the authority to make or give any representation or warranty in respect of the property.

ULSTERPROPERTYSALES.CO.UK

- | | | | | |
|--|---------------------------------------|--|-------------------------------------|---|
| ANDERSONSTOWN
028 9060 5200 | BALLYNAHINCH
028 9756 1155 | CAUSEWAY COAST
0800 644 4432 | FORESTSIDE
028 9064 1264 | NEWTOWNARDS
028 9181 1444 |
| BALLYHACKAMORE
028 9047 1515 | BANGOR
028 9127 1185 | CAVEHILL
028 9072 9270 | GLENGORMLEY
028 9083 3295 | RENTAL DIVISION
028 9070 1000 |
| BALLYMENA
028 2565 7700 | CARRICKFERGUS
028 9336 5986 | DOWNPATRICK
028 4461 4101 | MALONE
028 9066 1929 | |



John Thompson trading under licence as Ulster Property Sales (Downpatrick)
©Ulster Property Sales is a Registered Trademark