

**For Sale**  
By Private Treaty

Guide Price  
**€140,000**

**REA**  
**JOHN LEE**



## KILLINURE

Boher, Co. Limerick.

V94 CVX5

3 Bedroom Detached – on c. 0.6 acres

**BER** **G**



[reajohnlee.ie](http://reajohnlee.ie)

PSRA: 002764





## | Location

This property is situated adjacent to Killinure National School and is within easy reach of the University of Limerick, only 20 minutes outside Limerick City with easy access to the N24 and M7 road network. The area is served by a number of primary and secondary schools. Murroe 6km.

## | Description

REA John Lee present to the market this Ideally Situated 3 Bedroom Cottage Residence in a prime location adjacent to Killinure National School. The property requires modernisation throughout yet occupies a spacious site c. 0.6 acres and has the benefit of mains water, electricity, septic tank and oil fired central heating. It is located only 15 minutes from Limerick City centre and in close proximity to the N24 (Tipperary Road). Full Details from the agent.

Services include; Mains ESB, Mains Water, Oil Fired Central Heating, Septic tank. All windows are single glazed.

Built c. 1960. Floor Area c. 60 sq.m.

**Call 061 378 121**



## Ground Floor

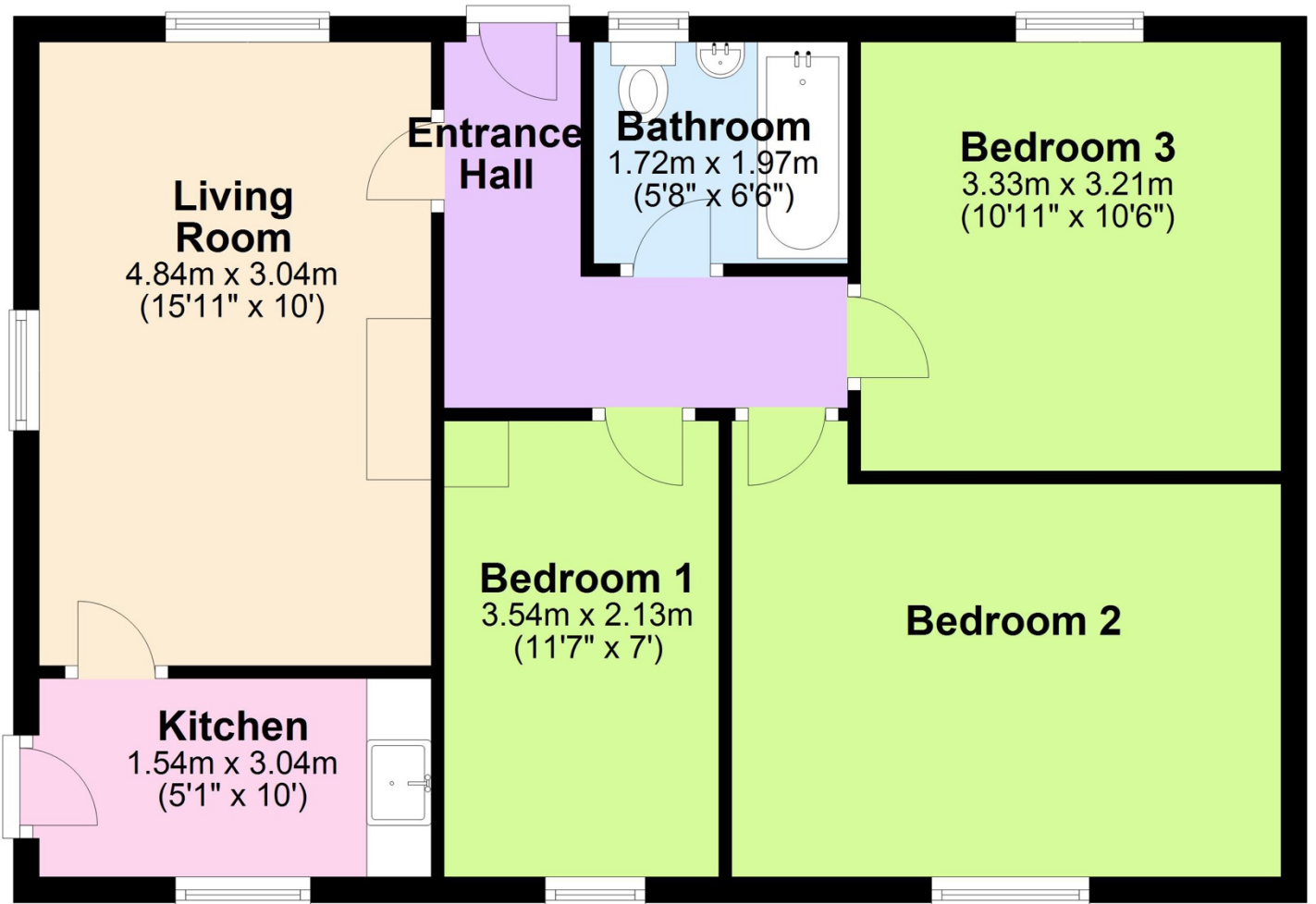

For Identification Purposes Only. Not to Scale.  
Plan produced using PlanUp.



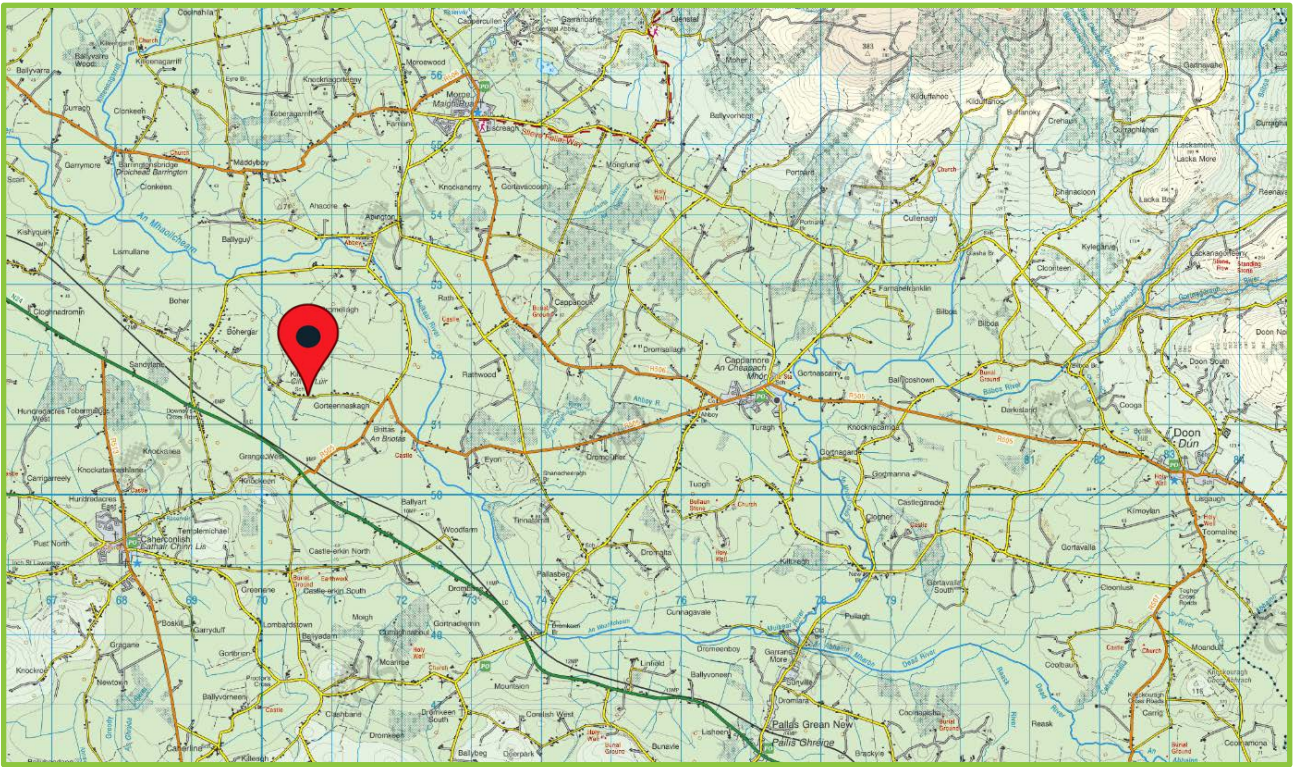

## | Outside

Spacious garden area to the front and rear with detached boiler house.

## | BER

G  
503.38 kWh/m<sup>2</sup>/yr  
BER No. 117026930

## | Viewing

By prior appointment.

## | Directions

Proceed to Killinure National School. The property is immediately adjacent with sign thereon.  
Eircode: V94 CVX5

## | Price

€140,000



## | Selling agents

REA John Lee  
Main Street,  
Newport,  
Co. Tipperary.  
V94 FC8Y

T 061 378121  
E [info@reajohnlee.ie](mailto:info@reajohnlee.ie)  
W [www.reajohnlee.ie](http://www.reajohnlee.ie)

## | Sales agent

James Lee  
BSc. Hon's., MRICS MSCSI  
Director

T (086) 235 1221  
E [james@reajohnlee.ie](mailto:james@reajohnlee.ie)

**CONDITIONS TO BE NOTED:** The terms set out herein are by way of partial summary. Intending purchasers should obtain a copy of the Conditions of Sale where the matters are dealt with comprehensively. Particulars and Conditions of sale are available from the Agents and the Solicitors with carriage of sale. REA John Lee for themselves and for the vendors whose agents they are, give notice that: 1) The particulars are set out in this Brochure and Schedule as a general outline for the guidance of intending purchasers and do not constitute part of an offer or contract. 2) All descriptions, dimensions, references to condition and necessary permissions for the use and occupation and other details are given in good faith and are believed to be correct but any intending purchasers should not rely on them as statements or representations of fact but must satisfy themselves by inspection or otherwise as to the correctness of each of them. 3) No person in the employment of REA John Lee has any authority to make representations or warranty whatsoever in relation to this property. All prices quoted are exclusive of VAT