

To Let

Glenariff Beach Hut, 217 Garron Road, Waterfoot

nre
northern real estate
we value property

Summary

- Unique Opportunity to Occupy a Beach Front Hut / Food Kiosk
- The property is located within a family amenity space in Waterfoot along the beach which has the benefit of both local and tourist trade and uninterrupted panoramic views of our world famous coastline.
- The existing footprint of the building has a NIA of approx c.422 sq ft (c.39.23 sq m).
- The property has been operating as a food kiosk however the property would lend itself to a variety of other commercial uses subject to planning.
- Viewing will be strictly by appointment only

Prime Commercial Food Opportunity

**Rent - Guided at £6,000
per annum**



Lease Details

Rent:

Guided at £6,000 per annum

Term:

Lease Term Negotiable.

Rates:

Tenant Responsible

Insurance:

Landlord to insure the building fabric, tenant to reimburse

Repairs:

Internal Plates Glass & Roller Shutter Repairing

VAT:

All outgoing and rentals are quoted exclusive of but may be liable to VAT

NAV:

£1,150.00

Non-Domestic rate in the £

0.588556

ALL MAPS ARE FOR IDENTIFICATION PURPOSES ONLY

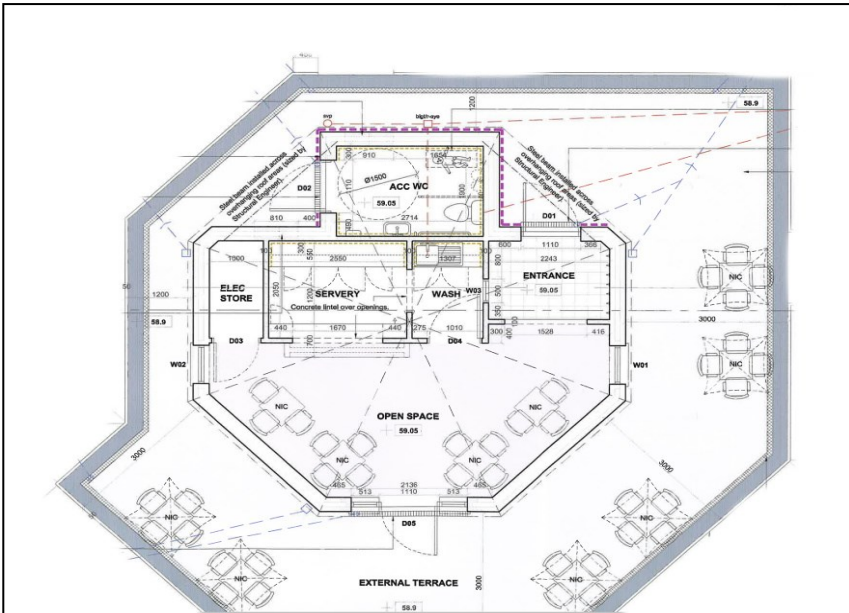

MISREPRESENTATION CLAUSE: Northern Real Estate, give notice to anyone who may read these particulars as follows:

1. The particulars are prepared for the guidance only for prospective purchaser. They are intended to give a fair overall description of the property but are not intended to constitute part of an offer or contract.
2. Any information contained herein (whether in the text, plans or photographs) is given in good faith but should not be relied upon as being a statement of representation or fact.
3. Nothing in these particulars shall be deemed to be a statement that the property is in good condition or otherwise nor that any services or facilities are in good working order.
4. The photographs appearing in these particulars show only certain parts of the property at the time when the photographs were taken. Certain aspects may be changed since the photographs were taken and it should not be assumed that the property remains precisely as displayed in the photographs. Furthermore, no assumptions should be made in respect of parts of the property which are not shown in the photographs.
5. Any areas, measurements or distances referred to herein are approximate only.
6. Where there is reference in the particulars to the fact that alterations have been carried out or that a particular use is made of any part of the property this is not intended to be a statement that any necessary planning, building regulations or other consents have been obtained and these matters must be verified by an intending purchaser.
7. Descriptions of the property are inevitably subjective and the descriptions contained herein are given in good faith as an opinion and not by way of statement of fact.

