



Bond
Oxborough
Phillips

Changing Lifestyles

4 Tremayne House

Park Drive

PL31 2QZ



BRITISH
PROPERTY
AWARDS

2023



GOLD WINNER

ESTATE AGENT
IN WADEBRIDGE
& ROCK



Guide Price - £180,000



Changing Lifestyles

01208 814055

4 Tremayne House, Park Drive, PL31 2QZ



A rare opportunity to acquire a 2 bedroom mid terraced home in the sought after estate of Park Drive.

- Impressive Home
- Two Double Bedrooms
- Family Bathroom
- Stunning views
- Spacious Kitchen/Living Area
- Private Communal Garden
- Off-Road Parking
- Popular Town Location
- Gas Burner
- Council Banding - B
- EPC - C



Presented by Bond Oxborough Phillips is an exceptional grade 2 listed mid terraced home with two bedrooms situated in the sought after estate of Park Drive. This property boasts access to breathtaking communal gardens and designated parking.

As you step into this delightful abode, you are greeted by a capacious hallway area which offers the potential for additional storage space and presents a beautiful staircase. Moving ahead, the stunning open plan kitchen, dining, and living area unfolds. The room features high ceilings which enhance its grandeur. The space is well-illuminated by two large windows that offer natural light, providing the perfect atmosphere to enjoy the space at any time of day. The kitchen comes equipped with an integrated oven and a four-point gas hob, and also features space for a washing machine.



Proceeding to the upper level, you will find a spacious landing that leads to two double bedrooms. The bedrooms feature high ceilings, allowing ample space for big furnishings. Additionally, both bedrooms have suitable built-in wardrobes. The second floor also features storage cupboard and family bathroom with a bath, shower, W/C, and basin.

Externally, this property continues to impress. The designated parking space for the property, along with ample visitor parking spaces, will ensure you never have to worry about parking. The private communal gardens provide an idyllic space to enjoy the stunning Cornish weather. We highly recommend viewing this exceptional home to fully appreciate its splendor.

Changing Lifestyles

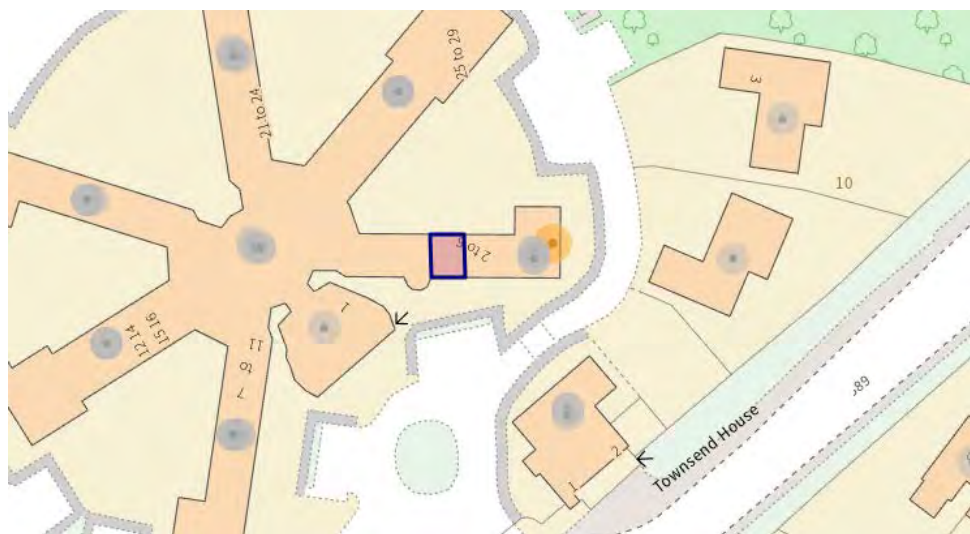

Please do not hesitate to contact the team at Bond Oxborough Phillips Sales & Lettings on **01208 814055** for more information or to arrange an accompanied viewing on this property.

Scan here for our Virtual Tour:





Floor 0

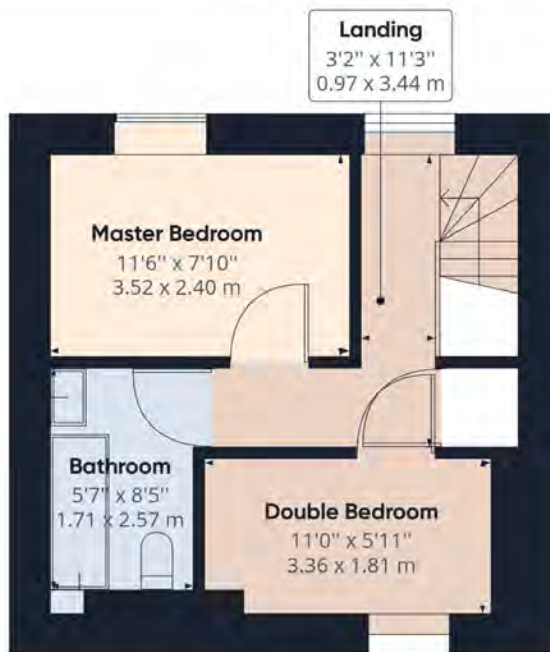

Floor 1

Have a property to sell or let?

If you are considering selling or letting your home, get in contact with us today on 01208 814055 to speak with one of our expert team who will be able to provide you with a free valuation of your home.

We have the facility to refer purchasers and vendors to conveyancing, mortgage advisors and Surveyors. It is your decision if you choose to deal with any of these companies however should you choose to use them we would receive a referral fee from them for recommending you. We will receive a referral fee between £50 - £300 depending on the company & individual circumstances. We have carefully selected these associates for the quality of their work and customer service levels.

Consumer Protection Regulations: We have not tested any apparatus, equipment, fixtures and fittings or services and so cannot verify that they are in working order or fit for the purpose. References to the Tenure of a Property are based on information supplied by the seller. We have not had sight of the Title Documents. A buyer is advised to obtain verification from their solicitor or surveyor. Floorplans shown are for guidance only and should not be relied upon. Items shown in photographs are NOT included unless specifically mentioned within these details. They may however be able by separate negotiation. You are advised to check the availability of this property before travelling any distance to view. Particulars are produced in good faith to the best of our knowledge and are set out as a general guide only.