



485 Lisburn Road, Belfast, BT9 7EZ
Tel: 02890 661111
Email: info@fetherstons.com
Web: www.fetherstons.com

505 Bradbury Court
Jubilee Road
BT9 7JL

Offers In Region Of £124,950

505 BRADBURY COURT, JUBILEE ROAD, BT9 7JL

- **Superb 5th Floor Apartment**
- **Two Bedrooms**
- **Open Plan Living/Kitchen/Dining Area**
- **Bathroom with Matching Suite**
- **Double Glazed Windows/Gas Central Heating/Extremely Well Presented Throughout**
- **Entrance Gates to Allocated Residents and Visitor Parking**
- **Exceptional Views of South Belfast and Lagan Valley**
- **Convenient to Belfast City and Royal Victoria Hospitals**
- **Close Train Station, Transport Links and Queens University**
- **Ideal for Investors or Owner Occupiers**

Bradbury Court is a highly popular and extremely convenient apartment development located beside Belfast City Hospital just off Lisburn Road and close to Belfast City centre and Queens University.

The property is very close to Belfast City Hospital train station, Queens University and Botanic Gardens and the Royal Victoria Hospital is also in walking distance.

This particular apartment is ideally located on the 5th floor with a Southerly aspect providing an abundance of natural light into all the principle rooms.

The accommodation centres around the living/dining area which is open plan to the kitchen. In addition, there are two bedrooms and a main bathroom. There is also access via electric gates to residents and visitor parking.

This property will appeal to owner occupiers and investors and can only be fully appreciated on internal inspection.







PROPERTY COMPRISES

COMMUNAL ENTRANCE LOBBY Lift and stairs to...

5TH FLOOR LANDING Hardwood entrance door leading to...

ENTRANCE HALL Laminate wood strip flooring.

OPEN PLAN LIVING/DINING/KITCHEN AREA 17' 8" x 16' 6" (5.4m x 5.03m) Kitchen with range of fitted high and low level units, Granite effect worksurfaces, tiled splashback, single drainer stainless steel sink unit with mixer taps, extractor fan, gas fired boiler.

BEDROOM 10' 11" x 9' 0" (3.35m x 2.75m) Laminate wood strip flooring, storage cupboard.

BEDROOM 9' 8" x 8' 11" (2.97m x 2.73m) Laminate wood strip flooring.

BATHROOM Panelled bath with electric shower, low flush wc, pedestal wash hand basin, tiled splashback, uPVC tongue and groove panelled ceiling.





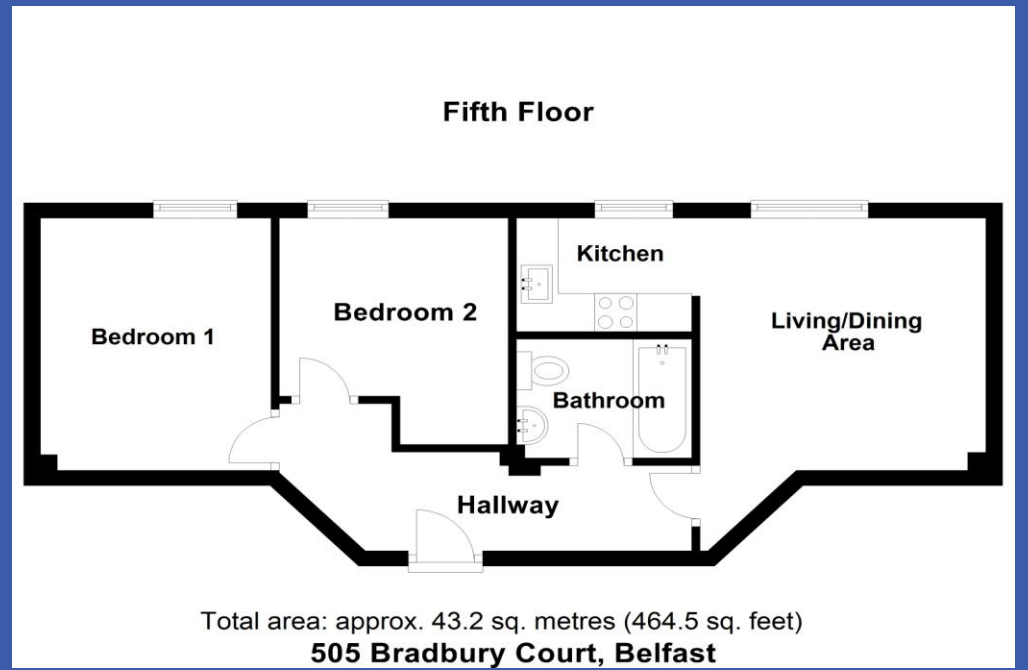

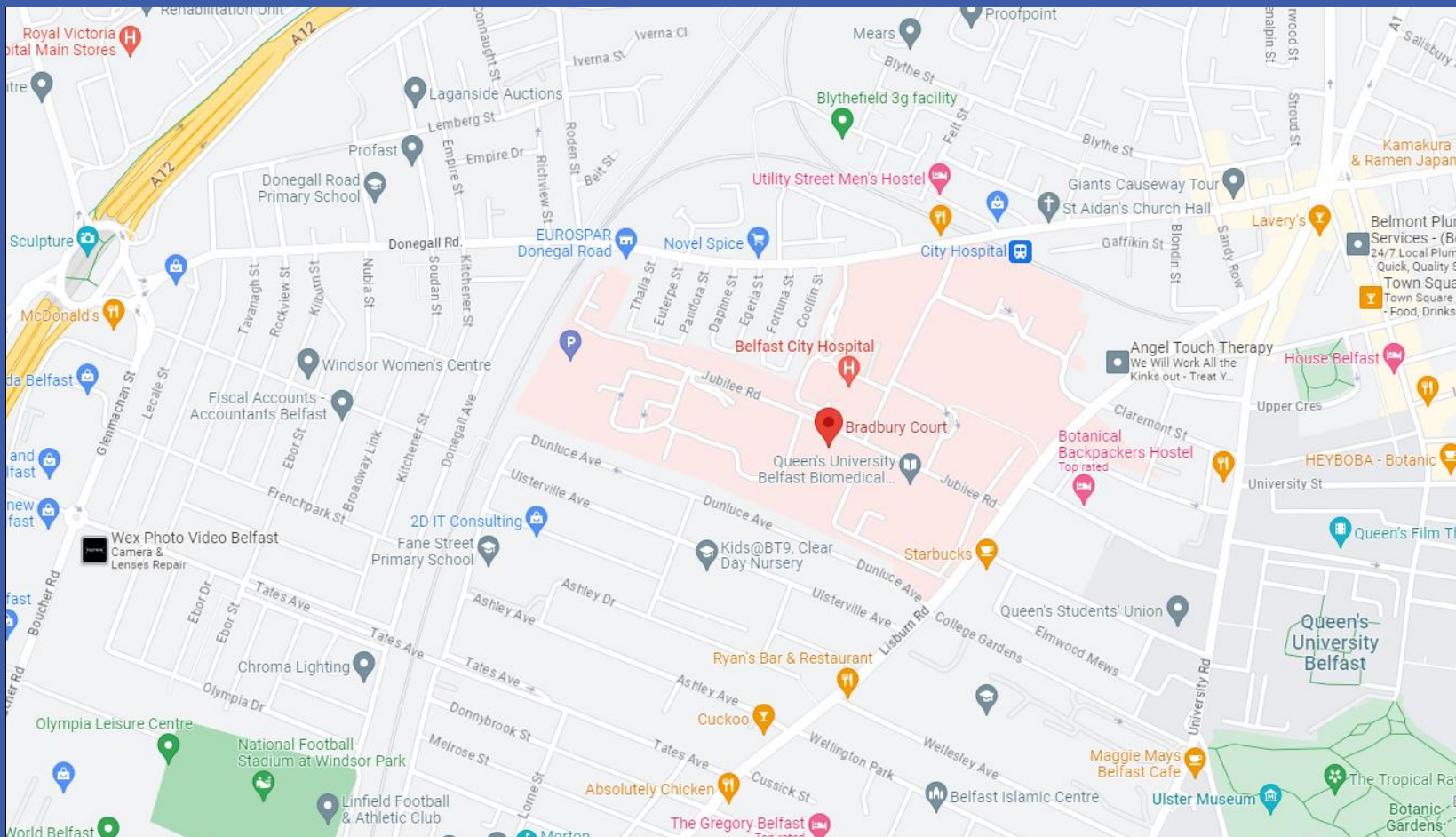

Directions: Please find map attached above.

Score	Energy rating	Current	Potential
92+	A		
81-91	B		
69-80	C	75 C	79 C
55-68	D		
39-54	E		
21-38	F		
1-20	G		



Fetherston Clements Estate Agents for themselves and for the Vendors or Lessors of the property whose agents they are give notice that; i) these particulars are given without responsibility of Fetherston Clements or the Vendors or Lessors as a general outline only, for the guidance of prospective purchasers or tenants, and do not constitute the whole or any part of an offer or contract; ii) Fetherston Clements cannot guarantee the accuracy of any description, dimensions, references to condition, necessary permissions for the use and occupation and other details contained herein and any prospective purchasers or tenants should not rely on them as statements of representation of fact but must satisfy themselves by inspection or otherwise as to the accuracy of each of them; iii) no employee of Fetherston Clements has authority to make or give any representation or warranty or enter into any contract whatsoever in relation to the property; iv) VAT may be payable on the purchase price and / or rent, all figures are quoted exclusive of VAT, intending purchasers or tenants must satisfy themselves as to the applicable VAT position, if necessary by taking the appropriate professional advice; v) Fetherston Clements will not be liable in negligence or otherwise, for any loss arising from the use of these particulars; vi) Appliances not tested or verified.