

Tim Martin
— .co.uk



**23 Ballydrain Road
Comber
BT23 5SR**

**Guide Price
£700,000**

www.timmartin.co.uk
Telephone 028 91 878956

SUMMARY

FOR SALE AS A WHOLE OR IN LOTS

A gracious country residence set in it's own grounds extending to almost 20 acres situated to either side of the country road and include an area of salt marsh fronting onto Strangford Lough.

The spacious home includes 3 reception rooms, 4 bedrooms, farmhouse kitchen with adjoining laundry room with principal bathroom and shower room over two floors. The property is fitted with oil fired central heating and double glazing.

Externally, a fine range of stabling, tack room, forage storage and range of stores provide exceptional facilities for those with equestrian interests. A turnout paddock situated adjacent to the stabling with the agricultural lands surrounding the residence and stables.

Situated 1.5 miles from Comber Square this fine home combines peaceful rural living with the convenience of excellent local amenities in the town.

Comber boasts a host of local boutiques, coffee shops, restaurants, and the local farmer's market. The Comber Greenway provides beautiful cycles and walks into Belfast city centre, whilst Castle Espie and Strangford Lough are all within close proximity. For those wishing to commute, the neighbouring towns of Newtownards, Killinchy and Dundonald are only a short drive away, as too is Belfast city airport, Ulster Hospital and Belfast city centre.

FEATURES

- Country Residence Set in it's Own Grounds Extending to Under 20 acres
- Dining Room, Living Room and Conservatory
- 4 Bedrooms
- Farmhouse Kitchen and Laundry Room
- Bathroom and Separate Shower Room
- Oil Fired Central Heating & Double Glazing
- Stables and Storage
- Turn Out Paddock
- Circa 20 acres

Reception Hall 11'4 x 8'7 (3.45m x 2.62m)

Cedar tongue and groove ceiling.

Hallway 9'7 x 7'10 (2.92m x 2.39m)

Stained wood floor.

Dining Hall 16'2 x 13'11 (4.93m x 4.24m)

Stained wood floor; French door to conservatory; corniced ceiling; Myson convector radiator.

Shower Room 10'1 x 5'1 (3.07m x 1.55m)

White suite comprising tiled shower with thermostatically controlled shower and Redring electric shower, glass sliding door and soap recess; pedestal wash hand basin; close coupled wc; part tiled walls; electric shaver socket; mirror fronted bathroom cabinet.

Drawing Room 19'8 x 15'5 (5.99m x 4.70m)

Feature inglenook fireplace with Rayburn fire on tiled hearth, Adam style hardwood chimney piece; corniced ceiling; tv aerial connection point; stained pine floor; skirting radiators.

Family Room 14'2 x 11'10 (4.32m x 3.61m)

Stone fireplace and hearth with hardwood surround; built in bookshelves; French door to conservatory.

Conservatory 24'0 x 7'10 (7.32m x 2.39m)

PVC tiled floor; twin doors to rear garden.

Kitchen 14'4 x 14'1 (4.37m x 4.29m)

Twin tub single drainer stainless steel sink unit with mixer taps; good range of painted eye and floor level cupboards and drawers; formica worktops; integrated Belling double ovens and four ring ceramic hob, pull out canopy with Xpelair extractor fan over; space for dishwasher; part tiled walls.

Laundry Room 15'8 x 8'9 (4.78m x 2.67m)

Single drainer stainless steel sink unit with mixer taps; range of eye and floor level cupboards and drawers; formica worktops; built in broom cupboard; boiler cupboard with Grant condensing oil fired boiler; fluorescent light.

First Floor / Landing**Bedroom 1 15'6 x 13'2 (4.72m x 4.01m)**

Vanity unit with fitted wash hand basin and chrome mono mixer tap; cupboards under; mirrored front bathroom cabinet over; two reading lights.

Bedroom 2 11'11 x 11'1 (3.63m x 3.38m)

Pedestal wash hand basin; fitted mirror, light and shaver socket over.

Bedroom 3 11'4 x 6'2 (3.45m x 1.88m)**Bathroom 8'11 x 7'9 (2.72m x 2.36m)**

White suite comprising panel bath with mixer taps and telephone shower attachment; pedestal wash hand basin with strip light and shaver socket over; close coupled wc; PVC tiled floor; tiled walls.

Bedroom 4 15'4 x 8'9 (4.67m x 2.67m)**Stairs to Roofspace****Roofspace 20'0 x 6'10 (6.10m x 2.08m)**

Floored; light points.

Outside

Sweeping bitmac drive to spacious bitmac parking to front of residence leading to concrete parking to side and rear.

Range of Outbuildings including:-**Garden Store 13'0 x 7'3 (3.96m x 2.21m)**

Light and power points.

Garage 14'3 x 11'10 (4.34m x 3.61m)

Light point; double doors.

Store 13'1 x 7'1 (3.99m x 2.16m)

Light point with water filtration unit serving swimming pool (untested)

Stable Block 45'8 x 28'4 (13.92m x 8.64m)

Subdivided into 4 looseboxes (12' x 10' approx); built in feed pots; tack room (10'3 x 8'0) with built in glazed cupboard, saddle and bridle racks, fluorescent light and power points; twin forage storage area; fluorescent lights; sliding door and pedestrian doors to rear.

Swimming Pool 40'15 approx (12.19m approx)

With filtration plant (untested)

Summer House 8'7 x 7'7 (2.62m x 2.31m)

Gardens

Spacious gardens to front, sides and rear laid out in rolling lawns and planted with a fine range of ornamental and flowering shrubs.

Railed Turnout Paddock

Laid down to grass.

Agricultural Lands

The lands are subdivided into convenient sized fields and are mostly laid down to grass with one field in winter cereal. The lands are substantially level and provide grazing and are thought equally suitable for cutting and / or arable crops.

The lands include an area of salt marsh fronting onto Strangford Lough and are a haven for a wide range of native and visiting water fowl and waders.

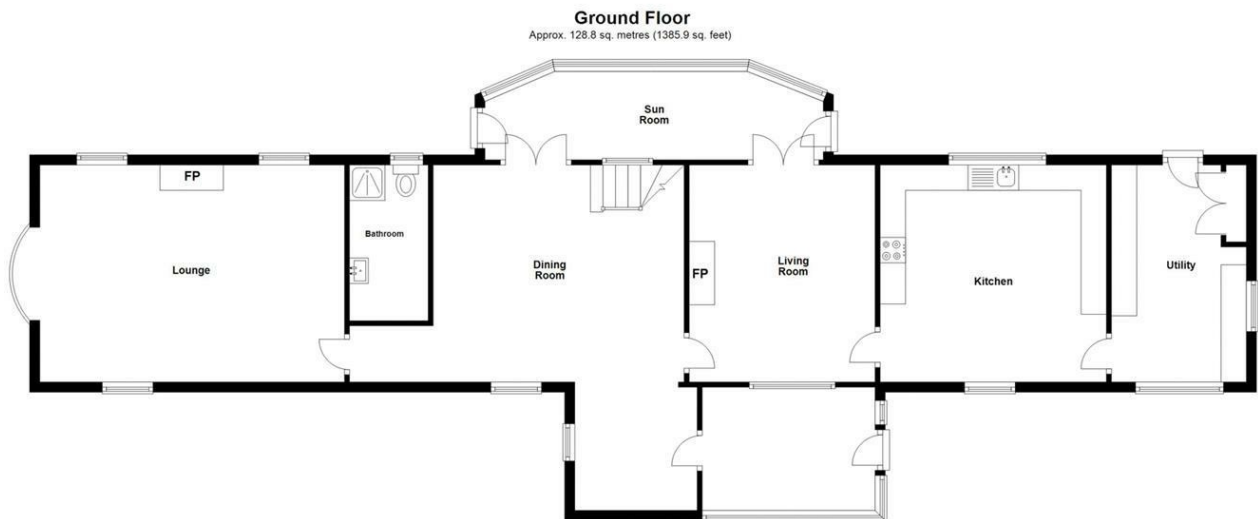

Total area: approx. 183.6 sq. metres (1975.9 sq. feet)

Photography and Floor plans by housefyndi.co.uk #fyforthewallpropertymarketing
Plan produced using PlanUp.

23 Ballydrain Road, Comber









Energy Efficiency Rating		Current	Potential
Very energy efficient - lower running costs			
(92 plus) A			
(81-91) B			
(69-80) C			
(55-68) D			
(39-54) E			
(21-38) F			
(1-20) G			
Not energy efficient - higher running costs			
		62	31

Comber
 27 Castle Street, Comber, BT23 5DY
 T 028 91 8789596

Saintfield
 1B Main Street, Saintfield, BT24 7AA
 T 028 97 568300

Tim Martin & Company for themselves and for the vendors of this property have endeavoured to prepare these sales details as accurate and reliable as possible for the guidance of intending purchasers or lessees. These particulars are given for general guidance only and do not constitute any part of an offer or contract. The seller and us as agents, do not make any representation or give any warranty in relation to the property. We would recommend that all information contained in this brochure about the property be verified by yourself or professional advisors. Services, fittings and equipment referred to in the sales details have not been tested (unless otherwise stated) and no warranty will be given as to their condition. All measurements contained within this brochure are approximate. Please contact us prior to viewing the property. If there is any point of particular importance to you we would be pleased to provide additional information or make further enquiries. We will also confirm that the property remains available. This is particularly important if you are contemplating travelling some distance to view the property.