



This is an excellent opportunity for those with an equestrian background or are simply looking to purchase grazing land.

The sale includes c.12.25 acres of agricultural land with road frontage and further access from laneway.

Asking Price
£215,000

Land @ 37
Ballyknockan Road,
Ballygowan,
Newtownards,
BT23 6NR

Viewing by
appointment
through agent
028 9066 3030



- Circa 12.25 acres of agricultural land suitable for grazing
 - Benefitting from road frontage and stone lane
 - Ideal for someone with equestrian background
 - Freehold site
 - Close to both Saintfield and Ballygowan

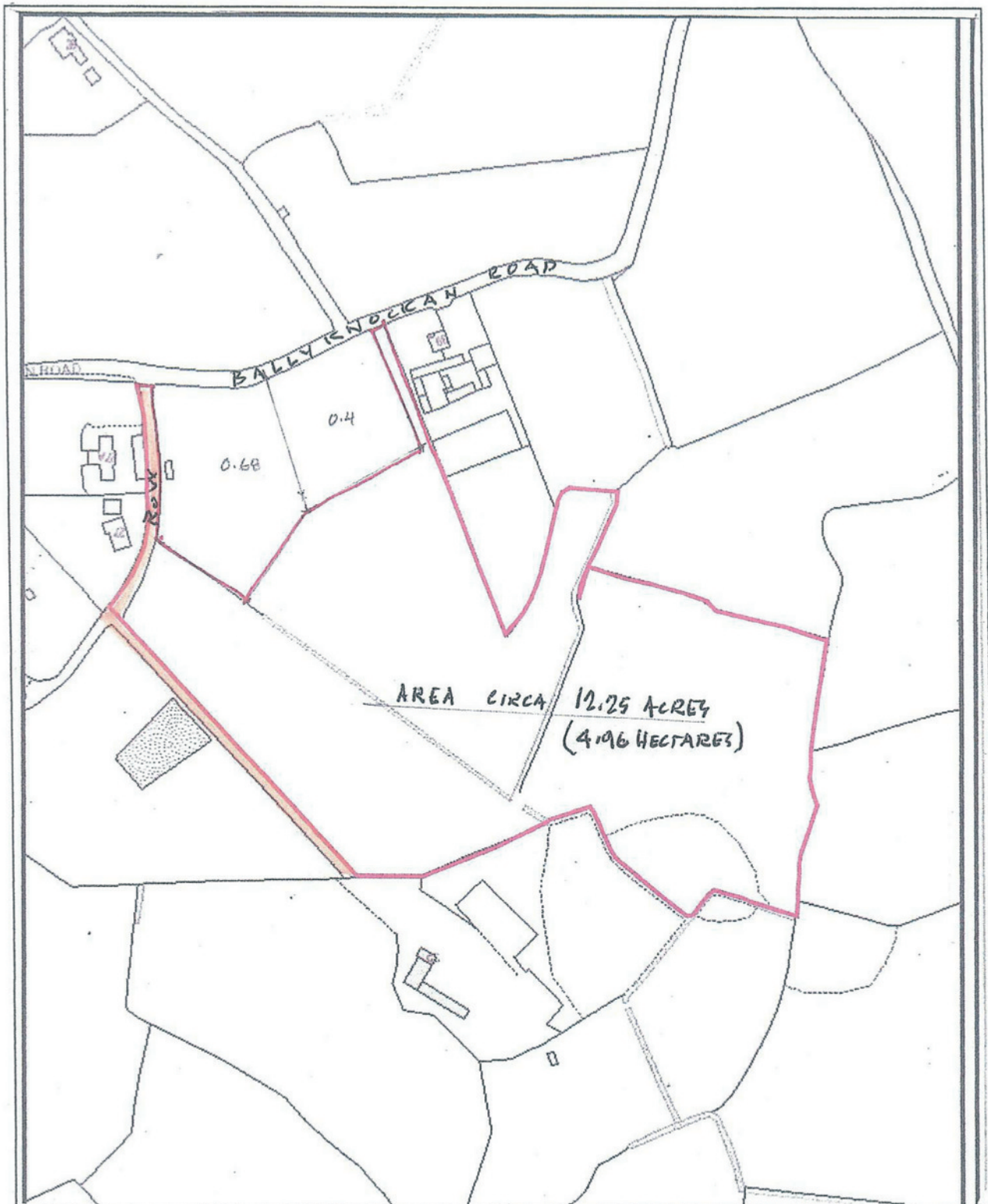

GTDesign Architectural Planning & Surveying Consultants	10 Ballybeen Road Moneyreagh Comber County Down BT23 5PY T: 028 90 813 784 E: info@gtdesign.biz	Description LOCATION MAP			
		Drawn	Job TRANSFER OF LAND AT BALLYKNOCKAN ROAD BALLYKNOCKAN BALLYGOWAN		
		Date			
		Checked			
Principal : Gary Thompson MRICS MCIQB MCABE FIBE		Date April 23	Scale 1-2500	Drawing No. 2318-02	Rev No.

Lisburn Road - 028 90 66 3030
Ballyhackamore - 028 90 65 0000
Lisburn - 028 92 66 1700
North Down - 028 90 42 4747
www.templetonrobinson.com

These particulars do not constitute any part of an offer or contract. None of the statements contained in these particulars are to be relied on as statements or representations of fact and intending purchasers must satisfy themselves by inspection or otherwise to the correctness of each of the statements contained in these particulars. The Vendor does not make or give, neither Templeton Robinson, nor any person in its employment has any authority to make or give, any representation or warranty whatever in relation to this property. All dimensions are taken to nearest 3 inches.

