

# theboat<sup>o</sup>

GRADE A OFFICE SPACE - TO LET

Queens Square, Belfast, BT1 3FG

**CBRE NI**  
PART OF THE AFFILIATE NETWORK



**THE BOAT, QUEENS SQUARE, BELFAST, BT1 3FG**

**CBRE NI**  
PART OF THE AFFILIATE NETWORK

**The Boat is an iconic Grade A office building benefiting from panoramic views over Belfast City Centre, the River Lagan and Belfast Lough. Space available from 1,453 to 4,090 square feet per floor.**





## LOCATION

The Boat is situated in a very prominent location within the extremely popular business and leisure area of the city centre. It is within a short walk of the prime city centre retail core and close to Lanyon Place Train Station. Further benefits include being conveniently located adjacent to the glider stop and within close proximity of Laganside Bus Station and GoPark, a 282 space car park located at Donegall Quay.



2 minute walk from Laganside Bus Centre



12 minute walk to Lanyon Place Train Station



Glider stop immediately adjacent on Queens Square



George Best Belfast City Airport is within a 5 minute drive



M1 & M2 motorways are accessed within 10 minutes



Belfast bike dock located on the adjacent public realm beside The Big Fish



A number of hotels are located within a 5 minute walk



Numerous coffee shops within a 5 minute walk



4 minute walk to Better Gym Belfast

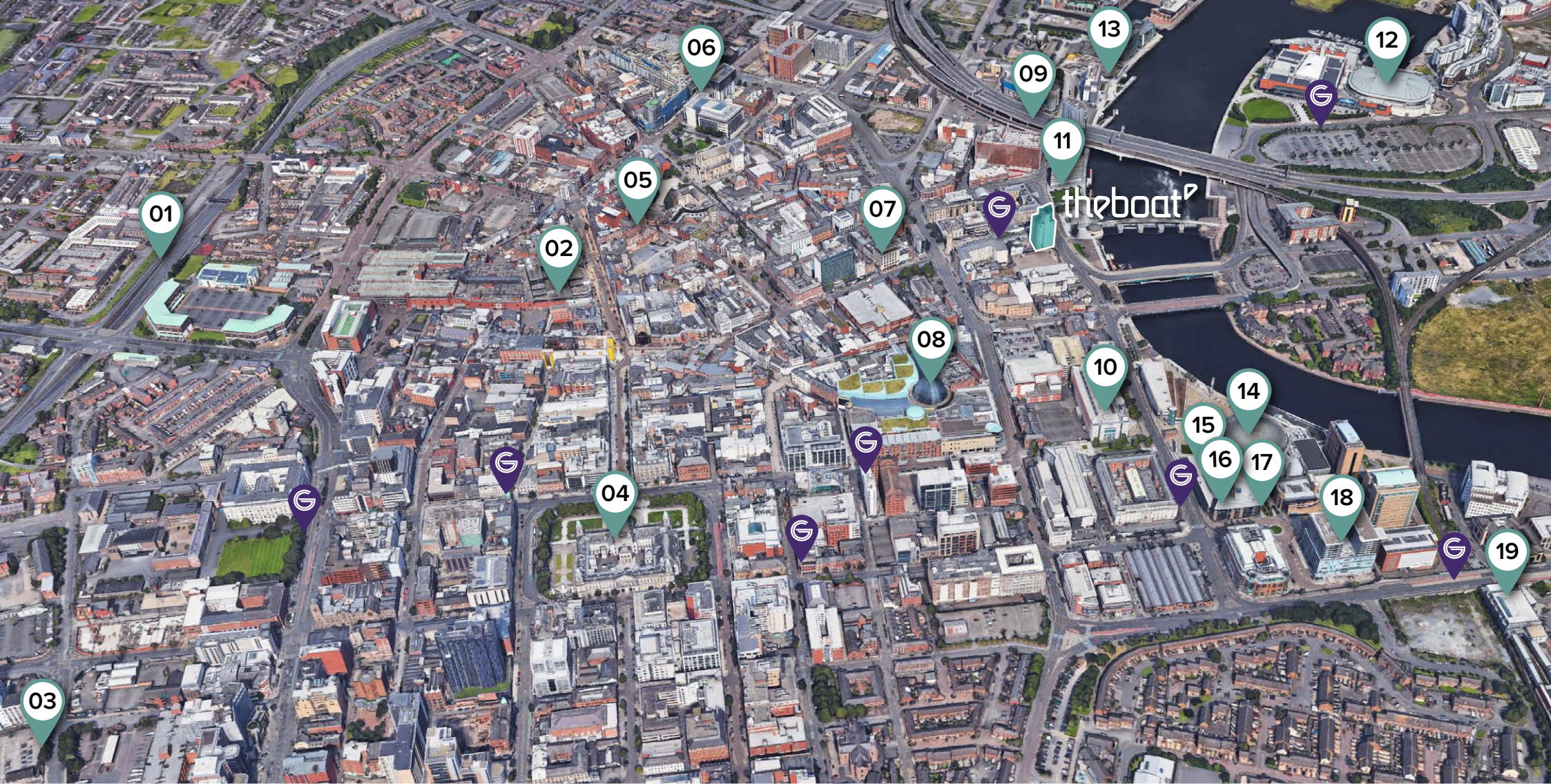

theboat

01. Westlink

02. CastleCourt

03. Weavers Cross Transport Hub

04. City Hall

05. Tribeca

06. Ulster University

07. Cathedral Quarter

08. Victoria Square

09. M3 Motorway

10. Laganside Court

11. Allen & Overy

12. Odyssey Pavilion

13. Baker McKenzie

14. ICC

15. KPMG

16. Bank of London

17. Pinsent Masons

18. Land & Property Services

19. Lanyon Plaza

 Glider



## THE BUILDING

The Boat is a 14 storey building comprising 9 floors of offices and 8 luxury apartments with all floors having floor to ceiling glazing, maximising the views.

Current occupiers within The Boat include Staffline Recruitment, Codec, Mott MacDonald, the Bar Library and the British Council.

### Key Attributes

- Highly glazed office environment with curtain walling extending from floor to ceiling
- Excellent natural light
- Solar shading, timber louvered façade to the River Lagan
- Double height entrance foyer with two high speed passenger lifts
- Male and Female WC's on each floor
- Plastered and painted walls
- Raised access flooring
- Individual ventilation comfort cooling/heating on each floor
- Suspended ceiling with integrated CAT 2 lighting
- External balconies on each floor

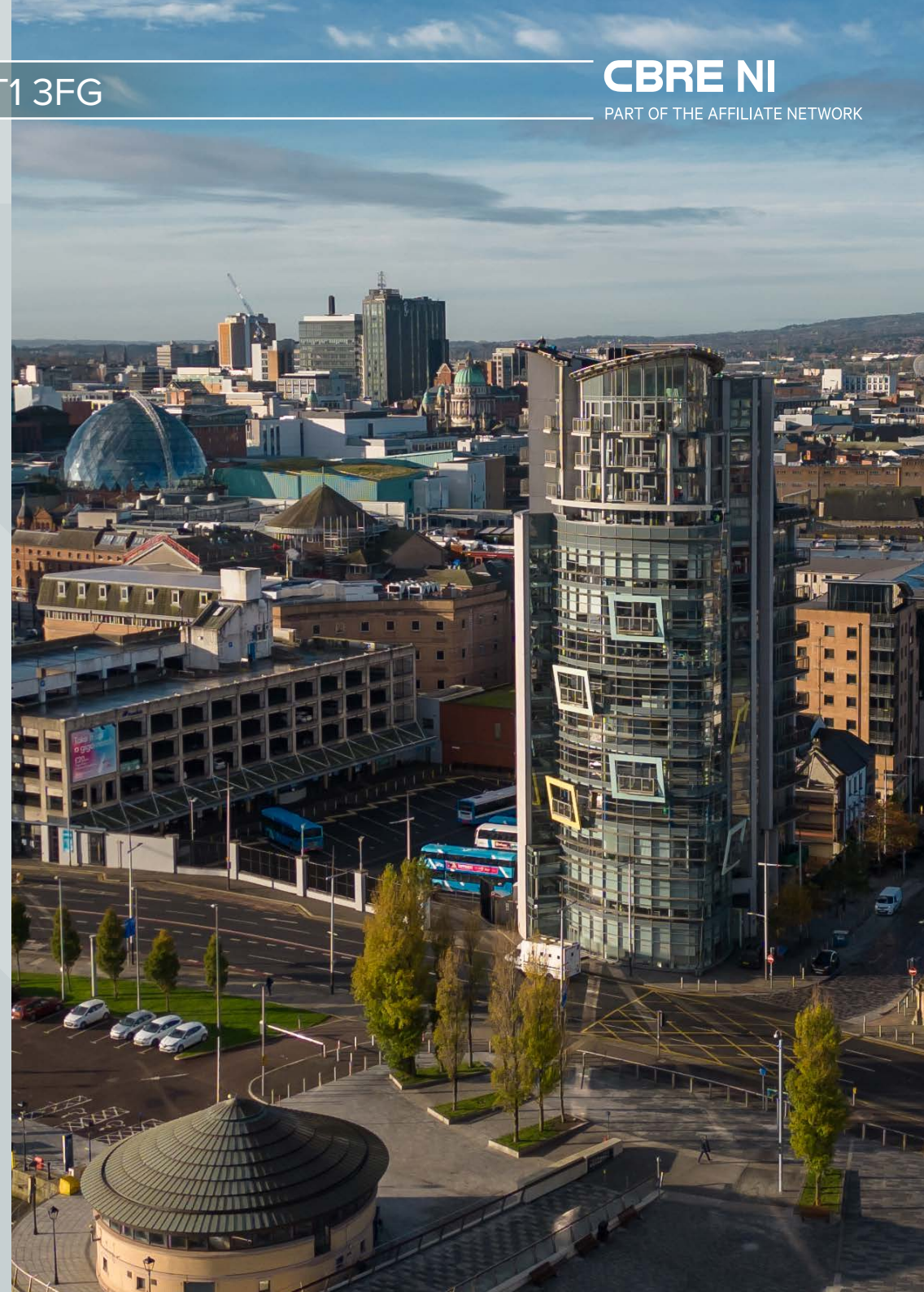



# ACCOMMODATION

	THE BOAT	THE LIFEBOAT	TOTAL
Third Floor	2,637 Sq Ft	1,453 Sq Ft	4,090 Sq Ft
Fourth Floor	Occupied	1,453 Sq Ft	1,453 Sq Ft
Eighth Floor	Occupied	1,453 Sq Ft	1,453 Sq Ft
<b>Total</b>	<b>2,637 Sq Ft</b>	<b>4,359 Sq Ft</b>	<b>6,996 Sq Ft</b>

\* All areas being approximate

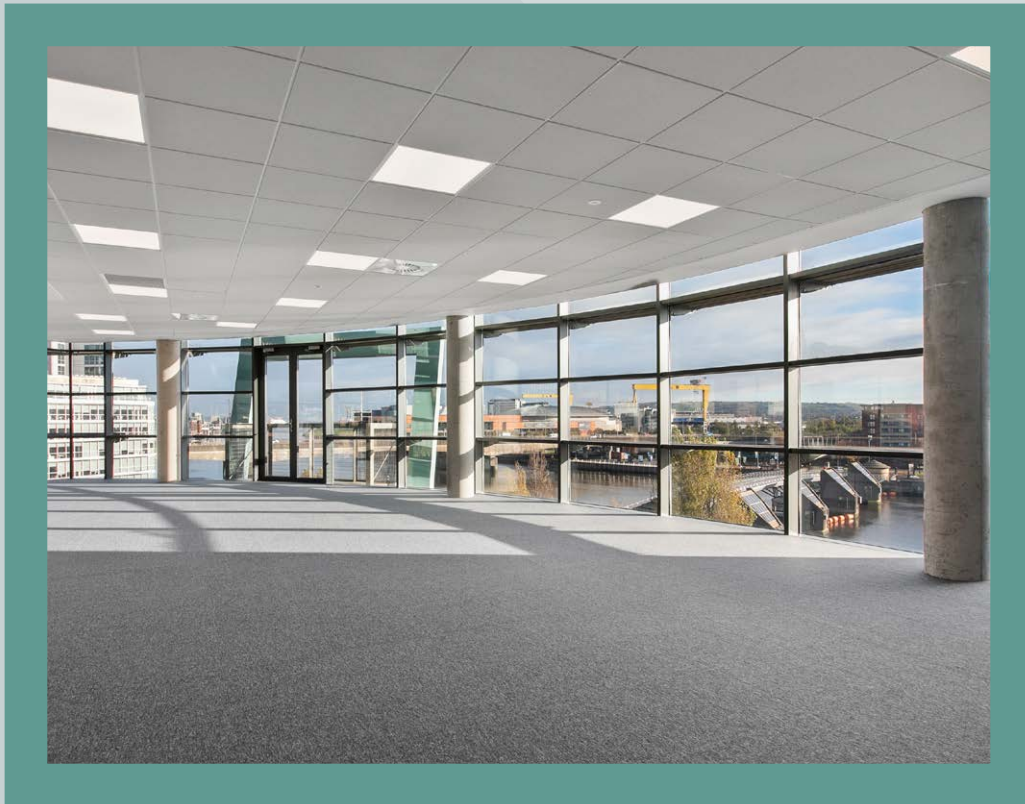



# THE BOAT, QUEENS SQUARE, BELFAST, BT1 3FG

**CBRE NI**  
PART OF THE AFFILIATE NETWORK





## ADDITIONAL INFORMATION

### Term

10 years

### Rent

£19.50 per sq ft, per annum, exclusive.

### Plug & Play

All suites are available on a fully furnished plug and play basis. Further details upon request.

### Rent Reviews

5 yearly

### Repairs

Effective FRI terms through a service charge. A service charge will be levied on a pro-rata basis to cover communal services, external repairs etc. The service charge is currently estimated to be £3.35 per sq ft.

### Rates

Rates payable for 2023/24 is estimated at £7.93 per sq ft.

### VAT

The building is elected for VAT and therefore VAT will be payable on all outgoings.

### Energy Performance Certificates

Area	EPC Rating
Entire - Third Floor	C63
Entire - Fourth Floor	C56
Entire - Eighth Floor	C60

EPC certificates available upon request.





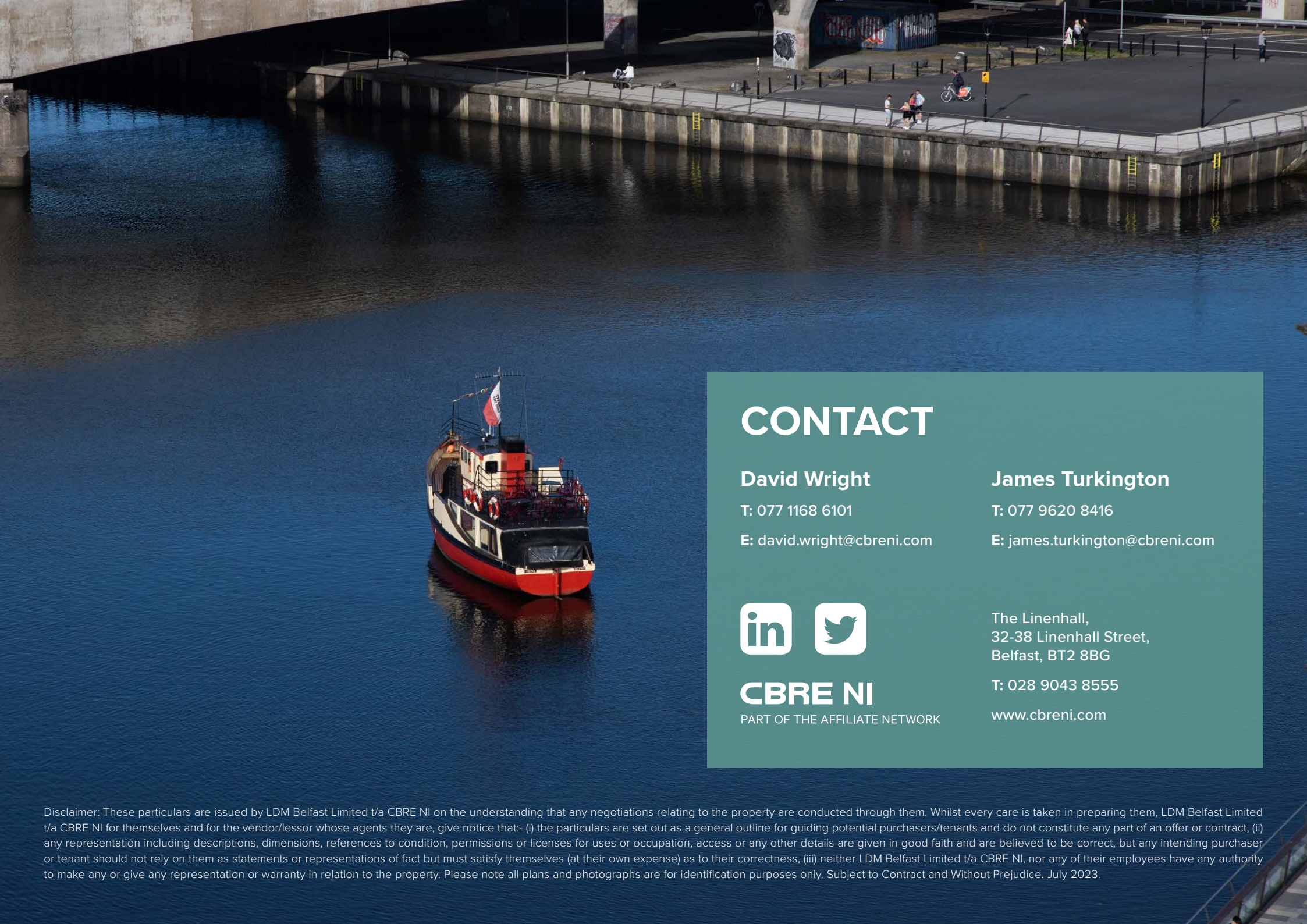

## CONTACT

**David Wright**

T: 077 1168 6101

E: david.wright@cbreni.com

**James Turkington**

T: 077 9620 8416

E: james.turkington@cbreni.com



**CBRE NI**

PART OF THE AFFILIATE NETWORK

The Linenhall,  
32-38 Linenhall Street,  
Belfast, BT2 8BG

T: 028 9043 8555

[www.cbreni.com](http://www.cbreni.com)

Disclaimer: These particulars are issued by LDM Belfast Limited t/a CBRE NI on the understanding that any negotiations relating to the property are conducted through them. Whilst every care is taken in preparing them, LDM Belfast Limited t/a CBRE NI for themselves and for the vendor/lessor whose agents they are, give notice that:- (i) the particulars are set out as a general outline for guiding potential purchasers/tenants and do not constitute any part of an offer or contract, (ii) any representation including descriptions, dimensions, references to condition, permissions or licenses for uses or occupation, access or any other details are given in good faith and are believed to be correct, but any intending purchaser or tenant should not rely on them as statements or representations of fact but must satisfy themselves (at their own expense) as to their correctness, (iii) neither LDM Belfast Limited t/a CBRE NI, nor any of their employees have any authority to make any or give any representation or warranty in relation to the property. Please note all plans and photographs are for identification purposes only. Subject to Contract and Without Prejudice. July 2023.