

9261 2121  
stewartstateagents.com

**stewart**  
residential



**23 LINENFIELDS**

Lenaderg Banbridge BT32 4RX

Offers around  
**£159,950**









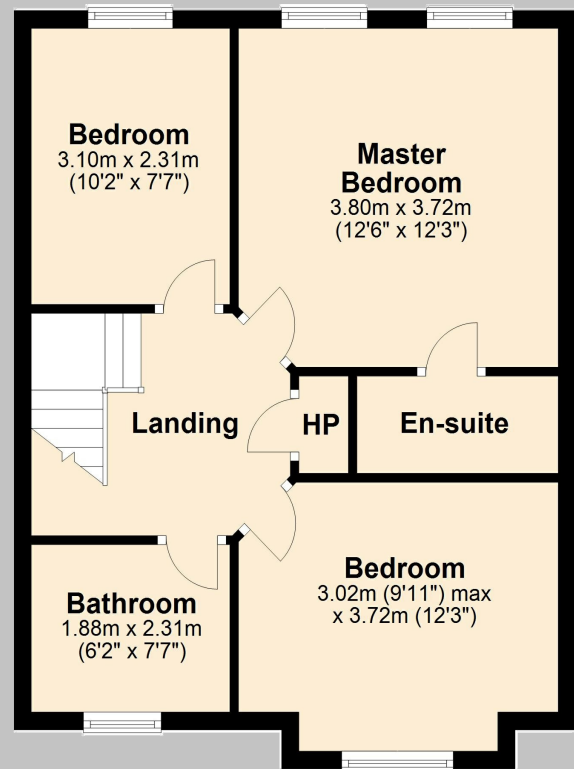
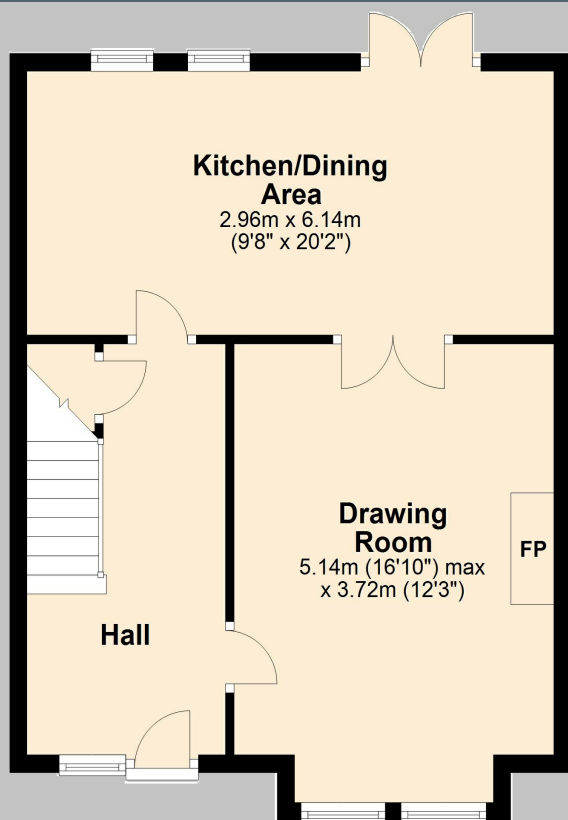

Please Note: Floorplans are for identification purposes only. Measurements are approximate and are taken using a laser measuring device.

## Description

A very charming semi-detached home having a wonderful architectural style, nestling within a much admired development just off the Huntly Road, convenient to the main Lurgan Road for Banbridge and the A1 carriageway, Banbridge Academy, Gilford, Portadown, Waringstown and Lurgan.

The property has a good interior layout including three spacious bedrooms with an en suite shower room, elegant drawing room with feature fireplace and an open plan kitchen with dining room. Viewing a must!

## Features

- Charming semi-detached home in a beautiful residential cul-de-sac
- Three spacious bedrooms, master bedroom with en suite shower room
- Bright entrance hallway with stairs to the first floor accommodation
- Drawing room with attractive front windows and feature fireplace
- Open plan kitchen and dining room with a generous range of fitted high and low level units
- Driveway to the front for off street parking
- Rear concrete patio area and garden area
- PVC double glazed windows
- Oil fired central heating

Score	Energy rating	Current	Potential
92+	A		
81-91	B		
69-80	C		
55-68	D	61 D	67 D
39-54	E		
21-38	F		
1-20	G		

These particulars do not constitute any part of an offer or contract. None of the statements contained in these particulars are to be relied on as statements or representations of fact and intending purchasers must satisfy themselves by inspection or otherwise to the correctness of each of the statements contained in these particulars. The vendor does not make or give, and neither Stewart Estate Agents, nor any person in its employment has any authority to make or give, any representation or warranty whatever in relation to this property. Stewart Estate Agents has not tested any equipment, apparatus, fittings or services and cannot verify that these are in working order.