



Site with FPP 10 Plantation Road, Garvagh

Replacement dwelling & garage
Including circa 6.4 acres of land

Site at 10 Plantation Road Garvagh,



SITE WITH PLANNING APPROVAL

Located in a private rural environment, this site extends to circa 6.4 acres, which includes access from the Planation Road. Ideally situated on the fringes of Garvagh Forest this site boasts stunning surroundings, located circa 1 mile from Garvagh.

The Building Site has Full Planning Approval for a two storey dwelling , extending to circa 2,000 sq ft and domestic double garage.

Plans will be available to the Purchaser.



Planning Approval: Planning Approval has been granted.

Asking price £125,000

Viewing

Please contact our Homepage Estate Agents Office on 028 7187 6261

if you wish to arrange a viewing appointment for this property or require further information.

Energy Efficiency Rating		
	Current	Potential
Very energy efficient - lower running costs		
(92 plus) A		
(81-91) B		
(69-80) C		
(55-68) D		
(39-54) E		
(21-38) F		
(1-20) G		
Not energy efficient - higher running costs		
England & Wales		EU Directive 2002/91/EC 
Environmental Impact (CO ₂) Rating		
	Current	Potential
Very environmentally friendly - lower CO ₂ emissions		
(92 plus) A		
(81-91) B		
(69-80) C		
(55-68) D		
(39-54) E		
(21-38) F		
(1-20) G		
Not environmentally friendly - higher CO ₂ emissions		
England & Wales		EU Directive 2002/91/EC 

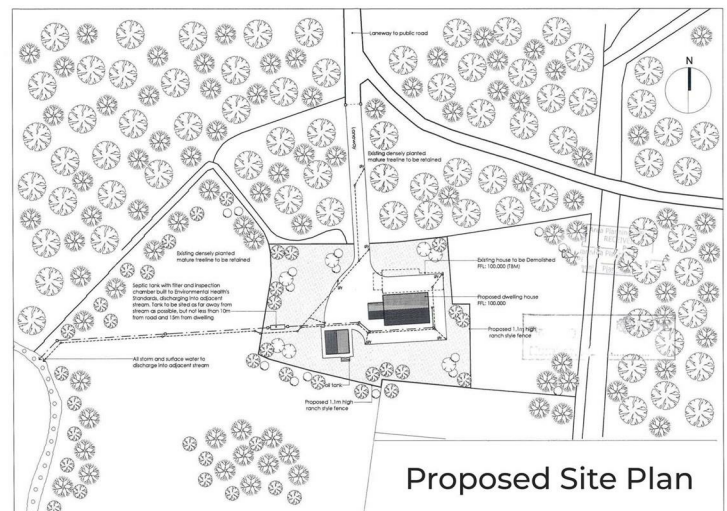
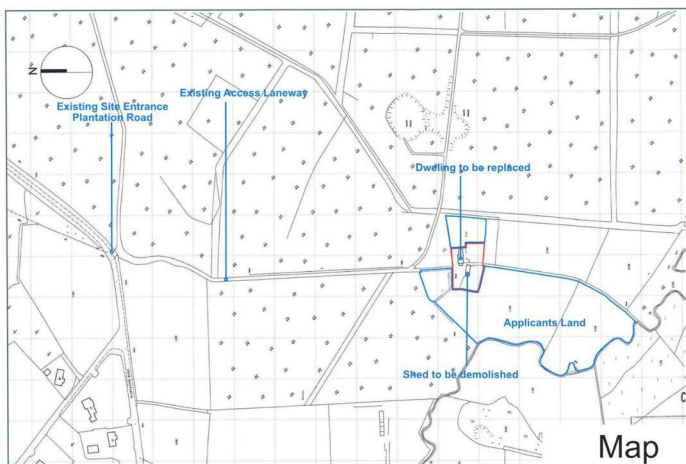

These particulars, whilst believed to be accurate are set out as a general outline only for guidance and do not constitute any part of an offer or contract. Intending purchasers should not rely on them as statements of representation of fact, but must satisfy themselves by inspection or otherwise as to their accuracy. No person in this firm's employment has the authority to make or give any representation or warranty in respect of the property.

Homepage Estate Agents

Tel: 028 7187 6261 | Email: info@homepageonline.co.uk

www.clickhomepage.online

