

# Dougan

RESIDENTIAL

Telephone 028 9030 8855  
[douganproperty.com](http://douganproperty.com)



**28 The Hill**

Belfast, BT10 0FY

**Asking Price £159,950**

## KEY FEATURES

- Very Well Presented Mid Terrace
- Excellent Location Close To Many Local Amenities
- Belfast City Centre Easily Accessible
- Bright And Spacious Living Room
- Modern Kitchen Open To Dining Area
- Three Generous Bedrooms
- Well Appointed First Floor Bathroom
- Private And Enclosed Rear Garden
- Driveway Parking
- Gas Fired Central Heating
- Double Glazing
- No Onward Chain



## SUMMARY

Well presented mid terrace located in a quiet cul-de-sac in Erinvale off Finaghy Road South. Many local amenities are close at hand and Belfast city centre is easily accessible by bus, car or rail.

The accommodation briefly comprises of a bright and spacious living room and a modern kitchen with dining area on the ground floor. Three bedrooms and a well appointed family bathroom are to the first floor.

The property further benefits from a private, enclosed rear garden, front garden and driveway parking.

Early viewing is advised.



## ACCOMMODATION:

Ground Floor

**ENTRANCE HALL:** Laminate wooden floor

**LIVING ROOM:** 13' 2" x 12' 2" (4.01m x 3.71m)

Laminate wooden floor

**KITCHEN WITH DINING AREA :** 16' 2" x 11' 0" (4.93m x 3.35m)

Range of high and low level units, formica work surfaces, chrome handles, stainless steel sink unit, space for oven and hob, chrome extractor fan, under counter integrated fridge and freezer, partly tiled walls, tiled floor, sliding doors to rear garden

## First Floor

**LANDING:** Linen closet with gas boiler, access to partially floored roofspace

**BEDROOM (1):** 11' 7" x 11' 3" (3.53m x 3.43m)

Laminate wooden floor

**BEDROOM (2):** 12' 9" x 10' 6" (3.89m x 3.2m)

**BEDROOM (3):** 9' 5" x 7' 3" (2.87m x 2.21m) Built in storage, laminate wooden floor

**BATHROOM:** Panel bath with chrome taps, pedestal wash hand basin with chrome taps, low flush w.c, heated chrome towel radiator, tongue and groove ceiling, tiled floor, fully tiled walls, spot lighting

## Outside

Private and enclosed paved rear garden with decking, mature shrubs, timber fence and excellent storage. Front garden laid in lawn and driveway parking.









## LOCATION MAP

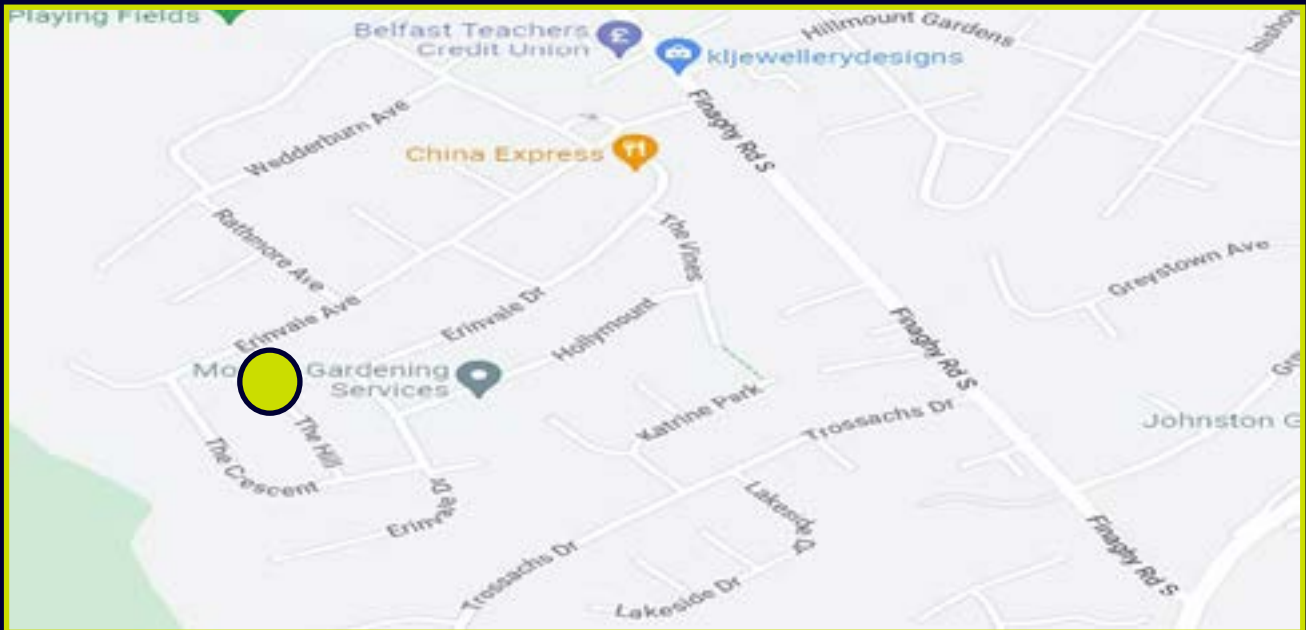

## FLOOR PLANS (NOT TO SCALE)

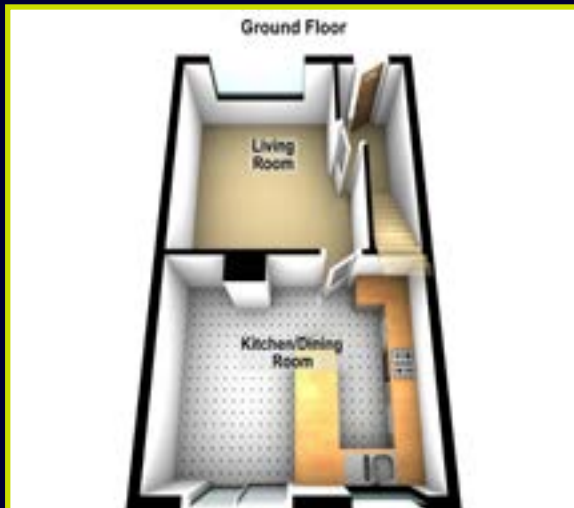

## EPC



**Dougan**  
RESIDENTIAL

6 Orpen Shopping Centre Upper Lisburn Road  
Belfast BT10 0BG  
Telephone 028 9030 8855  
Email [info@douganproperty.com](mailto:info@douganproperty.com)  
Web [www.douganproperty.com](http://www.douganproperty.com)



Dougan Residential for themselves and for the Vendors or Lessors of the property whose agents they are give notice that; i) these particulars are given without responsibility of Dougan Residential or the Vendors or Lessors as a general outline only, for the guidance of prospective purchasers or tenants, and do not constitute the whole or any part of an offer or contract; ii) Dougan Residential cannot guarantee the accuracy of any description, dimensions, references to condition, necessary permissions for use and occupation and other details contained herein and any prospective purchasers or tenants should not rely on them as statements or representations of fact but must satisfy themselves by inspection or otherwise as to the accuracy of each of them; iii) no employee of Dougan Residential has any authority to make or give any representation or warranty or enter into any contract whatsoever in relation to the property; iv) VAT may be payable on the purchase price and/or rent, all figures are quoted exclusive of VAT, intending purchasers or lessees must satisfy themselves as to the applicable VAT position, if necessary by taking appropriate professional advice; v) Dougan Residential will not be liable, in negligence or otherwise, for any loss arising from the use of these particulars.