



FOR SALE

12a Bow Street, Lisburn Co. Antrim BT28 1BN
028 9266 9030
info@taylorpattersonestateagents.com
www.taylorpattersonestateagents.com

56 Milebush Manor, Dromore BT25 1FT

Offers in the Region of £155,000

PROPERTY DESCRIPTION

An attractive three storey semi-detached home occupying a cul de sac setting within this residential development off Milebush Road.

Conveniently placed, Dromore town centre is nearby, whilst for commuting the A1 dual carriageway provides easy access to the motorway network at Sprucefield.

The property itself is well presented and boasts a log-burning stove in the Lounge, a modern fitted Kitchen and a spacious Master Bedroom on the second floor with Ensuite Shower Room.



Accommodation comprises in brief:- Entrance Hall; Lounge; Kitchen/Dining Area; Cloakroom with w.c.

First floor: Bedrooms 2 & 3; Bathroom with white suite including bath and separate shower cubicle.

Second floor: Master Bedroom with Ensuite Shower Room.

Specification includes: Gas fired central heating; uPVC double glazed windows.

Outside: Long cobble paved driveway.

Enclosed rear garden comprising cobble paved patio and artificial lawn. Raised railway sleeper-built flower/shrub bed. Timber fence surround. Timber Shed. Tap. Light.

LOCATION: Travelling on the A1 dual carriageway from Sprucefield direction, take second turn-off for Dromore into Milebush Road. Milebush Manor is on the left hand side.



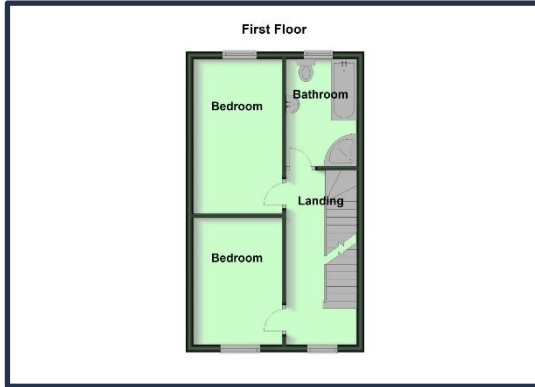
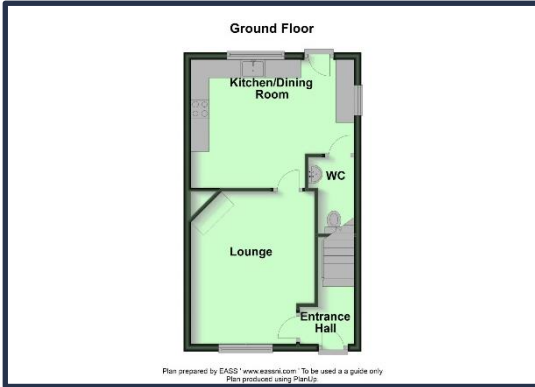

GROUND FLOOR

ENTRANCE HALL

Entrance door with glazed fan light over.

LOUNGE

4.33m (14'2") x 3.38m (11'1")

Log burning stove on slate hearth.

KITCHEN/DINING AREA

4.47m (14'8") x 3.5m (11'6")

Range of `Shaker` style cupboards. Built-in oven, 4 ring ceramic hob and extractor fan in stainless steel. Integrated dishwasher. Single drainer stainless steel sink unit with mixer tap. Part tiled walls. Plumbed for washing machine. Downlighters in chrome. Tiled floor. uPVC double glazed rear door.

CLOAKROOM

Tiled floor. Low flush w.c. and pedestal wash hand basin.

FIRST FLOOR

BEDROOM 2

4.23m (13'11") x 2.38m (7'10")

BEDROOM 3

3.49m (11'5") x 2.38m (7'10")

BATHROOM

2.92m (9'7") x 1.95m (6'5")

White suite comprising bath with mixer tap and shower attachment; fully tiled corner shower cubicle; pedestal wash hand basin with mixer tap; and low flush w.c. Tiled floor and half tiled walls. Downlighters in chrome.

SECOND FLOOR

MASTER BEDROOM

5.68m (18'8") x 3.38m (11'1") max. measurements

Built-in storage cupboard. Access to eaves storage.

ENSUITE SHOWER ROOM

Fully tiled corner shower cubicle; pedestal wash hand basin with mixer tap; and low flush w.c. Tiled floor. Downlighters in chrome.

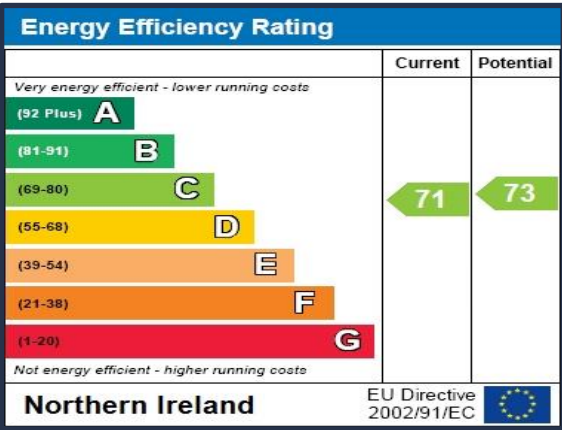

12a Bow Street, Lisburn Co. Antrim BT28 1BN
 028 9266 9030
info@taylorpattersonestateagents.com
www.taylorpattersonestateagents.com



FOR SALE