

## Agricultural Lands At Millbank Road East, Templepatrick



**Offers In The Region Of  
£150,000**

*8.77 acres of excellent agriculture land in one field with direct frontage onto Millbank Road East, Templepatrick. As illustrated in Lot 4 on map. (Lot's 1,2 and 3 are available in individual or collective lots).*

**VIEWING By Appointment Through  
Country Estates, Glengormley Tel: 02890 830803**

**>Sales >New Homes >Commercial >Rentals >Mortgages**

**Antrim**  
12 Church Street  
BT41 4BA  
Tel: (028) 9446 6777

**Ballyclare**  
51 Main Street  
BT39 9AA  
Tel: (028) 9334 0726

**Ballymena**  
3 Fenaghy Road  
BT42 1HW  
Tel: (028) 2565 5733

**Glengormley**  
18 Carmoney Road  
BT36 6HN  
Tel: (028) 9083 0803

# ACEmap® Single

Printed: 09/02/2021 Customer Ref:

Centre Point (Easting, Northing): 326648, 384688

MILLBANK ROAD, CARNANEE, TEMPLEPATRICK, BT39 0AS, 185397212

Scale: 1:2,500

Order no. ORD96258

Plan No. 11306NE

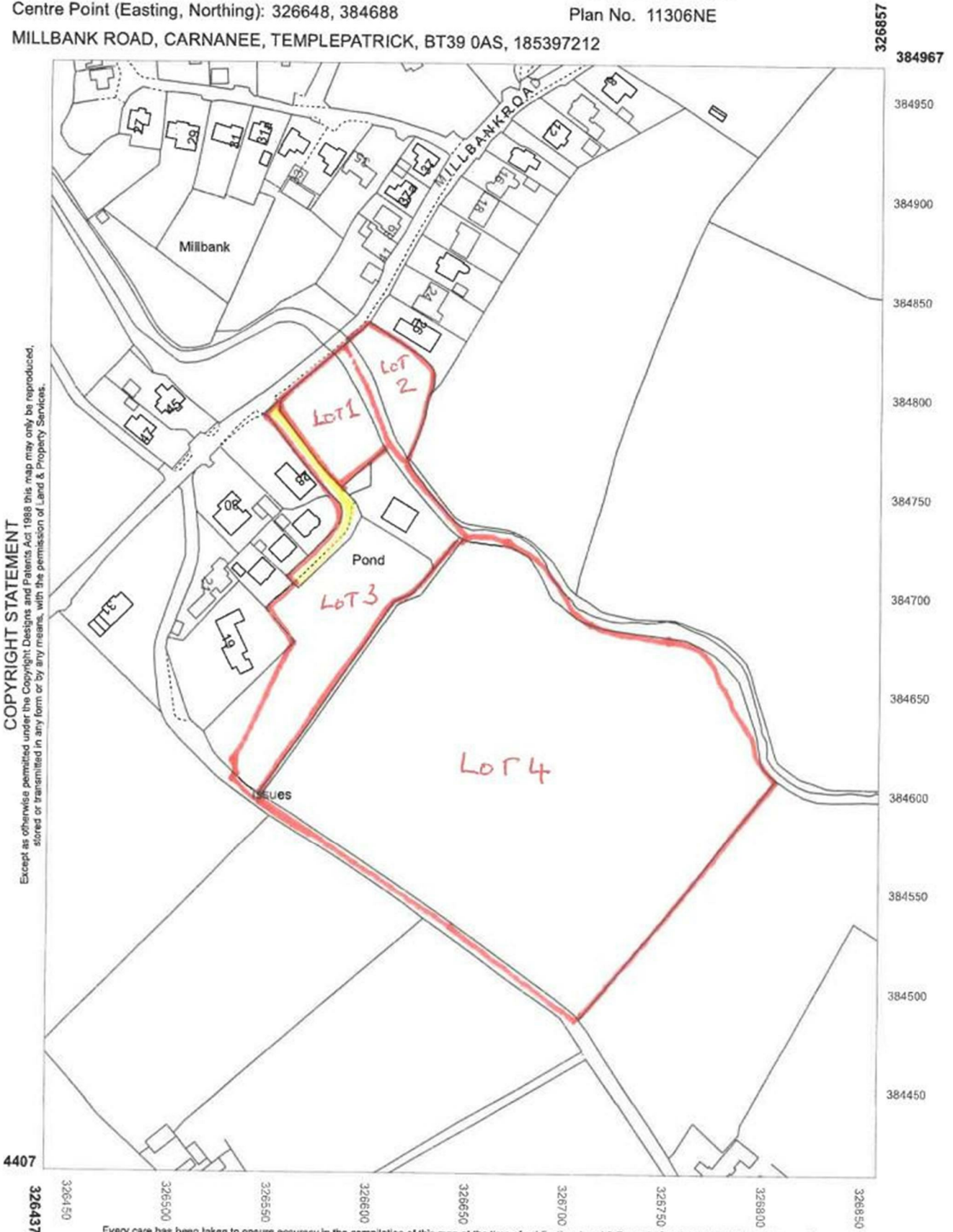

**COPYRIGHT STATEMENT**  
Except as otherwise permitted under the Copyright Designs and Patents Act 1988 this map may only be reproduced, stored or transmitted in any form or by any means, with the permission of Land & Property Services.

4407  
326437  
326450  
326500  
326550  
326600  
326650  
326700  
326750  
326800  
326850

326850  
384967  
384950  
384900  
384850  
384800  
384750  
384700  
384650  
384600  
384550  
384500  
384450

Every care has been taken to ensure accuracy in the compilation of this map at the time of publication. Land & Property Services cannot, however, accept responsibility for errors or omissions and when such are brought to our attention, the amendment of any future publication as appropriate shall be entirely at our discretion. Ordnance Survey of Northern Ireland and ACEmap® are registered Trademarks of Department of Finance and Personnel.

Licence / Permit No.

© Crown Copyright 2021

Country Estates (N.I) Ltd. for themselves and the Vendors of this property whose agents are, give notice that:  
These particulars do not constitute any part of an offer or contract  
All statements contained in these particulars as to this property are made without responsibility on the part of Country Estates (N.I) Ltd. or the vendor  
None of the statements contained in these particulars as to this property are to be relied on as statements or representations of fact  
Any intending purchaser must satisfy himself or otherwise as to the correctness of the statement contained in these particulars  
The vendor does not make or give, and neither Country Estates (N.I) Ltd. nor any person in their employment, has any authority to make or give representation or warranty whatever in relation to this property.