

Agricultural Land And Farm Building Adjacent 28 Millbank Road, Templepatrick



**Offers In The Region Of
£75,000**

A modern farmbuilding measuring 45 ft X 40 ft with 1.65 acres of land as illustrated in Lot 3 on ace map. Perfectly positioned adjacent to the current development limit with excellent potential for possible future development. Benefitting from privately owned access road off the Millbank Road, as illustrated in yellow on ace map attached. (Lots's 1,2 and 4 are also available in individual or collective lots).

For further information on these lots contact our Glengormley office.

**VIEWING By Appointment Through
Country Estates, Glengormley Tel: 02890 830830**

>Sales >New Homes >Commercial >Rentals >Mortgages

Antrim
12 Church Street
BT41 4BA
Tel: (028) 9446 6777

Ballyclare
51 Main Street
BT39 9AA
Tel: (028) 9334 0726

Ballymena
3 Fenaghy Road
BT42 1HW
Tel: (028) 2565 5733

Glengormley
18 Carmoney Road
BT36 6HN
Tel: (028) 9083 0803



ACEmap® Single

Printed: 09/02/2021 Customer Ref:

Centre Point (Easting, Northing): 326648, 384688

MILLBANK ROAD, CARNANEE, TEMPLEPATRICK, BT39 0AS, 185397212

Scale: 1:2,500

Order no. ORD96258

Plan No. 11306NE

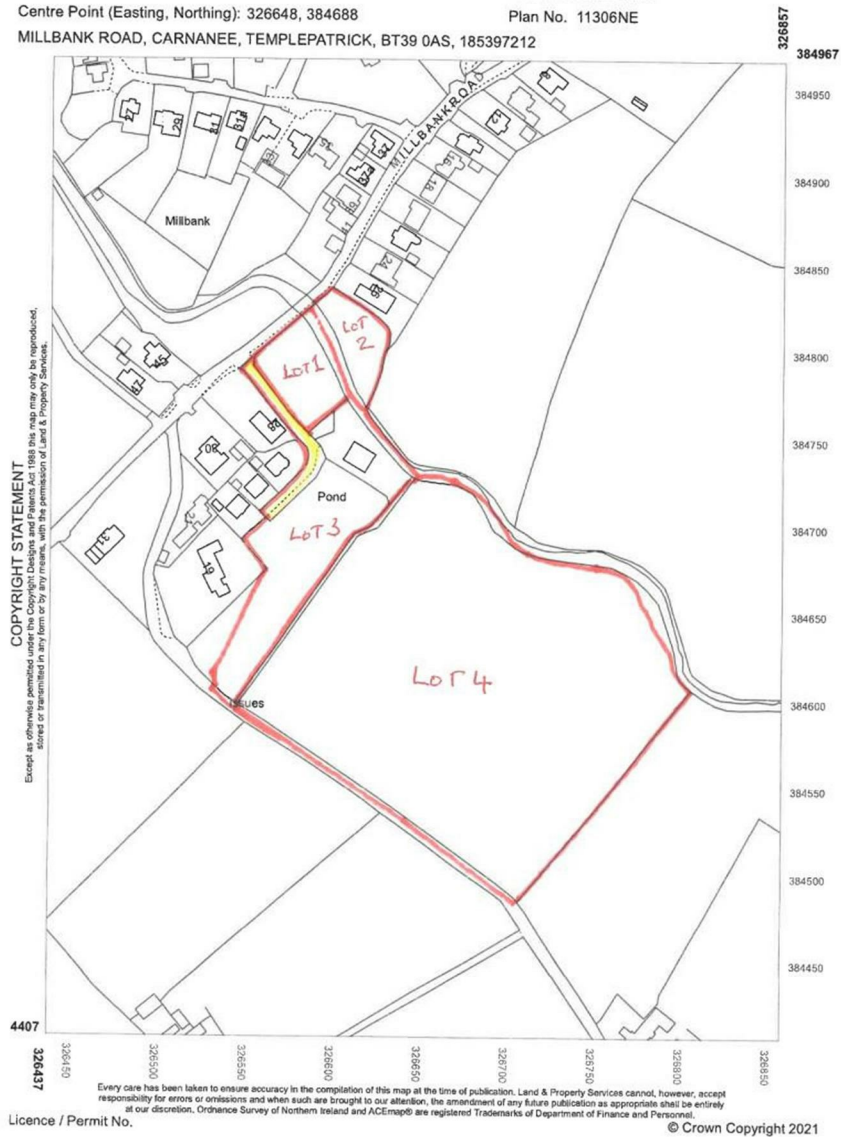

Licence / Permit No.

Country Estates (N.I.) Ltd. for themselves and the Vendors of this property whose agents are, give notice that:

These particulars do not constitute any part of an offer or contract

All statements contained in these particulars as to this property are made without responsibility on the part of Country Estates (N.I.) Ltd. or the vendor

None of the statements contained in these particulars as to this property are to be relied on as statements or representations of fact

Any intending purchaser must satisfy himself or otherwise as to the correctness of the statement contained in these particulars

The vendor does not make or give, and neither Country Estates (N.I.) Ltd. nor any person in their employment, has any authority to make or give representation or warranty whatever in relation to this property.