

FIRST FLOOR PLAN

BOILERS
 Blue Bird - 50. 70.
 Warmflow. Low level
 Fias kit - 50.
 Night vents to patio doors to provide 10,000mmsq additional ventilation

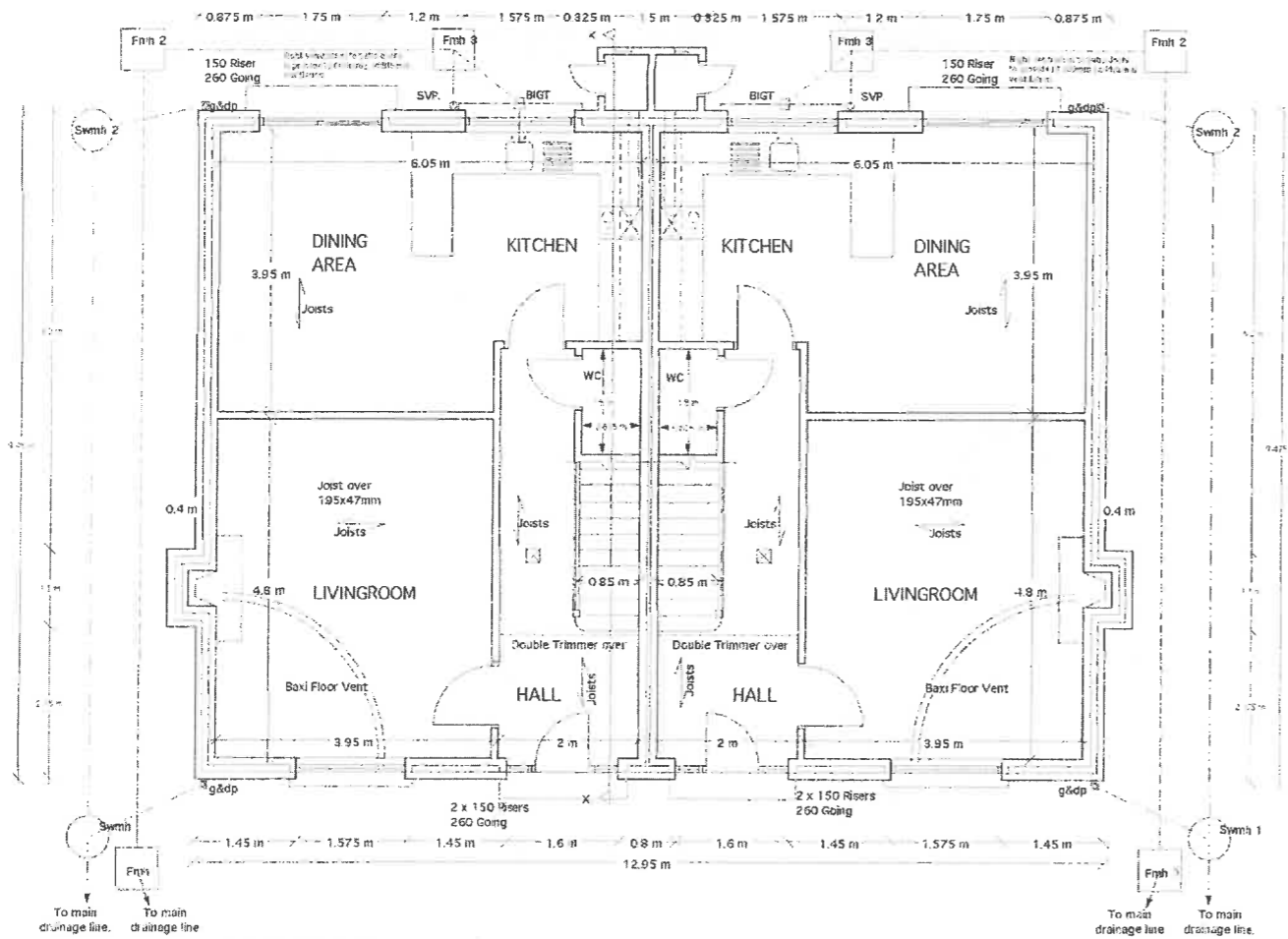

GROUND FLOOR PLAN

Glazing
 All Glass in doors & windows to be as BS 6206 Class B

ROOFS (Trussed)
 Trusses to be manufactured and fixed in accordance with BS 5268. All details of bracing, bridging, bracing etc. in accordance with sketches on pages 1-5 detail drawings.

100x50 Longitudinal bracing members to be tightly about every gable and party wall.

150mm min glass fibre insulation.

19mm T&G boarding.

195x47 @400 o/c floor joists.

STAIRS:
 Gauges - 0.23m
 Risers - 0.1857m(14)
 Pitch - 38.5 degrees

D.P.C. 150mm above G.L.

Refer to Engineers drawings for foundation details.

SECTION X-X.

VAPOUR BARRIERS
 Where ceiling finish is fixed direct to underside of rafters or ceilings over kitchens and bathrooms, a vapour barrier of 250g polythene to be fixed before the Gyplath

Glazing
 All Glass in doors & windows to be as BS 6206 Class B

CEILING
 Unless otherwise shown to be 10mm Gyplath, boarding and skim.
 Where steel beams are contained in or supporting floors an additional layer of Gyplath to be provided around steel (or over the full area of the ceiling) to give 1.2 hour fire resistance.
 All ceilings under roof voids to be insulated with min. 150 glass fibre. Roof voids thus insulated to be ventilated in accordance with standard detail drawing.

STEEL LINTOLS
 To be insulated type as IG as appropriate for span and loading

All support beams to be fixed to reinforced concrete padstones (min 2 No Y12 bars in bottom) - min 600 x 225 deep by width of wall - with 2 No M12 bolts. Padstones to be strapped down wall with min 2 No 30 x 6 x 1200 mm long 'catnic' type wall straps

All structure masonry to be carried out in accordance with BS 5628.

All concrete blockwork, where specified, to be 7 N mm2 characteristic strength concrete blocks to BS 5628 with class () mortar designation (ie 1:5 cement/sand with plasticizer). The contractor shall supply current test certificates for verification of the above (when requested)

All timber connections on 'cut' sections of roofs to be formed with M12 bolts with proprietary double edged toe/heel plate connectors

Blockwork construction joints (where indicated) should comprise a 12mm compressible joint filler (as 'Flexcell' or similar) fixed to one end of wall with exposed face filled with a 20mm x 12mm plug of water-tight joint sealant (as 'Sika-flex 15LM' or similar) increase density of wall-tie spacing either side of construction joint to 225mm in-line vertical spacings each side of joint. External plaster coating to be discontinuous across construction joint.

KEY :

	Foul Water Manhole		Safety glazing to BS 6206 class B
	Storm Water Manhole		Smoke alarm
	Extractor fan & ducts		Foul drainage line
	Direction of floor joists		Storm drainage line
	Rooding eye		
	Soil vent pipe		

drawn J.P.O.R	dig no 01C	title Amended WC, ground & first floor plans and section
scale 1:50	job no 016D	contract Housing development at Castle Balfour, Lisnaska for [redacted]
check [redacted]	date [redacted]	

55 TEMPO RD ENNIS/KILLEN CO. FERMANAGH BT74 6HR TEL (01865) 323500 FAX 323752 **allan associates** A.R.C.H.I.T.E.C.T.S

ARDELAN ROSSNOWLAGH CO. DUNEGAL TEL (00353)2152522 FAX (00353)2 5822

DATE FOR ISSUE 2.0 NOV. 1991

L/99/0198!