

# Dougan

RESIDENTIAL

Telephone 028 9030 8855  
douganproperty.com



15 Parkview, 145-152 Kingsway  
Dunmurry, BT17 9RY

Asking Price £115,000

## KEY FEATURES

- Extensively Refurbished, Stunning & Spacious First Floor Apartment
- Located Within The Heart Of Dunmurry Village
- Located In Close Proximity to Motorway Networks, Dunmurry Train Station & Belfast City Centre
- Generous Open Plan Living Room/Kitchen with Wood Effect Tiled Flooring
- Contemporary Luxury Monochrome Style Bathroom
- Two Double Bedrooms (Master With Luxury Ensuite Shower Room)
- Utility and Store Cupboard off main entrance hallway
- Gas Fired Central Heating
- Double Glazed Windows
- Secure Gated Car Parking
- Viewing Highly Recommended to Fully Appreciate This Fine Apartment





## SUMMARY

Stunning first floor apartment ideally located in the heart of Dunmurry Village offering a wide range of local amenities and services. This development offers superb modern living in a highly sought-after residential location. Superb transport links on your doorstep with regular bus services and Dunmurry Train Station within walking distance.

Internally this stylish property comprises of a bright and spacious open plan living/kitchen/dining area... well appointed contemporary bathroom with white suite and black tapware. The property further benefits from gas fired central heating, double glazed windows, and secure gated car parking.

Viewing Highly Recommended to Fully Appreciate This Fine Apartment. To book a viewing please contact our office on 02890 308855.

## ACCOMMODATION:

### First Floor

#### ENTRANCE HALL:

Wooden door, Italian luxury wood effect floor tiles by Blustyle Ceramics.

#### UTILITY STORE:

Plumbed for washing machine and electric point for tumble dryer.

#### LIVING ROOM/KITCHEN 23' 7" x 18' 2" (7.19m x 5.54m)

Excellent range of high level and low-level units, sink unit with mixer tap. Integrated electric oven with 4 ring gas hob and chrome extractor over. Integrated Fridge-freezer. Plumbed for dishwasher. Partly tiled walls, formica work surfaces. Chrome sockets. Gas boiler. Intercom system. Italian luxury wood effect floor tiles by Blustyle Ceramics. Double doors to communal outside area.

#### BEDROOM (1): 16' 9" x 13' 0" (5.11m x 3.96m) At widest points.

Kronotex Highland black oak effect flooring

#### ENSUITE SHOWER ROOM:

Fully tiled shower cubicle with Aquado Cool Touch Rain Shower, Merlyn Black Bi-fold Shower Door with a slip resistant shower tray and 600mm LED illuminated sphere mirror. Low flush WC. Pedestal wash hand basin with storage. Ceramic tiled floor. Extractor fan.

#### BEDROOM (2): 13' 2" x 10' 6" (4.01m x 3.2m)

Kronotex Highland black oak effect flooring.

#### BATHROOM:

Luxury monochrome style bathroom with white suite, black high end accessories including Aquado Rain shower, Aqualla anthracite towel radiator and tapware. White wide fit bath, low flush WC, wash hand basin and vanity shelf and 600mm LED illuminated sphere mirror. Ceramic tiled floor, partly tiled walls and extractor fan.

#### Outside

Secure gated car parking.







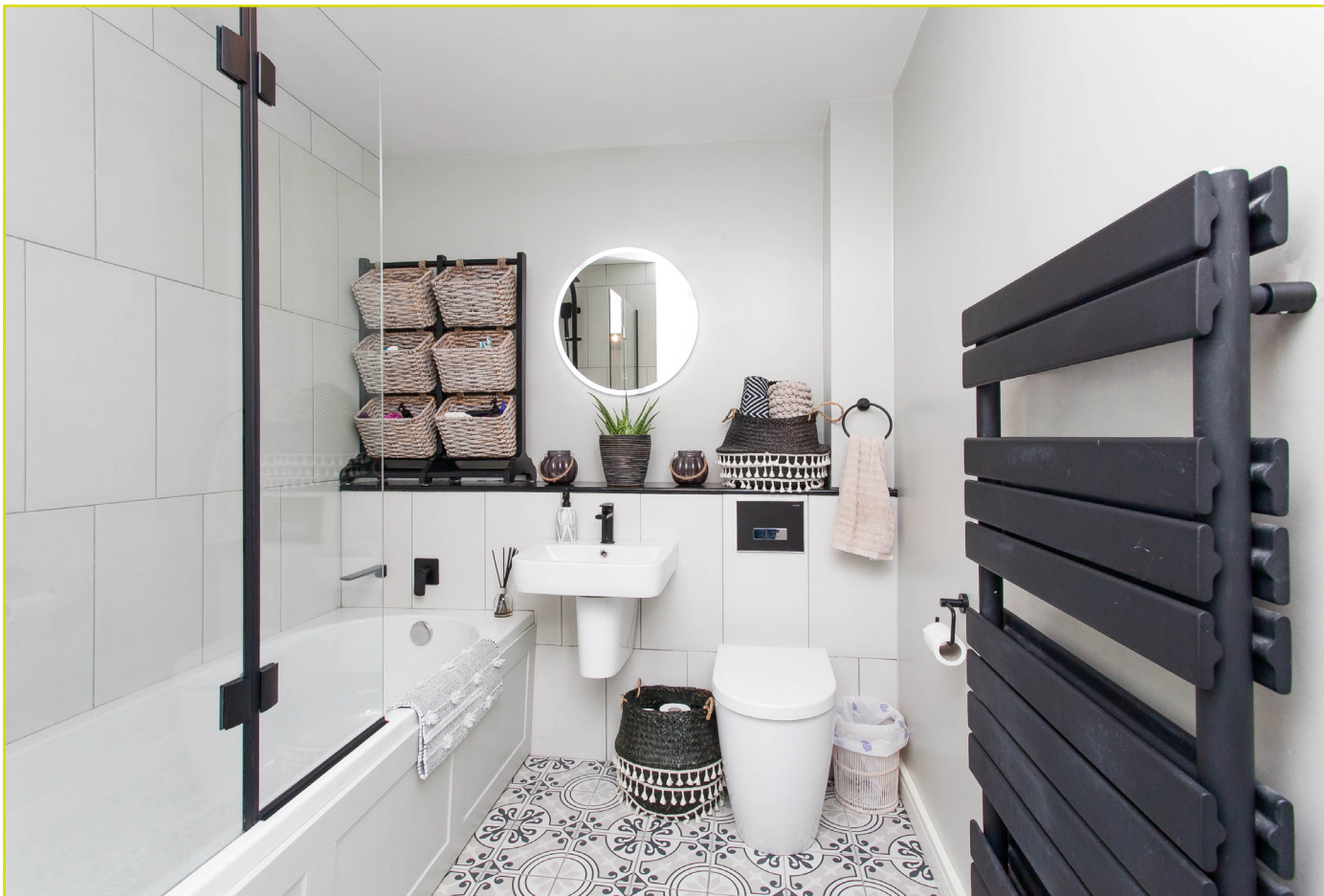

## FLOOR PLAN (NOT TO SCALE)

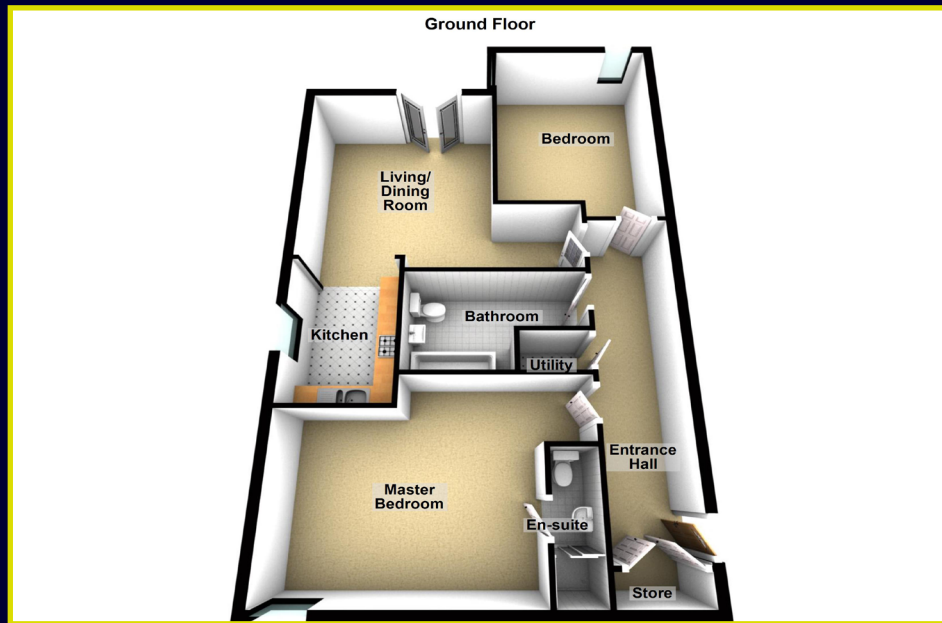

## LOCATION MAP

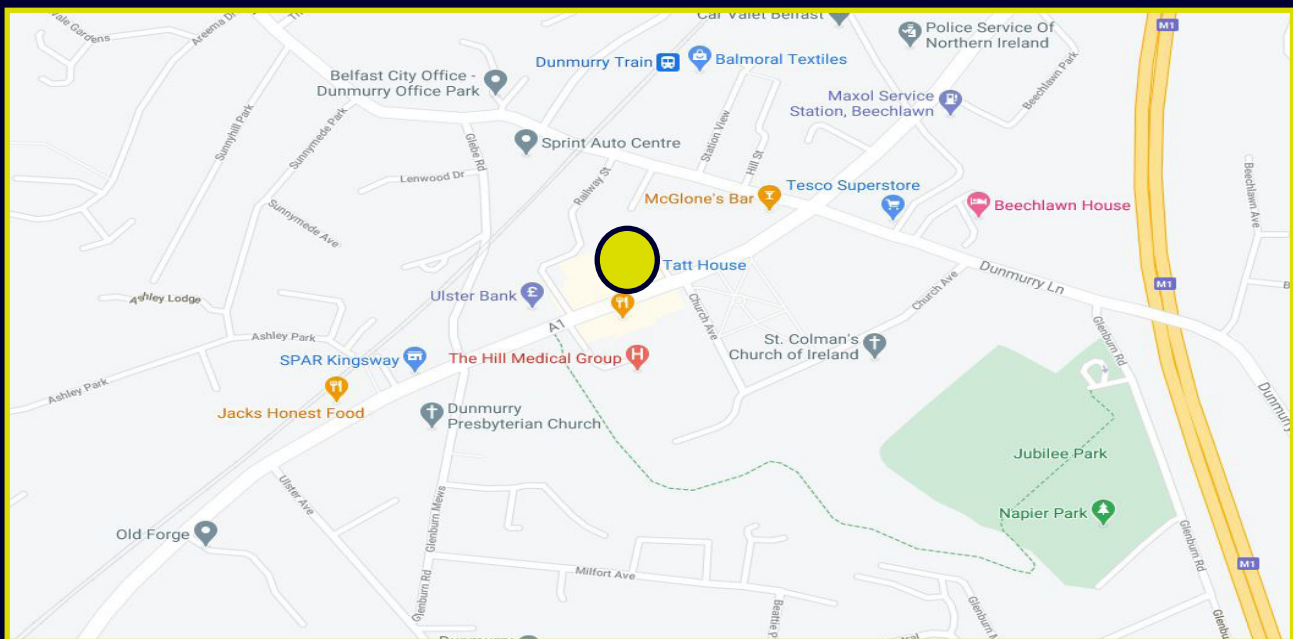

## EPC

Energy Efficiency Rating		Current	Potential
Very energy efficient - lower running costs			
A	92 plus		
B	81-91		
C	69-80	75	77
D	55-68		
E	39-54		
F	21-38		
G	1-20		
Not energy efficient - higher running costs			

**Dougan**  
RESIDENTIAL

6 Orpen Shopping Centre Upper Lisburn Road  
Belfast BT10 0BG  
Telephone 028 9030 8855  
Email [info@douganproperty.com](mailto:info@douganproperty.com)  
Web [www.douganproperty.com](http://www.douganproperty.com)



Dougan Residential for themselves and for the Vendors or Lessors of the property whose agents they are give notice that; i) these particulars are given without responsibility of Dougan Residential or the Vendors or Lessors as a general outline only, for the guidance of prospective purchasers or tenants, and do not constitute the whole or any part of an offer or contract; ii) Dougan Residential cannot guarantee the accuracy of any description, dimensions, references to condition, necessary permissions for use and occupation and other details contained herein and any prospective purchasers or tenants should not rely on them as statements or representations of fact but must satisfy themselves by inspection or otherwise as to the accuracy of each of them; iii) no employee of Dougan Residential has any authority to make or give any representation or warranty or enter into any contract whatsoever in relation to the property; iv) VAT may be payable on the purchase price and/or rent, all figures are quoted exclusive of VAT, intending purchasers or lessees must satisfy themselves as to the applicable VAT position, if necessary by taking appropriate professional advice; v) Dougan Residential will not be liable, in negligence or otherwise, for any loss arising from the use of these particulars.