



TWO BUILDING SITES CROFT ROAD, DROMARA, BT25 2NH

- Two Building Sites With Planning Permission Occupying Prominent Settings Within This Delightful Rural Area
- Each Site Extends To Approximately One Acre And Access Is Via A Shared Private Lane Exclusive To Both Sites
- Planning Permission Has Been Granted For Two Dwellings (Planning Details Available From Agents Or NI Planning Portal) / Please note, it is the owners preference to sell both sites as one lot
- Planning References S/2003/1845/O And S/2010/0265/RM
- Uninterrupted Rural Aspects With Site Two Having Views To Dromara Hills And Slieve Croob
- This Picturesque Location Is Convenient To Hillsborough, Dromore And Less Than Ten Miles To Sprucefield

Location: From Sprucefield proceed along A1 Dual Carriageway, 3.5 miles turn left into Dromara Road, 4.2 miles proceed straight ahead at junction with Ballynahinch Road, 1.3 miles turn right into Croft Road, lane to sites is 0.4 mile on the left.

PRICE: OFFERS IN THE REGION OF £245,000

VIEWING: CALL AT SITE

GN280807HG

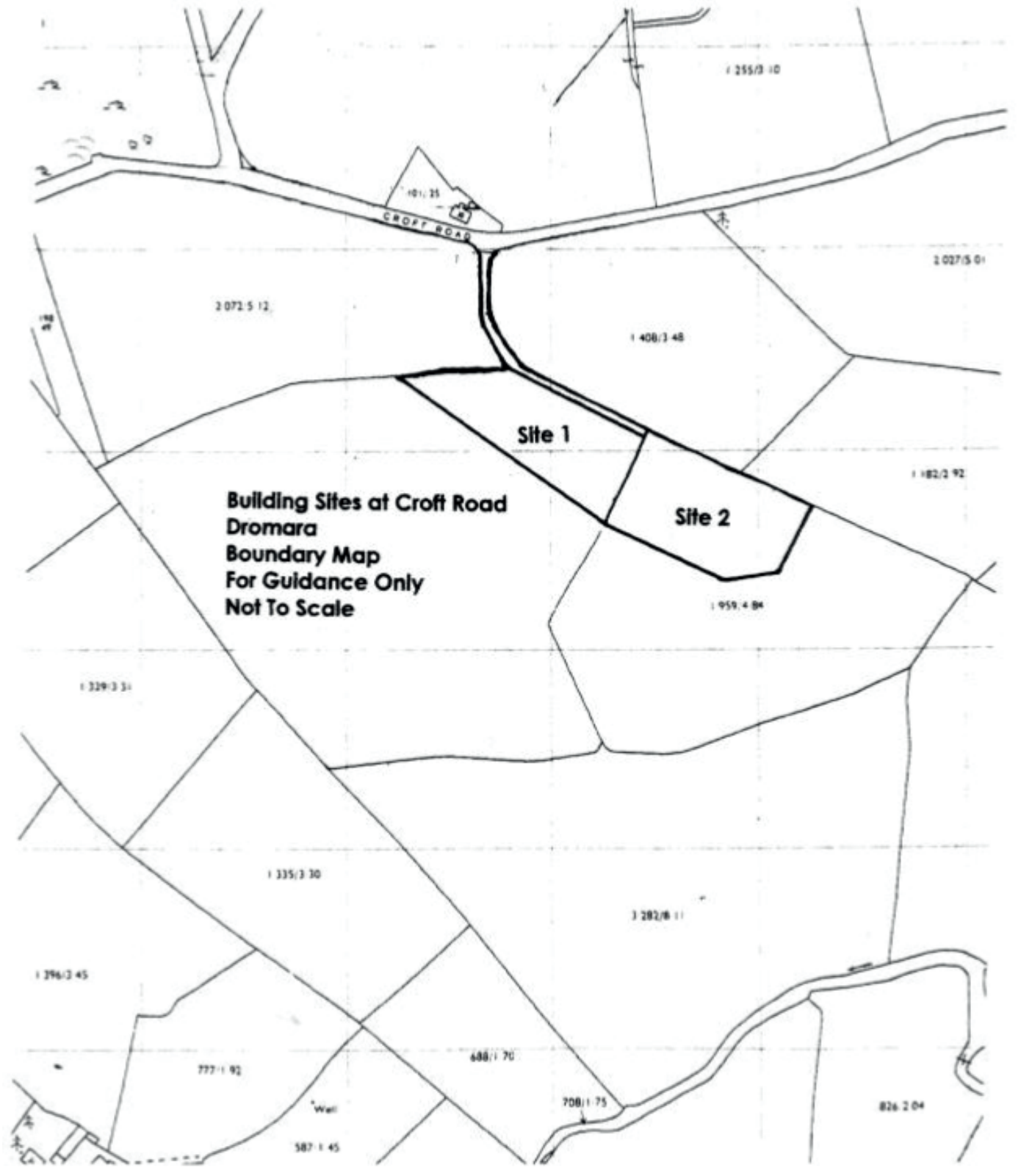

The above details do not constitute any part of an offer or contract. None of the statements contained in this sales brochure is to be relied on as statements or representations of fact and any intending purchaser must satisfy himself by inspection or otherwise as to their correctness. Neither the vendor, nor Henry Graham Estate Agents, nor any person employed in the company has any authority to make or give any representation or warranty whatsoever in relation to this property. All dimensions are approximate and are taken at widest points.